



Manual bevel gearbox

Manual torque up to 6 Nm

RAM35

- **Manually operated bevel gearbox**
- Ratios from 1:1 to 2:1
- Materials:
Housing: Glass fibre reinforced PA6
Bevel gears: Case hardened steel

Accessories

- MBEX handle
- AHEX hexagonal shaft

Info

- Not suitable for motorised applications

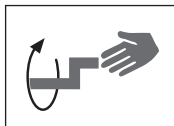
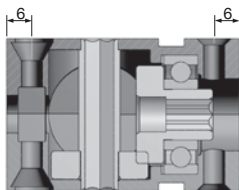
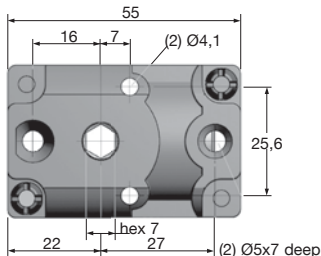
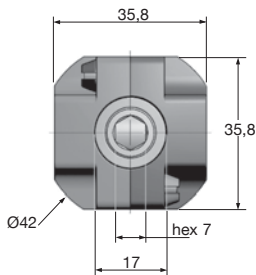

For manual applications

DISCOUNTS

Qty	1+	10+	25+	50+
Disc.	List	-5%	-15%	On request

Part number	Ratio	Input	Output	Max torque (Nm)	Price each 1 to 9
RAM35-1	1:1	hex 7mm	hex 7mm	6	50,60 €
RAM35-2	2:1	hex 7mm	hex 7mm	6	50,60 €

Dimensions in mm

Our other products



LVT

Miniature motorised actuator 1A, 1 ampere



GEC

Rubber latch clamp with strike plate, Lockable



DOG258

Motor-gearbox 12V and 24V DC, from 12 to 15 Nm



RDERSS

Stainless steel manual rigging screw, Stainless steel - manual



GLB

Small 6 lobe female handle, Technopolymer - Stainless steel



SHW

Plain washer, A2 Stainless steel



CHAR6035

Spring hinge, screwed/welded



RPCplss

Swivel castor with double brake, Stainless steel - Polyamide



RT61ss

Self-centering locking Assembly, Medium/low torque



PR65C

Half-articulated foot Ø 65, Ø 65



UCFL_SS

Stainless steel flanged bearing, Stainless steel

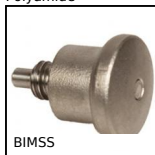

BIMSS

Indexing plunger mini, miniature - Stainless steel

Complementary products



AHEX

Hexagonal shaft, Hexagonal shaft



MBEX

Hexagonal ended handle, Hexagonal ended handle