

Roller guide accessory



RAG

Anchoring system

- An anchoring system comprises:

- 1 axle
- 1 nut
- 1 washer

- Material: stainless steel

Accessories

- Swivel heads **TOC** and **TOL**

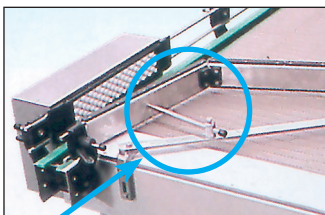
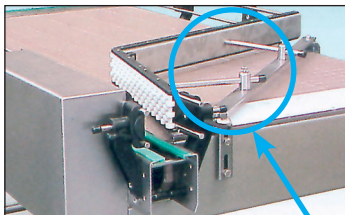
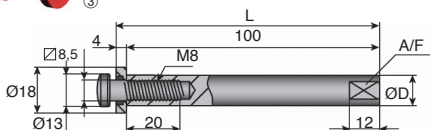
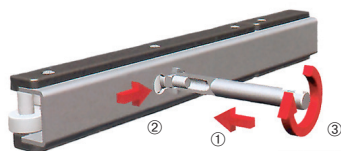

Typical applications

DISCOUNTS

Qty	1+	2+	6+
Disc.	List	-10%	On request

Part number	ØD	A/F	L	Weight (kg)	Stock*	Price each
RAG-12-M8	12	10	104	0,11	✓	6,88 €
RAG-14-M8	14	12	104	0,14	✓	7,77 €
RAG-15-M8	15	12	104	0,16	-	9,22 €
RAG-16-M8	16	14	104	0,16	-	9,22 €

*Depending on availability - Dimensions in mm

HPC

WEB
04/2020

www.hpceurope.com

Tél: 0 825 88 5000 Service 0,15 €/min + prix appel

Our other products



CHA135
Screwed hinge, 135 degrees



F7-P-AM
Multifunction display,
Magnetic band



G3
Steel spur gear, Steel
20NCD2



NTMbr
Set screw brass tip,
Brass-point



PVL
Small lobed handle,
Polyamide



UGH40
H Type Guide units,
For Ø40 actuators



PCS62SS
Chain sprocket -
Stainless steel,
15.875mm (DIN
08B-1)



RVM14
Manual worm and
wheel gearbox,
Worm/wheel



PR105
Articulated foot Ø103,
Ø 103

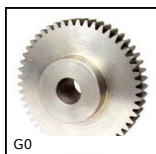

G0
Steel spur gear, Steel
20NCD2



GAL_25
Ø25 conveyor roller,
Without ball bearing



CDGamme
Compression spring
DIN2095, DIN 2095

Complementary products



RAG
Roller guide,



TOL
Swivel head, Long