

# Adjustable suction-cup support



## PV1R

## Standard grip

- Allows vacuum suction cups to be integrated into a handling system

- Materials :

Aluminium

Screws : steel

### Advantages

- Infinitely variable angle of adjustment

- Easy, flexible mounting

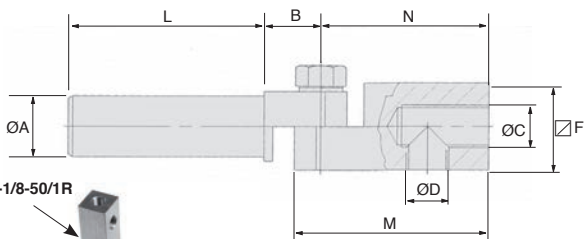
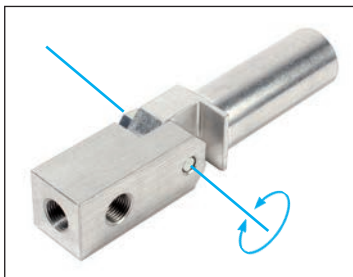

PV20-1/8-50/1R

BAN20/U

Typical application

### DISCOUNTS

|       |      |     |            |
|-------|------|-----|------------|
| Qty   | 1+   | 10+ | 30+        |
| Disc. | List | -5% | On request |

| Part number     | ØA | B  | ØC    | ØD    | L   | M  | ∇ F | N  | Weight (g) | Price each 1 to 9 |
|-----------------|----|----|-------|-------|-----|----|-----|----|------------|-------------------|
| PV20-1/8-50/1R  | 20 | 15 | G1/8" | G1/8" | 50  | 47 | 20  | 41 | 72         | 51,16 €           |
| PV20-1/8-100/1R | 20 | 15 | G1/8" | G1/8" | 100 | 47 | 20  | 41 | 87         | 53,36 €           |
| PV20-1/8-150/1R | 20 | 15 | G1/8" | G1/8" | 150 | 47 | 20  | 41 | 103        | 55,55 €           |
| PV20-1/4-50/1R  | 20 | 15 | G1/4" | G1/4" | 50  | 49 | 25  | 43 | 93         | 52,27 €           |
| PV20-1/4-100/1R | 20 | 15 | G1/4" | G1/4" | 100 | 49 | 25  | 43 | 106        | 54,46 €           |
| PV20-1/4-150/1R | 20 | 15 | G1/4" | G1/4" | 150 | 49 | 25  | 43 | 123        | 56,64 €           |

Dimensions in mm

## Our other products



T5\_11  
T type timing pulley,  
T5 aluminium



PGR  
Folding revolving  
handle for handwheel,  
Folding



RNAS  
Cam follower without  
axial guide, Without  
interior ring



AT5M AT10M  
AT type timing belt  
per metre, AT10 Steel  
cored polyurethane



SUPss  
Self-centering  
clamping hub  
stainless steel,  
Without locknut



PSPT  
Flexible tube handle,  
PVC



PRF\_GAL  
Roller for aluminium  
profile, Fixing kit for  
roller eccentric



SF\_ZZ  
Deep groove ball  
bearing, Stainless  
steel



PO  
Pull handle - Multi-  
sector, Smooth hole



BCAss  
Stainless steel splined  
bush, Inox



CHAEss  
Decorative hinge,  
Stainless steel



PW\_PWG3  
Worm - precision  
range, Stainless steel

## Complementary products



PV2R  
Adjustable suction-  
cup support,  
Increased grip