

Adjustable suction-cup support



PV1R

Standard grip

- Allows vacuum suction cups to be integrated into a handling system

- Materials :

Aluminium

Screws : steel

Advantages

- Infinitely variable angle of adjustment

- Easy, flexible mounting

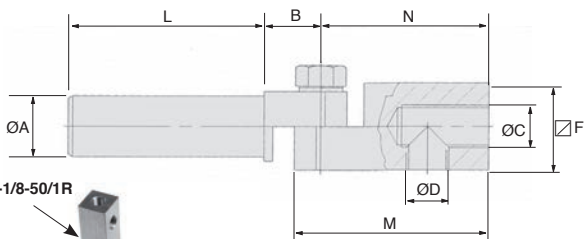
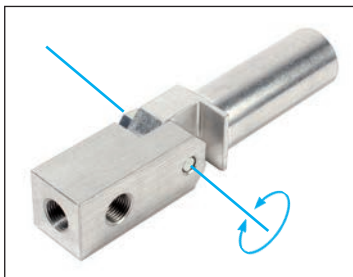

PV20-1/8-50/1R

BAN20/U

Typical application

DISCOUNTS

Qty	1+	10+	30+
Disc.	List	-5%	On request

Part number	ØA	B	ØC	ØD	L	M	∇ F	N	Weight (g)	Price each 1 to 9
PV20-1/8-50/1R	20	15	G1/8"	G1/8"	50	47	20	41	72	51,16 €
PV20-1/8-100/1R	20	15	G1/8"	G1/8"	100	47	20	41	87	53,36 €
PV20-1/8-150/1R	20	15	G1/8"	G1/8"	150	47	20	41	103	55,55 €
PV20-1/4-50/1R	20	15	G1/4"	G1/4"	50	49	25	43	93	52,27 €
PV20-1/4-100/1R	20	15	G1/4"	G1/4"	100	49	25	43	106	54,46 €
PV20-1/4-150/1R	20	15	G1/4"	G1/4"	150	49	25	43	123	56,64 €

Dimensions in mm

Our other products



SDC
Positioning sleeve for indexing pin, For pin Ø4 to Ø12



MRA_SS
Stainless steel Quick link, Stainless steel



PSG125S
Spur gear - precision range, Stainless steel 316



PR821
Idler sprocket for slat top chain, Ranges 821 and 805

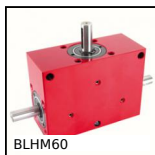

BLHM60
Right angled gearbox, double output shafts, up to 70 Nm



PRES7HR
Manual workbench press, Force up to 700kg



PT821
Drive sprocket for slat top chain, Ranges 821 and 805



UTKpwcr
Utilittrak® 3 wheels carriage, Polymer roller carriage



SLH-M
Nut for toggle clamp, Round ended nut for SLH/SLV clamp

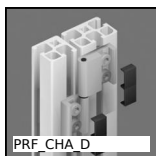

PRF_CHA D
Hinge and joint, Lift-off hinge

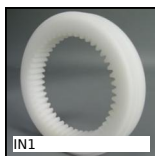

IN1
Internal gear, Machined plastic (delrin)



WJRM
Drylin® W hybrid bearing block, Hybrid bearings

Complementary products



PV2R
Adjustable suction-cup support, Increased grip