

Tensioner pulley



PTGP

For flat belts

- Idler pulley

- Material:

PA6 reinforced with 30% fibreglass

Steel bearing

- Max speed 5,000 RPM

(Except for PTGP30 + PTGP32 = 9,000 RPM)



INCREASED STOCK

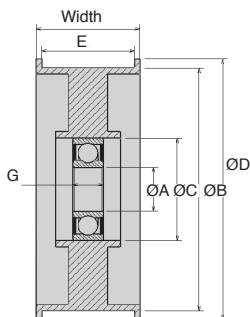

DISCOUNTS

Qty	1+	10+	25+	50+
Disc.	List	-5%	-10%	On request

Part number	ØD	Width		ØB	Bearing	ØC	ØA	E	G	For shaft	Stock*	Price each 1 to 9
		L	L									
PTGP30-9-8	40	13,2	30	608	2ZZ	20	8	9,2	7	AXTR-M8	✓	12,72 €
PTGP32-13-8	42	17,2	32	608	2ZZ	22	8	13,2	7	AXTR-M8	-	12,92 €
PTGP50-18-17	62	22,5	50	6203	2RS	38	17	18,3	12	AXTR-M12	✓	14,16 €
PTGP50-20-17	62	26	50	6203	2RS	38	17	20,3	12	AXTR-M12	✓	14,16 €
PTGP75-25-17	87	29,5	75	6203	2RS	38	17	25,3	12	AXTR-M12	✓	16,84 €
PTGP75-31-17	87	35,5	75	6203	2RS	38	17	31,3	12	AXTR-M12	-	19,77 €
PTGP75-31-17D	87	35,5	75	6203	2RS	38	17	31,3	24	AXTR-M12	-	25,57 €
PTGP90-18-17	102	22,5	90	6203	2RS	38	17	18,3	12	AXTR-M12	-	28,50 €
PTGP90-31-17	102	35,5	90	6203	2RS	38	17	31,3	12	AXTR-M12	-	28,75 €
PTGP90-31-17D	102	35,5	90	6203	2RS	38	17	31,3	24	AXTR-M12	-	29,25 €
PTGP90-36-17D	102	40,5	90	6203	2RS	38	17	36,3	24	AXTR-M12	-	29,52 €
PTGP115-36-17	127	30,5	115	6203	2RS	38	17	26,6	12	AXTR-M12	-	34,60 €

Dimensions in mm

Our other products



RHT

High Temperature wheel, up to 200kg



BPP

Pressed steel flanged bearing for light loads, Sheet steel



BTCW

Cap for square tube to be welded, To be welded



PTKss

Foot for the food industry, Stainless steel - 3-A standard



SH1

Parallel axis helical gear, Steel 20NCD2



DEP

Tools Hygienic Usit® and Hygienic Design®, Socket for mounting Hyg...



PCS6ECO

Chain sprocket - steel, 6mm (DIN 04-1)



LINK64

Synchronous AC Motor and-gearbox , from 1.3 to 6Nm



MFB_MHB

Moulded plastic bevel gear (nylon), 4:1



DOMI30

Domino 30 adjustable slide, Slide DOMILINE



GLT3E-58

Telescopic drawer,



LVT

Miniature motorised actuator 4A, 4 ampers

Complementary products



AXTR

Axle for tensioner pulley, Shaft



PTGR

Tensioner pulley, For round belts



PTGT

Tensioner pulley, For V belts