

Module 2.0



Spur gear

Pre-treated or case hardened steel



- **Quality grade 7e25 DIN 3961 (AGMA Q10)**

- **Material :**

Pre-treated steel 35NCD6, 28HRC

Case hardened steel 20NCD2 58HRC

- Teeth conform to DIN 867

- Tooth thickness conforms to DIN 3967

- Efficiency approx 98%

Options

- Alternative bores (H7)

- Keyway conforming to DIN6885 (JS9)

- Tapped hole

- Hole for dowel pin

Info.

- Torque figures are for 100 rpm and are given as a guide only

- Grade and tolerances measured before heat treatment.

Quality grade 7e25

DISCOUNTS

Qty	1+	6+	19+	50+
Disc.	List	-5%	-10%	On request

Part number		Z	ØP	ØD	ØA	ØM	Backlash	Torque (Nm)		Weight		Price each 1 to 5	
Standard	hardened	Teeth	Pitch	External	Bore	Boss	(mm)	Standard	hardened	Standard	hardened	Standard	hardened
PSG2.0-18	PSG2.0-18H	18	36	40	10	30	0,129 - 0,051	12,28	45,04	0,244	61,66	€	101,80
PSG2.0-19	PSG2.0-19H	19	38	42	10	30	0,129 - 0,051	12,97	47,54	0,262	63,07	€	104,11
PSG2.0-20	PSG2.0-20H	20	40	44	10	30	0,129 - 0,051	17,26	63,28	0,281	64,36	€	106,24
PSG2.0-21	PSG2.0-21H	21	42	46	12	35	0,129 - 0,051	18,12	66,44	0,330	66,07	€	109,06
PSG2.0-22	PSG2.0-22H	22	44	48	12	35	0,129 - 0,051	18,98	69,60	0,351	67,08	€	110,80
PSG2.0-23	PSG2.0-23H	23	46	50	12	35	0,129 - 0,051	19,85	72,77	0,373	68,53	€	113,10
PSG2.0-24	PSG2.0-24H	24	48	52	12	35	0,129 - 0,051	20,71	75,93	0,396	70,01	€	115,56
PSG2.0-25	PSG2.0-25H	25	50	54	12	35	0,129 - 0,051	21,57	79,09	0,420	73,96	€	122,02
PSG2.0-26	PSG2.0-26H	26	52	56	12	35	0,171 - 0,069	26,39	92,17	0,445	76,31	€	125,93
PSG2.0-27	PSG2.0-27H	27	54	58	12	35	0,171 - 0,069	27,41	95,71	0,471	79,01	€	130,44
PSG2.0-28	PSG2.0-28H	28	56	60	12	35	0,171 - 0,069	28,42	99,26	0,498	80,75	€	133,24

Dimensions in mm

Module 2.0

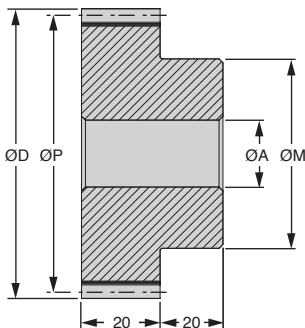

DISCOUNTS

Qty	1+	6+	19+	50+
Disc.	List	-5%	-10%	On request

Part number		Z	OP	OD	OA	OM	Backlash	Torque (Nm)	Weight	Price each	1 to 5	
Standard	hardened	Teeth	Pitch	External	Bore	Boss	(mm)	Standard	hardened	Standard	hardened	
PSG2.0-29	PSG2.0-29H	29	58	62	14	45	0,171 - 0,069	29,44	102,80	0,612	82,75 €	136,58 €
PSG2.0-30	PSG2.0-30H	30	60	64	14	45	0,171 - 0,069	33,50	105,67	0,640	84,60 €	139,56 €
PSG2.0-32	PSG2.0-32H	32	64	68	14	45	0,171 - 0,069	35,73	112,71	0,701	91,87 €	151,62 €
PSG2.0-35	PSG2.0-35H	35	70	74	14	45	0,171 - 0,069	39,08	123,28	0,799	101,39 €	167,35 €
PSG2.0-38	PSG2.0-38H	38	76	80	14	45	0,171 - 0,069	42,43	133,85	0,907	111,33 €	167,35 €
PSG2.0-40	PSG2.0-40H	40	80	84	16	55	0,171 - 0,069	57,07	156,72	1,092	116,00 €	183,70 €
PSG2.0-42	PSG2.0-42H	42	84	88	16	55	0,173 - 0,067	59,93	164,56	1,172	119,55 €	191,45 €
PSG2.0-45	PSG2.0-45H	45	90	94	16	55	0,173 - 0,067	64,21	176,31	1,300	124,80 €	197,33 €
PSG2.0-48	PSG2.0-48H	48	96	100	16	55	0,173 - 0,067	68,49	188,06	1,437	134,38 €	221,72 €
PSG2.0-50	PSG2.0-50H	50	100	104	20	65	0,173 - 0,067	84,59	212,58	1,646	143,86 €	237,39 €
PSG2.0-52	PSG2.0-52H	52	104	108	20	65	0,173 - 0,067	87,98	221,08	1,746	149,17 €	246,22 €
PSG2.0-55	PSG2.0-55H	55	110	114	20	65	0,173 - 0,067	93,05	233,84	1,903	168,48 €	278,01 €
PSG2.0-58	PSG2.0-58H	58	116	120	20	65	0,173 - 0,067	98,13	246,59	2,070	178,68 €	294,85 €
PSG2.0-60	PSG2.0-60H	60	120	124	20	65	0,173 - 0,067	120,80	265,61	2,186	183,19 €	302,35 €
PSG2.0-62	PSG2.0-62H	62	124	128	20	65	0,175 - 0,065	124,83	274,46	2,306	187,70 €	309,68 €

Dimensions in mm

Our other products



PVL

Small lobed handle,
Polyamide

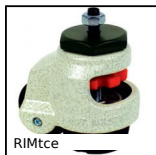

RIMtce

Locking castor, with
central hole



PW_PWG05

Worm - precision
range, Steel



IN2

Internal gear, Steel
20NCD2



CLR

Straight clevis,
Straight clevis for use
with a male clevis



QNUP

Single row cylindrical
roller bearing, 1 fixed
inner flange and 1 fr...



RJUM01

Closed polymer
Drylin® R bearing,
Drylin® R



ETGamme

Extension springs
DIN2097, DIN 2097



TBD

Manual leadscrew
table with opposing



BOX-CSss

Hose clamp, Box set
of stainless steel hose

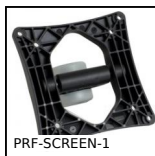

PRF-SCREEN-1

Screen support, Basic
support



PW_PWG15

Worm - precision
range, Steel

Complementary products



PSG2

Spur gear - precision
range, Pre-hardened
Steel 35NCD6



PSG2S

Spur gear - precision
range, Stainless steel
303