

Module 1.0 Spur gear

S/Steel 303
S/Steel 316



- **Quality grade 7e25 DIN 3961 (AGMA Q10)**
- **Material :**
 - Stainless steel 303
 - Stainless steel 316
- Teeth profile conform to DIN 867
- Tooth thickness conforms to DIN 3967
- Efficiency approx 98%

Options

- Alternative bores (H7)
- Keyway conforming to DIN 6885 (JS9)
- Tapped hole
- Hole for dowel pin

Info.

- Torque figures are for 100 rpm and are given as a guide only



Quality grade 7e25

DISCOUNTS

Qty	1+	6+	19+	50+
Disc.	List	-5%	-10%	On request

Part number		Z	OP	OD	OA	OM	Backlash	Torque (Nm)		Weight	Price each 1 to 5	
S/steel303	S/steel 316	Teeth	Pitch	External	Bore	Boss	(mm)	S/steel 303	S/steel316 (kg)		S/steel303	S/steel 316
PSG1.0-18S	PSG1.0-18SL	18	18	20	5	15	0,127 - 0,053	1,06	0,82	0,034	42,31	€ 48,62
PSG1.0-19S	PSG1.0-19SL	19	19	21	5	15	0,128 - 0,052	1,12	0,87	0,036	42,97	€ 49,36
PSG1.0-20S	PSG1.0-20SL	20	20	22	5	15	0,128 - 0,052	1,49	1,16	0,038	44,34	€ 50,93
PSG1.0-21S	PSG1.0-21SL	21	21	23	5	15	0,128 - 0,052	1,56	1,21	0,041	44,64	€ 51,23
PSG1.0-22S	PSG1.0-22SL	22	22	24	5	15	0,128 - 0,052	1,64	1,27	0,044	45,29	€ 51,99
PSG1.0-23S	PSG1.0-23SL	23	23	25	5	15	0,128 - 0,052	1,71	1,33	0,046	45,44	€ 52,20
PSG1.0-24S	PSG1.0-24SL	24	24	26	6	20	0,128 - 0,052	1,78	1,39	0,061	45,72	€ 52,51
PSG1.0-25S	PSG1.0-25SL	25	25	27	6	20	0,128 - 0,052	1,86	1,45	0,064	47,65	€ 54,68
PSG1.0-26S	PSG1.0-26SL	26	26	28	6	20	0,128 - 0,052	2,27	1,77	0,067	49,36	€ 56,66
PSG1.0-27S	PSG1.0-27SL	27	27	29	6	20	0,128 - 0,052	2,36	1,84	0,070	50,36	€ 57,83
PSG1.0-28S	PSG1.0-28SL	28	28	30	6	20	0,128 - 0,052	2,45	1,90	0,074	51,46	€ 59,12
PSG1.0-29S	PSG1.0-29SL	29	29	31	8	25	0,128 - 0,052	2,54	1,97	0,091	52,83	€ 60,67
PSG1.0-30S	PSG1.0-30SL	30	30	32	8	25	0,128 - 0,052	2,89	2,24	0,094	53,70	€ 61,66
PSG1.0-32S	PSG1.0-32SL	32	32	34	8	25	0,129 - 0,051	3,08	2,39	0,102	55,07	€ 63,25
PSG1.0-35S	PSG1.0-35SL	35	35	37	8	25	0,129 - 0,051	3,37	2,62	0,114	56,97	€ 65,42
PSG1.0-38S	PSG1.0-38SL	38	38	40	10	34	0,129 - 0,051	3,66	2,84	0,163	59,29	€ 68,06
PSG1.0-40S	PSG1.0-40SL	40	40	42	10	34	0,129 - 0,051	4,92	3,82	0,173	61,44	€ 70,57
PSG1.0-42S	PSG1.0-42SL	42	42	44	10	34	0,129 - 0,051	5,16	4,02	0,183	61,95	€ 71,09
PSG1.0-45S	PSG1.0-45SL	45	45	47	10	34	0,129 - 0,051	5,53	4,30	0,199	62,83	€ 72,13
PSG1.0-48S	PSG1.0-48SL	48	48	50	10	34	0,129 - 0,051	5,90	4,59	0,217	63,33	€ 72,70
PSG1.0-50S	PSG1.0-50SL	50	50	52	10	34	0,129 - 0,051	7,29	5,67	0,229	69,89	€ 80,27

Dimensions in mm

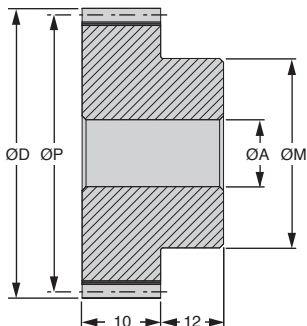

DISCOUNTS

Qty	1+	6+	19+	50+
Disc.	List	-5%	-10%	On request

Part number		Z	ØP	ØD	ØA	ØM	Backlash	Torque (Nm)	Weight	Price each 1 to 5		
S/steel303	S/steel 316	Teeth	Pitch	External	Bore	Boss	(mm)	S/steel 303	S/steel316 (kg)	S/steel303	S/steel 316	
PSG1.0-52S	PSG1.0-52SL	52	52	54	10	40	0,171 - 0,069	7,58	5,90	0,275	71,97 €	82,63 €
PSG1.0-55S	PSG1.0-55SL	55	55	57	10	40	0,171 - 0,069	8,02	6,24	0,295	74,99 €	86,09 €
PSG1.0-58S	PSG1.0-58SL	58	58	60	10	40	0,171 - 0,069	8,45	6,58	0,317	77,27 €	88,70 €
PSG1.0-60S	PSG1.0-60SL	60	60	62	10	40	0,171 - 0,069	10,41	8,09	0,331	79,03 €	90,81 €
PSG1.0-62S	PSG1.0-62SL	62	62	64	10	40	0,171 - 0,069	10,75	8,36	0,347	81,62 €	93,78 €
PSG1.0-65S	PSG1.0-65SL	65	65	67	10	50	0,171 - 0,069	11,27	8,77	0,438	87,47 €	100,43 €
PSG1.0-68S	PSG1.0-68SL	68	68	70	10	50	0,171 - 0,069	11,79	9,17	0,463	92,00 €	105,65 €
PSG1.0-70S	PSG1.0-70SL	70	70	72	10	50	0,171 - 0,069	12,14	9,44	0,481	93,92 €	107,85 €
PSG1.0-72S	PSG1.0-72SL	72	72	74	10	50	0,171 - 0,069	12,49	9,71	0,498	95,95 €	110,19 €
PSG1.0-75S	PSG1.0-75SL	75	75	77	10	50	0,171 - 0,069	13,01	10,12	0,526	102,34 €	117,53 €
PSG1.0-78S	PSG1.0-78SL	78	78	80	10	60	0,171 - 0,069	13,53	10,52	0,638	103,91 €	119,34 €
PSG1.0-80S	PSG1.0-80SL	80	80	82	10	60	0,171 - 0,069	17,76	13,82	0,658	106,00 €	121,69 €
PSG1.0-82S	PSG1.0-82SL	82	82	84	10	60	0,173 - 0,067	18,21	14,16	0,678	107,54 €	123,48 €
PSG1.0-85S	PSG1.0-85SL	85	85	87	10	60	0,173 - 0,067	18,87	14,68	0,709	109,86 €	126,12 €
PSG1.0-90S	PSG1.0-90SL	90	90	92	10	60	0,173 - 0,067	19,98	15,54	0,764	113,37 €	130,15 €
PSG1.0-95S	PSG1.0-95SL	95	95	97	10	60	0,173 - 0,067	21,09	16,41	0,822	125,49 €	144,08 €
PSG1.0-100S	PSG1.0-100SL	100	100	102	14	70	0,173 - 0,067	23,75	18,76	0,968	127,14 €	146,00 €
PSG1.0-110S	PSG1.0-110SL	110	110	112	14	70	0,173 - 0,067	26,12	20,63	1,099	159,16 €	182,73 €
PSG1.0-120S	PSG1.0-120SL	120	120	122	14	70	0,173 - 0,067	28,49	22,51	1,244	180,03 €	206,71 €

Dimensions in mm

Our other products

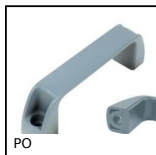

PO

Pull handle - Multi-sector, Smooth hole



ACLCHAR

Hinge for aluminium profile, With elongated holes



SHWbr

Washer - DIN125, Brass



J64

Spur gear coaxial gearbox, from 0.57 to 2.25 Nm - In-line

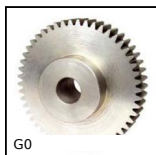

G0

Steel spur gear, Steel 20NCD2



J51

Spur gear coaxial gearbox, from 0.13 to 0.49 Nm - In-line



PCS_PA6

Plastic sprocket, 12.7mm (DIN 08B-1)



VDS

Sliding lock adjustment system, Sliding lock for oblong hole

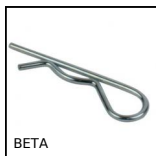

BETA

Hitch pin, Hitch



NSKB

Drylin® Rail end cap, Rail end cap



WW20

Drylin® W slide, slide assembly



PAMF120

Articulated fixable foot, pressed bolt-down base Ø 120, Ø 120

Complementary products



PSG1S

Spur gear - precision range, Stainless steel 316



PSG1

Spur gear - precision range, Pre-hardened Steel 35NCD6