

Module Spur gear

1.0



S/Steel 303
S/Steel 316



Quality grade 7e25

- Quality grade 7e25 DIN 3961 (AGMA Q10)
- Material :
 - Stainless steel 303
 - Stainless steel 316
- Teeth profile conform to DIN 867
- Tooth thickness conforms to DIN 3967
- Efficiency approx 98%

Options

- Alternative bores (H7)
- Keyway conforming to DIN 6885 (JS9)
- Tapped hole
- Hole for dowel pin

Info.

- Torque figures are for 100 rpm and are given as a guide only

DISCOUNTS

Qty	1+	6+	19+	50+
Disc.	List	-5%	-10%	On request

Part number		Z	OP	OD	OA	OM	Backlash	Torque (Nm)		Weight	Price each 1 to 5	
S/steel303	S/steel 316	Teeth	Pitch	External	Bore	Boss	(mm)	S/steel 303	S/steel316 (kg)		S/steel303	S/steel 316
PSG1.0-18S	PSG1.0-18SL	18	18	20	5	15	0,127 - 0,053	1,06	0,82	0,034	42,31	€ 48,62
PSG1.0-19S	PSG1.0-19SL	19	19	21	5	15	0,128 - 0,052	1,12	0,87	0,036	42,97	€ 49,36
PSG1.0-20S	PSG1.0-20SL	20	20	22	5	15	0,128 - 0,052	1,49	1,16	0,038	44,34	€ 50,93
PSG1.0-21S	PSG1.0-21SL	21	21	23	5	15	0,128 - 0,052	1,56	1,21	0,041	44,64	€ 51,23
PSG1.0-22S	PSG1.0-22SL	22	22	24	5	15	0,128 - 0,052	1,64	1,27	0,044	45,29	€ 51,99
PSG1.0-23S	PSG1.0-23SL	23	23	25	5	15	0,128 - 0,052	1,71	1,33	0,046	45,44	€ 52,20
PSG1.0-24S	PSG1.0-24SL	24	24	26	6	20	0,128 - 0,052	1,78	1,39	0,061	45,72	€ 52,51
PSG1.0-25S	PSG1.0-25SL	25	25	27	6	20	0,128 - 0,052	1,86	1,45	0,064	47,65	€ 54,68
PSG1.0-26S	PSG1.0-26SL	26	26	28	6	20	0,128 - 0,052	2,27	1,77	0,067	49,36	€ 56,66
PSG1.0-27S	PSG1.0-27SL	27	27	29	6	20	0,128 - 0,052	2,36	1,84	0,070	50,36	€ 57,83
PSG1.0-28S	PSG1.0-28SL	28	28	30	6	20	0,128 - 0,052	2,45	1,90	0,074	51,46	€ 59,12
PSG1.0-29S	PSG1.0-29SL	29	29	31	8	25	0,128 - 0,052	2,54	1,97	0,091	52,83	€ 60,67
PSG1.0-30S	PSG1.0-30SL	30	30	32	8	25	0,128 - 0,052	2,89	2,24	0,094	53,70	€ 61,66
PSG1.0-32S	PSG1.0-32SL	32	32	34	8	25	0,129 - 0,051	3,08	2,39	0,102	55,07	€ 63,25
PSG1.0-35S	PSG1.0-35SL	35	35	37	8	25	0,129 - 0,051	3,37	2,62	0,114	56,97	€ 65,42
PSG1.0-38S	PSG1.0-38SL	38	38	40	10	34	0,129 - 0,051	3,66	2,84	0,163	59,29	€ 68,06
PSG1.0-40S	PSG1.0-40SL	40	40	42	10	34	0,129 - 0,051	4,92	3,82	0,173	61,44	€ 70,57
PSG1.0-42S	PSG1.0-42SL	42	42	44	10	34	0,129 - 0,051	5,16	4,02	0,183	61,95	€ 71,09
PSG1.0-45S	PSG1.0-45SL	45	45	47	10	34	0,129 - 0,051	5,53	4,30	0,199	62,83	€ 72,13
PSG1.0-48S	PSG1.0-48SL	48	48	50	10	34	0,129 - 0,051	5,90	4,59	0,217	63,33	€ 72,70
PSG1.0-50S	PSG1.0-50SL	50	50	52	10	34	0,129 - 0,051	7,29	5,67	0,229	69,89	€ 80,27

Dimensions in mm

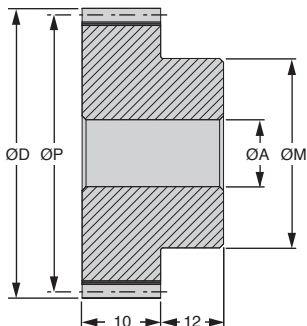

DISCOUNTS

Qty	1+	6+	19+	50+
Disc.	List	-5%	-10%	On request

Part number		Z	OP	OD	OA	OM	Backlash	Torque (Nm)	Weight	Price each 1 to 5		
S/steel303	S/steel 316	Teeth	Pitch	External	Bore	Boss	(mm)	S/steel 303	S/steel316 (kg)	S/steel303	S/steel 316	
PSG1.0-52S	PSG1.0-52SL	52	52	54	10	40	0,171 - 0,069	7,58	5,90	0,275	71,97 €	82,63 €
PSG1.0-55S	PSG1.0-55SL	55	55	57	10	40	0,171 - 0,069	8,02	6,24	0,295	74,99 €	86,09 €
PSG1.0-58S	PSG1.0-58SL	58	58	60	10	40	0,171 - 0,069	8,45	6,58	0,317	77,27 €	88,70 €
PSG1.0-60S	PSG1.0-60SL	60	60	62	10	40	0,171 - 0,069	10,41	8,09	0,331	79,03 €	90,81 €
PSG1.0-62S	PSG1.0-62SL	62	62	64	10	40	0,171 - 0,069	10,75	8,36	0,347	81,62 €	93,78 €
PSG1.0-65S	PSG1.0-65SL	65	65	67	10	50	0,171 - 0,069	11,27	8,77	0,438	87,47 €	100,43 €
PSG1.0-68S	PSG1.0-68SL	68	68	70	10	50	0,171 - 0,069	11,79	9,17	0,463	92,00 €	105,65 €
PSG1.0-70S	PSG1.0-70SL	70	70	72	10	50	0,171 - 0,069	12,14	9,44	0,481	93,92 €	107,85 €
PSG1.0-72S	PSG1.0-72SL	72	72	74	10	50	0,171 - 0,069	12,49	9,71	0,498	95,95 €	110,19 €
PSG1.0-75S	PSG1.0-75SL	75	75	77	10	50	0,171 - 0,069	13,01	10,12	0,526	102,34 €	117,53 €
PSG1.0-78S	PSG1.0-78SL	78	78	80	10	60	0,171 - 0,069	13,53	10,52	0,638	103,91 €	119,34 €
PSG1.0-80S	PSG1.0-80SL	80	80	82	10	60	0,171 - 0,069	17,76	13,82	0,658	106,00 €	121,69 €
PSG1.0-82S	PSG1.0-82SL	82	82	84	10	60	0,173 - 0,067	18,21	14,16	0,678	107,54 €	123,48 €
PSG1.0-85S	PSG1.0-85SL	85	85	87	10	60	0,173 - 0,067	18,87	14,68	0,709	109,86 €	126,12 €
PSG1.0-90S	PSG1.0-90SL	90	90	92	10	60	0,173 - 0,067	19,98	15,54	0,764	113,37 €	130,15 €
PSG1.0-95S	PSG1.0-95SL	95	95	97	10	60	0,173 - 0,067	21,09	16,41	0,822	125,49 €	144,08 €
PSG1.0-100S	PSG1.0-100SL	100	100	102	14	70	0,173 - 0,067	23,75	18,76	0,968	127,14 €	146,00 €
PSG1.0-110S	PSG1.0-110SL	110	110	112	14	70	0,173 - 0,067	26,12	20,63	1,099	159,16 €	182,73 €
PSG1.0-120S	PSG1.0-120SL	120	120	122	14	70	0,173 - 0,067	28,49	22,51	1,244	180,03 €	206,71 €

Dimensions in mm

Our other products



PR821

Idler sprocket for slat top chain, Ranges 821 and 805



SH2

Parallel axis helical gear, Steel 20NCD2



PT880

Drive sprocket for slat top chain, Range 880



CLQ

12.7mm wide steel feeler strip on rolls, Feeler strip on rolls



PFC

Fixed rubber levelling foot, Levelling support for small parts



SMS

Spiral bevel gear, 1:1



VPSS

Small 6 lobe threaded handle - male, Duroplast - Stainless steel



FF40

Offset spur gear reducer, from 59 to 210 Nm



GE1006

Elastic ringed latch, Hooks into a slot



HAR9

Captive C washer, DIN 6371



BPPss

Pressed stainless steel pillow block, Stainless steel



GMK17_BR

Clamp for guiding profile, Rounded only - double

Complementary products



PSG1S

Spur gear - precision range, Stainless steel 303



PSG1

Spur gear - precision range, Pre-hardened Steel 35NCD6