

# Module 0.5 Spur gear

S/Steel 303  
S/Steel 316



- Quality grade 7e DIN 58405 (AGMA Q10)
- Material :
  - Stainless steel 303
  - Stainless steel 316
- Teeth profile conform to DIN 867
- Tooth thickness conforms to DIN 58405
- Efficiency approx 98%

## Options

- Alternative bores (H7)
- Keyway conforming to DIN 6885 (J59)
- Tapped hole
- Hole for dowel pin

## Info.

- Torque figures are for 100 rpm and are given as a guide only



Quality grade 7e

## DISCOUNTS

Qty	1+	6+	19+	50+
Disc.	List	-5%	-10%	On request

Part number		Z	ØP	ØD	ØA	ØM	Backlash	Torque (Nm)		Weight	Price each 1 to 5	
S/steel303	S/steel 316	Teeth	Pitch	External	Bore	Boss	(mm)	S/steel 303	S/steel316 (kg)	S/steel303	S/steel 316	
PSG0.5-20S	PSG0.5-20SL	20	10,0	11,0	4	8	0,076 - 0,037	0,21	0,17	0,006	40,78	€ 46,83
PSG0.5-21S	PSG0.5-21SL	21	10,5	11,5	4	8	0,077 - 0,036	0,22	0,17	0,006	41,20	€ 47,29
PSG0.5-22S	PSG0.5-22SL	22	11,0	12,0	4	8	0,077 - 0,036	0,23	0,18	0,006	41,73	€ 47,94
PSG0.5-23S	PSG0.5-23SL	23	11,5	12,5	4	8	0,077 - 0,036	0,25	0,19	0,007	42,25	€ 48,47
PSG0.5-24S	PSG0.5-24SL	24	12,0	13,0	5	10	0,077 - 0,036	0,26	0,20	0,008	42,71	€ 49,03
PSG0.5-25S	PSG0.5-25SL	25	12,5	13,5	5	10	0,087 - 0,042	0,27	0,21	0,009	43,16	€ 49,60
PSG0.5-26S	PSG0.5-26SL	26	13,0	14,0	5	10	0,087 - 0,042	0,33	0,25	0,009	43,79	€ 50,31
PSG0.5-27S	PSG0.5-27SL	27	13,5	14,5	5	10	0,087 - 0,042	0,34	0,26	0,010	44,26	€ 50,80
PSG0.5-28S	PSG0.5-28SL	28	14,0	15,0	5	10	0,087 - 0,042	0,35	0,27	0,010	44,70	€ 51,34
PSG0.5-29S	PSG0.5-29SL	29	14,5	15,5	6	13	0,087 - 0,042	0,36	0,28	0,014	44,97	€ 51,67
PSG0.5-30S	PSG0.5-30SL	30	15,0	16,0	6	13	0,087 - 0,042	0,41	0,32	0,014	45,16	€ 51,86
PSG0.5-32S	PSG0.5-32SL	32	16,0	17,0	6	13	0,087 - 0,042	0,44	0,34	0,015	46,26	€ 53,11
PSG0.5-35S	PSG0.5-35SL	35	17,5	18,5	6	13	0,087 - 0,042	0,48	0,38	0,017	47,79	€ 54,90
PSG0.5-38S	PSG0.5-38SL	38	19,0	20,0	6	17	0,089 - 0,041	0,52	0,41	0,026	49,25	€ 56,56
PSG0.5-40S	PSG0.5-40SL	40	20,0	21,0	6	17	0,089 - 0,041	0,71	0,55	0,027	50,36	€ 57,83
PSG0.5-42S	PSG0.5-42SL	42	21,0	22,0	6	17	0,089 - 0,041	0,74	0,58	0,028	51,23	€ 58,85
PSG0.5-45S	PSG0.5-45SL	45	22,5	23,5	6	17	0,089 - 0,041	0,79	0,62	0,031	52,83	€ 60,67
PSG0.5-48S	PSG0.5-48SL	48	24,0	25,0	6	17	0,089 - 0,041	0,85	0,66	0,033	54,90	€ 63,00
PSG0.5-50S	PSG0.5-50SL	50	25,0	26,0	6	17	0,089 - 0,041	1,05	0,81	0,034	55,46	€ 63,70
PSG0.5-52S	PSG0.5-52SL	52	26,0	27,0	6	17	0,097 - 0,046	1,09	0,85	0,036	56,30	€ 64,67
PSG0.5-55S	PSG0.5-55SL	55	27,5	28,5	6	17	0,097 - 0,046	1,15	0,90	0,038	57,44	€ 65,98
PSG0.5-58S	PSG0.5-58SL	58	29,0	30,0	6	17	0,097 - 0,046	1,21	0,94	0,041	58,65	€ 67,30
PSG0.5-60S	PSG0.5-60SL	60	30,0	31,0	6	17	0,097 - 0,046	1,49	1,16	0,043	59,27	€ 68,04

Dimensions in mm

# Module 0.5

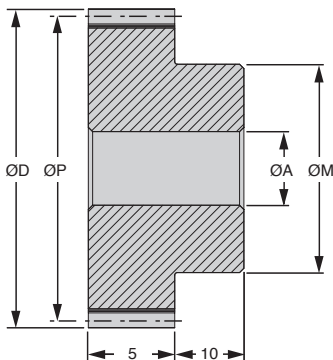
## DISCOUNTS

Qty	1+	6+	19+	50+
Disc.	List	-5%	-10%	On request

Part number		Z	OP	OD	OA	OM	Backlash	Torque (Nm)	Weight	Price each 1 to 5		
S/steel303	S/steel 316	Teeth	Pitch	External	Bore	Boss	(mm)	S/steel 303	S/steel316 (kg)	S/steel303	S/steel 316	
PSG0.5-62S	PSG0.5-62SL	62	31,0	32,0	8	20	0,098 - 0,044	1,54	1,20	0,049	59,98 €	68,89 €
PSG0.5-65S	PSG0.5-65SL	65	32,5	33,5	8	20	0,098 - 0,044	1,62	1,26	0,052	61,30 €	70,38 €
PSG0.5-68S	PSG0.5-68SL	68	34,0	35,0	8	20	0,098 - 0,044	1,69	1,32	0,055	61,69 €	70,83 €
PSG0.5-70S	PSG0.5-70SL	70	35,0	36,0	8	20	0,098 - 0,044	1,74	1,36	0,057	62,34 €	71,63 €
PSG0.5-72S	PSG0.5-72SL	72	36,0	37,0	8	20	0,098 - 0,044	1,79	1,39	0,060	62,95 €	72,30 €
PSG0.5-75S	PSG0.5-75SL	75	37,5	38,5	8	20	0,098 - 0,044	1,87	1,45	0,063	63,43 €	72,86 €
PSG0.5-78S	PSG0.5-78SL	78	39,0	40,0	8	20	0,098 - 0,044	1,94	1,51	0,067	64,36 €	73,94 €
PSG0.5-80S	PSG0.5-80SL	80	40,0	41,0	8	25	0,098 - 0,044	2,55	1,98	0,083	64,86 €	74,47 €
PSG0.5-82S	PSG0.5-82SL	82	41,0	42,0	8	25	0,098 - 0,044	2,61	2,03	0,086	65,54 €	75,30 €
PSG0.5-85S	PSG0.5-85SL	85	42,5	43,5	8	25	0,098 - 0,044	2,71	2,11	0,090	66,24 €	76,03 €
PSG0.5-90S	PSG0.5-90SL	90	45,0	46,0	8	25	0,098 - 0,044	2,87	2,23	0,097	67,30 €	77,30 €
PSG0.5-100S	PSG0.5-100SL	100	50,0	51,0	10	30	0,098 - 0,044	3,84	2,99	0,125	68,31 €	78,46 €
PSG0.5-120S	PSG0.5-120SL	120	60,0	61,0	10	35	0,111 - 0,049	4,61	3,59	0,180	82,78 €	95,04 €
PSG0.5-130S	PSG0.5-130SL	130	65,0	66,0	10	35	0,111 - 0,049	5,00	3,89	0,200	94,95 €	109,04 €
PSG0.5-140S	PSG0.5-140SL	140	70,0	71,0	10	35	0,111 - 0,049	5,38	4,19	0,221	98,93 €	113,56 €
PSG0.5-150S	PSG0.5-150SL	150	75,0	76,0	10	40	0,111 - 0,049	7,79	6,06	0,267	107,70 €	123,68 €
PSG0.5-200S	PSG0.5-200SL	200	100,0	101,0	14	50	0,113 - 0,047	11,61	9,03	0,452	132,75 €	152,46 €
PSG0.5-250S	PSG0.5-250SL	250	125,0	126,0	16	60	0,136 - 0,062	14,51	11,29	0,692	159,23 €	182,87 €

Dimensions in mm

## Our other products



PTA100

Articulated levelling foot, pressed base Ø100, Ø 100



HTD14M\_85

HTD Heavy duty timing pulley, HTD14 Steel

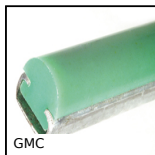

GMC

Flat profile - Round guide, Flat profile - round guide



SLHHlok

Horizontal toggle clamp, Horizontal toggle clamp / horizontal foot



APB\_BOU

Protective cap, Safety cap



RPCplss

Swivel castor with double brake, Stainless steel - Polyamide



BOX-TOR-ORFS

Box set of Nitrile O-rings NBR90Sh A, 7.65 x 1.78mm to 37.82 x 1.78



RJA10\_03

Sealing strip, Clipping



NSO

Housing for open linear bearing, Opened - long



BLHM70

Right angled gearbox, up to 128 Nm



DBL805

Idler for slat top chain, Range 805



BS3

Panamech, Multi-Beam stainless steel, Stainless steel - with set screw

## Complementary products