

# Module 0.5 Spur gear

S/Steel 303  
S/Steel 316



- Quality grade 7e DIN 58405 (AGMA Q10)
- Material :
  - Stainless steel 303
  - Stainless steel 316
- Teeth profile conform to DIN 867
- Tooth thickness conforms to DIN 58405
- Efficiency approx 98%

## Options

- Alternative bores (H7)
- Keyway conforming to DIN 6885 (J59)
- Tapped hole
- Hole for dowel pin

## Info.

- Torque figures are for 100 rpm and are given as a guide only



Quality grade 7e

## DISCOUNTS

Qty	1+	6+	19+	50+
Disc.	List	-5%	-10%	On request

Part number		Z	ØP	ØD	ØA	ØM	Backlash	Torque (Nm)		Weight	Price each 1 to 5	
S/steel303	S/steel 316	Teeth	Pitch	External	Bore	Boss	(mm)	S/steel 303	S/steel316 (kg)	S/steel303	S/steel 316	
PSG0.5-20S	PSG0.5-20SL	20	10,0	11,0	4	8	0,076 - 0,037	0,21	0,17	0,006	40,78	€ 46,83
PSG0.5-21S	PSG0.5-21SL	21	10,5	11,5	4	8	0,077 - 0,036	0,22	0,17	0,006	41,20	€ 47,29
PSG0.5-22S	PSG0.5-22SL	22	11,0	12,0	4	8	0,077 - 0,036	0,23	0,18	0,006	41,73	€ 47,94
PSG0.5-23S	PSG0.5-23SL	23	11,5	12,5	4	8	0,077 - 0,036	0,25	0,19	0,007	42,25	€ 48,47
PSG0.5-24S	PSG0.5-24SL	24	12,0	13,0	5	10	0,077 - 0,036	0,26	0,20	0,008	42,71	€ 49,03
PSG0.5-25S	PSG0.5-25SL	25	12,5	13,5	5	10	0,087 - 0,042	0,27	0,21	0,009	43,16	€ 49,60
PSG0.5-26S	PSG0.5-26SL	26	13,0	14,0	5	10	0,087 - 0,042	0,33	0,25	0,009	43,79	€ 50,31
PSG0.5-27S	PSG0.5-27SL	27	13,5	14,5	5	10	0,087 - 0,042	0,34	0,26	0,010	44,26	€ 50,80
PSG0.5-28S	PSG0.5-28SL	28	14,0	15,0	5	10	0,087 - 0,042	0,35	0,27	0,010	44,70	€ 51,34
PSG0.5-29S	PSG0.5-29SL	29	14,5	15,5	6	13	0,087 - 0,042	0,36	0,28	0,014	44,97	€ 51,67
PSG0.5-30S	PSG0.5-30SL	30	15,0	16,0	6	13	0,087 - 0,042	0,41	0,32	0,014	45,16	€ 51,86
PSG0.5-32S	PSG0.5-32SL	32	16,0	17,0	6	13	0,087 - 0,042	0,44	0,34	0,015	46,26	€ 53,11
PSG0.5-35S	PSG0.5-35SL	35	17,5	18,5	6	13	0,087 - 0,042	0,48	0,38	0,017	47,79	€ 54,90
PSG0.5-38S	PSG0.5-38SL	38	19,0	20,0	6	17	0,089 - 0,041	0,52	0,41	0,026	49,25	€ 56,56
PSG0.5-40S	PSG0.5-40SL	40	20,0	21,0	6	17	0,089 - 0,041	0,71	0,55	0,027	50,36	€ 57,83
PSG0.5-42S	PSG0.5-42SL	42	21,0	22,0	6	17	0,089 - 0,041	0,74	0,58	0,028	51,23	€ 58,85
PSG0.5-45S	PSG0.5-45SL	45	22,5	23,5	6	17	0,089 - 0,041	0,79	0,62	0,031	52,83	€ 60,67
PSG0.5-48S	PSG0.5-48SL	48	24,0	25,0	6	17	0,089 - 0,041	0,85	0,66	0,033	54,90	€ 63,00
PSG0.5-50S	PSG0.5-50SL	50	25,0	26,0	6	17	0,089 - 0,041	1,05	0,81	0,034	55,46	€ 63,70
PSG0.5-52S	PSG0.5-52SL	52	26,0	27,0	6	17	0,097 - 0,046	1,09	0,85	0,036	56,30	€ 64,67
PSG0.5-55S	PSG0.5-55SL	55	27,5	28,5	6	17	0,097 - 0,046	1,15	0,90	0,038	57,44	€ 65,98
PSG0.5-58S	PSG0.5-58SL	58	29,0	30,0	6	17	0,097 - 0,046	1,21	0,94	0,041	58,65	€ 67,30
PSG0.5-60S	PSG0.5-60SL	60	30,0	31,0	6	17	0,097 - 0,046	1,49	1,16	0,043	59,27	€ 68,04

Dimensions in mm

# Module 0.5

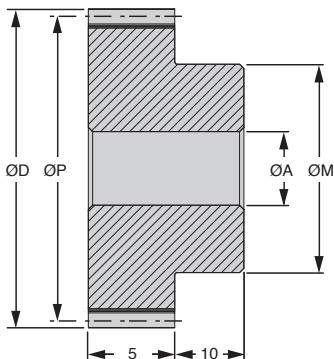

## DISCOUNTS

Qty	1+	6+	19+	50+
Disc.	List	-5%	-10%	On request

Part number		Z	OP	OD	OA	OM	Backlash	Torque (Nm)	Weight	Price each 1 to 5		
S/steel303	S/steel 316	Teeth	Pitch	External	Bore	Boss	(mm)	S/steel 303	S/steel316 (kg)	S/steel303	S/steel 316	
PSG0.5-62S	PSG0.5-62SL	62	31,0	32,0	8	20	0,098 - 0,044	1,54	1,20	0,049	59,98 €	68,89 €
PSG0.5-65S	PSG0.5-65SL	65	32,5	33,5	8	20	0,098 - 0,044	1,62	1,26	0,052	61,30 €	70,38 €
PSG0.5-68S	PSG0.5-68SL	68	34,0	35,0	8	20	0,098 - 0,044	1,69	1,32	0,055	61,69 €	70,83 €
PSG0.5-70S	PSG0.5-70SL	70	35,0	36,0	8	20	0,098 - 0,044	1,74	1,36	0,057	62,34 €	71,63 €
PSG0.5-72S	PSG0.5-72SL	72	36,0	37,0	8	20	0,098 - 0,044	1,79	1,39	0,060	62,95 €	72,30 €
PSG0.5-75S	PSG0.5-75SL	75	37,5	38,5	8	20	0,098 - 0,044	1,87	1,45	0,063	63,43 €	72,86 €
PSG0.5-78S	PSG0.5-78SL	78	39,0	40,0	8	20	0,098 - 0,044	1,94	1,51	0,067	64,36 €	73,94 €
PSG0.5-80S	PSG0.5-80SL	80	40,0	41,0	8	25	0,098 - 0,044	2,55	1,98	0,083	64,86 €	74,47 €
PSG0.5-82S	PSG0.5-82SL	82	41,0	42,0	8	25	0,098 - 0,044	2,61	2,03	0,086	65,54 €	75,30 €
PSG0.5-85S	PSG0.5-85SL	85	42,5	43,5	8	25	0,098 - 0,044	2,71	2,11	0,090	66,24 €	76,03 €
PSG0.5-90S	PSG0.5-90SL	90	45,0	46,0	8	25	0,098 - 0,044	2,87	2,23	0,097	67,30 €	77,30 €
PSG0.5-100S	PSG0.5-100SL	100	50,0	51,0	10	30	0,098 - 0,044	3,84	2,99	0,125	68,31 €	78,46 €
PSG0.5-120S	PSG0.5-120SL	120	60,0	61,0	10	35	0,111 - 0,049	4,61	3,59	0,180	82,78 €	95,04 €
PSG0.5-130S	PSG0.5-130SL	130	65,0	66,0	10	35	0,111 - 0,049	5,00	3,89	0,200	94,95 €	109,04 €
PSG0.5-140S	PSG0.5-140SL	140	70,0	71,0	10	35	0,111 - 0,049	5,38	4,19	0,221	98,93 €	113,56 €
PSG0.5-150S	PSG0.5-150SL	150	75,0	76,0	10	40	0,111 - 0,049	7,79	6,06	0,267	107,70 €	123,68 €
PSG0.5-200S	PSG0.5-200SL	200	100,0	101,0	14	50	0,113 - 0,047	11,61	9,03	0,452	132,75 €	152,46 €
PSG0.5-250S	PSG0.5-250SL	250	125,0	126,0	16	60	0,136 - 0,062	14,51	11,29	0,692	159,23 €	182,87 €

Dimensions in mm

## Our other products

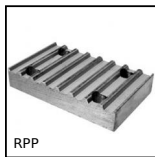

RPP

Connecting plate for RPP type timing belts, RPP14



HLC24

Right angle spiroid bevel gearbox, Up to 78Nm



HTD5M-BAR

HTD type tooth bar stock, HTD5



TM\_CTM\_CTF

Suction cup threaded insert, Insert for suction cup - Tread click-in



MEP

Revolving handle for handwheel, Fixed

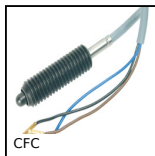

CFC

Spring loaded position switch, Electric contact



PHG05

Parallel axis helical gear - Precision range, 20NCD2 case hardened s...



M1

Worm and wheel set, Bronze



J65

Spur gear coaxial gearbox, from 0.80 to 5.00 Nm



BLHM70

Right angled gearbox, up to 128 Nm



BPHF

Ball transfer unit push fit, Heavy



CDP

Flanged drill bushing, Steel

## Complementary products



PSG05S

Spur gear - precision range, Stainless steel 316



PSG05

Spur gear - precision range, Pre-hardened Steel 35NCD6