

# Articulated bracket for use with aluminium profile

**PRFART MiniTec** For loads up to 5000N

- **Cannot be used as a hinge**
- Fixing kit supplied
- Materials:
  - Body/handle: grey powder coated aluminium GD
  - Screw/locking piece: aluminium GD

## Uses

### Simple bracket

- Use for connecting profiles at any angle

- Use reinforcing structures or frames

### Bracket with handle

- Allows components to be re-positioned quickly

- Use for positioning control stations or widgets

- For heavy loads, use multiple profiles/brackets

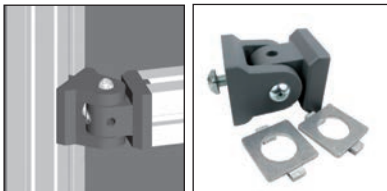

PRF-ART

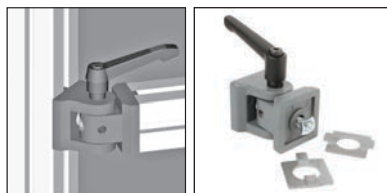

PRF-ART-P

## Assembly

- Place the two parts of the bracket in required positions
- Fix using the screws supplied
- Tighten using the handle (PRF-ART-P) or the lateral screw (PRF-ART)
- The joint cannot be taken apart once assembled.

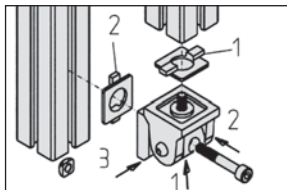
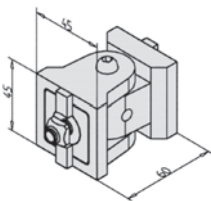

## DISCOUNTS

Qty	1+	50+	100+
Disc.	List -5%	On request	

Part number	Max. load (N)	Weight (kg)	Stock*	Price each 1 to 49
<b>Simple bracket</b>				
PRF-ART	5000	0,25	✓	33,46 €
<b>Bracket with handle</b>				
PRF-ART-P	1500	0,28	✓	38,43 €

\*Depending on availability - Dimensions in mm

## Our other products



BSM

Spring plunger with internal hexagonal socket, steel body, plastic pin



GMC\_GMK\_BR

Guiding profile clamp, Flat or rounded



VTSM

Ball head screws Hygienic Design®, Stainless steel



PRF\_RR

Coupling bar for aluminium profile, Coupling bar



MBF

Threaded blocking clamp, Threaded locking clamp



SBF

Sealed flange bearing unit for Food Industry, cover



PRF\_ART

Articulated bracket for use with aluminium profile, Standard



SLH

Horizontal toggle clamp, Horizontal Lever Clamp - steel



GPBSS

Threaded spherical knob, Stainless steel 304



GLB

Small 6 lobe female handle, Technopolymer -



FBL6000\_K13

Brush strip per meter PP fibres Ø0.2, Black striated polypropylene



NCT

Square tube connector, Fixed angle

## Complementary products



PRF4545

Standard aluminium profile, 45 x 45 mm