

Roller wheel for aluminium profile

Roller for linear guiding shaft **MiniTec** PRFGAL

- Guiding wheel
- Double row bearing
- Roller PRF-GAL can compensate for small amounts of backlash for parallel working guidance systems
- PRF-GAL-12 is used with a Ø12mm guide shaft such as Z-12-3000A or Z-12-3000B
- Material: steel

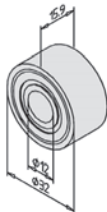
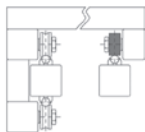

PRF-GAL

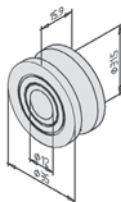

PRF-GAL-12

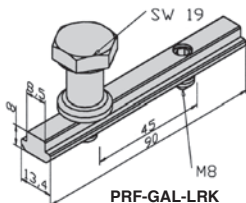

PRF-GAL-LRK

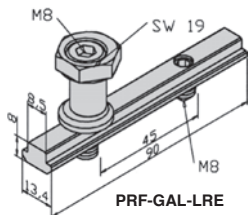

PRF-GAL-LRE



PRF-GAL-LRK

PRF-GAL-LRE

DISCOUNTS

Qty	1+	50+	100+
Disc.	List	-5%	On request

Part number	Profile	Static (N)	Load Dynamic(N)	Weight (kg)	Stock*	Price each 1 to 49
Roller						
PRF-GAL	Flat	5100	8600	0,060	-	29,89 €
PRF-GAL-12	Concave Ø12	6000	10500	0,068	✓	22,19 €
Fixing kit for roller						
PRF-GAL-LRK	concentric	-	-	0,100	✓	13,88 €
PRF-GAL-LRE	Eccentric	-	-	0,100	✓	17,24 €

*Depending on availability - Dimensions in mm

Our other products



G-ECO

Eco range Spur gear,
Steel C45

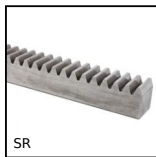

SR

Narrow spur rack,
Stainless steel



INS_BR

Self tapping brass
insert, Brass



BABS

630 Stainless steel
compact ball pin,
Hardened stainless
steel



DOMI120

Connecting kits, XZ
linking kit

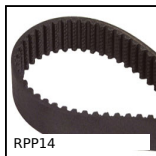

RPP14

RPP heavy duty
timing belt, RPP14

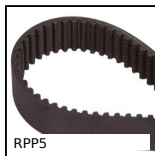

RPP5

RPP heavy duty
timing belt, RPP5



CHTRP

Single and dual
output gearboxes, Up
to 75,7 Nm



SUPss

Self-centering
clamping hub



TBL

Mini leadscrew table
with metric thread,



PRF_PA

Angle plate for
aluminium profile,



SH0

Parallel axis helical
gear, Steel 20NCD2

Complementary products



PRF_GAL

Roller for aluminium
profile, Fixing kit for
roller concentric



PRF_GAL

Roller for aluminium
profile, Fixing kit for
roller eccentric