

Fastener for aluminium profile

Stock

PRF **MiniTec**
FIXANG

Angular joint

- Creates an angular joint between the end of a profile and the side of a second.
- Fixing kit supplied
- Material: electroplated steel



Assembly

- Drill a $\varnothing 10.2\text{mm}$ in the centre of the side of the horizontal profile
- Drill a $\varnothing 8.2\text{ mm}$ at a distance A (see table) from the end of the angled profile
- Insert the angled fastener in the $\varnothing 10.2\text{mm}$ hole
- Position the PRF-ECL-M8 nut in the slot at $\varnothing 8.2$ hole
- Tighten the joint by means of the M8 grubscrew

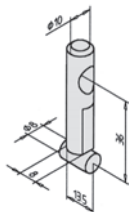

a	25°	30°	35°	40°	45°	50°	55°	60°	65°	70°	75°	80°	85°
A(mm)	21	24	26	28	29	30	30,5	31	31,5	32	32	32	32

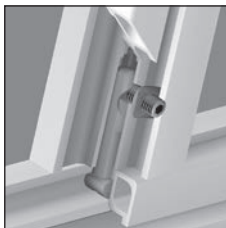
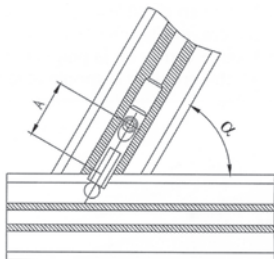
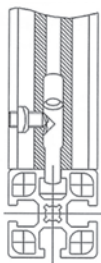

DISCOUNTS

Qty	1+	50+	100+
Disc.	List	-5%	On request

Part number	Weight (kg)	Stock*	Price each 1 to 49
PRF-FIX-ANG	0,051	✓	11,74 €

*Depending on availability - Dimensions in mm

Our other products



DZYSS
Stainless steel
cylindrical stop,
stainless steel



LRR-53
Spring loaded latch,
Spring return latch -
steel



RBGpl
Fixed castor with
plate, Steel - grey
rubber

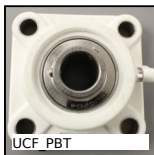

UCF PBT
Stainless
steel/Polymer flanged
bearing, Polymer and
stainless steel



ACM_DZ
Clip for bonnet
fastener, Clip



SRG
Adjustable latch
clamp with strike
plate, Stroke from
96mm to 121,7mm



RFK58B
Hypoid gearbox -
Stainless steel, up to
500 Nm



PLM-SC
Magnetic stud with
threaded hole, With
threaded hole



PGT
Sliding profile, Sliding
panel support



T2
T type timing belt,
T2.5 Steel cored
polyurethane



RNAST
Cam follower without
axial guide, Without
interior ring



PCLA_T
Technopolymer
clamping lever - male,
Plastic

Complementary products



PRF_ECL
Nut for aluminium
profile, Steel square
nut with tab



PRF4545
Standard stainless
steel profile, 45 x 45
mm



PRF_FIX_UNI
Universal fastener for
aluminium profile,
Universal