

Manual bench press



PRES7HR

700kg capacity

- Knee-joint press

- The maximum power is reached at the end of the stroke
- The travelling nut is prevented from turning
- Adjustable free height
- Screw stroke adjustment
- Quick and easy installation

Uses

- This model is particularly robust and is normally used for the assembly of parts, simple bending tasks and various fastening operations

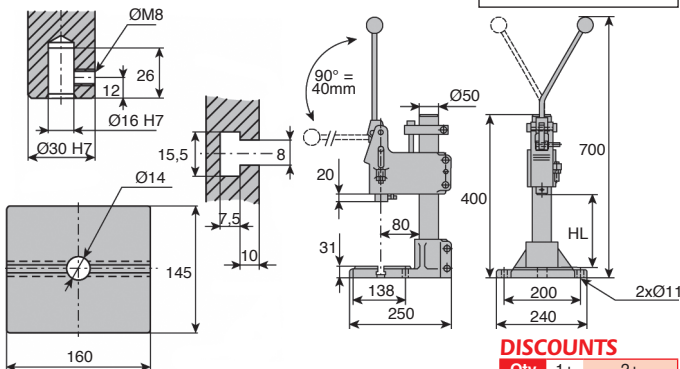

DISCOUNTS

Qty	1+	2+
Disc.	List	On request

Part number	Power (kg)	Free height HL (mm)	Stroke length (mm)	Goose neck depth (mm)	Weight (kg)	Price each
PRES-7HR	700	35 - 260	40	95	25	955,42 €

Dimensions in mm

Our other products



AHEX
Hexagonal shaft,
Hexagonal shaft



M1
Worm and wheel set,
Non hardened steel



HDSS
Needle roller double
universal joint -
Stainless steel, Heavy
duty



PRF_JL2
Lip seal for panel,
Door seal - Ø 2mm



RAS
90° ball and socket
joints DIN71802, Steel



PTA50
Articulated levelling
foot, pressed base
Ø50, 4000N



CQA20
Accessory for
adjustment slide-
system, 20



SSE
Stainless steel
spherical bearing,
Stainless steel / PTFE



RAG
Roller guide,



ZHG6
Plastic spur gear,
Machined plastic
(delrin)



MHXred
Reducing sleeve
male/female,
Hexagonal - steel



PRF_ART
Articulated bracket for
use with aluminium
profile, With clamping
ha...

Complementary products



PRES5HR
Manual workbench
press, Force up to
500kg



PRES4HR
Manual workbench
press, Force up to
600kg



CDP
Flanged drill bushing,
Steel



CDPC
Flanged drill bushing,
Steel