

Fixable articulated foot Ø123

Stock Ste Sta

PR125

Maximum load 35,000N

- Levelling foot
- Non slip base
- Materials:
Base: Black glass reinforced polyamide (Shore 70)
Spindle: Zinc plated steel or stainless steel 304
(nut not supplied)

Advantages

- Articulated rod allows auto-alignment with the ground
- Sole material ensures flexibility and grip

Accessories

- Extension for articulated foot
PR125-ENT (p.27)

Info.

- Values given for static loads will be reduced in case of a vibrating load

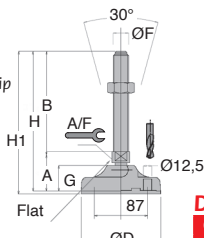

With non-slip base



DISCOUNTS

Qty	1+	20+	50+
Disc.	List -10%	On request	

Part number	ØD	Thread	B	A	A/F	G	H	H1	Static load (N)	Price each	
										Stock*	1 to 19
Steel spindle											
PR125-16-75	123	M16	75	57	20	37	132	133	35000	✓	21,89 €
PR125-16-150	123	M16	150	57	20	37	207	208	35000	✓	25,75 €
PR125-16-225	123	M16	225	57	20	37	282	285	35000	✓	30,10 €
PR125-20-125	123	M20	125	57	20	37	182	185	35000	✓	21,77 €
PR125-20-200	123	M20	200	57	20	37	257	260	35000	✓	25,42 €
PR125-20-250	123	M20	250	57	20	37	307	310	35000	✓	29,87 €
PR125-24-125	123	M24	125	57	20	37	182	185	35000	✓	21,77 €
PR125-24-200	123	M24	200	57	20	37	257	260	35000	✓	25,42 €
PR125-24-250	123	M24	250	57	20	37	307	310	35000	✓	29,87 €
PR125-30-125	123	M30	125	58	26	37	183	186	35000	✓	23,38 €
PR125-30-200	123	M30	200	58	26	37	258	261	35000	✓	27,97 €
PR125-30-250	123	M30	250	58	26	37	308	311	35000	-	31,13 €
Stainless steel spindle											
PR125-16-75/SS	123	M16	75	57	20	37	132	135	35000	-	37,74 €
PR125-16-150/SS	123	M16	150	57	20	37	207	210	35000	✓	48,48 €
PR125-16-225/SS	123	M16	225	57	20	37	282	285	35000	-	61,20 €
PR125-20-125/SS	123	M20	125	57	20	37	182	185	35000	✓	44,91 €
PR125-20-200/SS	123	M20	200	57	20	37	257	260	35000	✓	57,38 €
PR125-20-250/SS	123	M20	250	57	20	37	307	310	35000	-	65,97 €
PR125-24-125/SS	123	M24	125	57	20	37	182	185	35000	-	44,91 €
PR125-24-200/SS	123	M24	200	57	20	37	257	260	35000	-	51,18 €
PR125-24-250/SS	123	M24	250	57	20	37	307	310	35000	-	65,97 €
PR125-30-125/SS	123	M30	125	58	26	37	183	186	35000	-	50,96 €
PR125-30-200/SS	123	M30	200	58	26	37	258	261	35000	-	65,06 €
PR125-30-250/SS	123	M30	250	58	26	37	308	311	35000	-	74,14 €

*Depending on availability - Dimensions in mm

Extension for articulated foot Ø123

For articulated foot PR125

PR125

Extension with mounting holes for articulated feet PR125

- Material
Polyamide
- Delivered without anti-slip rubber pad
- Suitable for any type of floor

Advantages

- Easily compensates for large differences in floor level

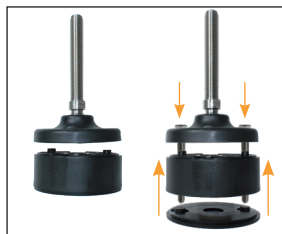

Assembly example
(screws not included)

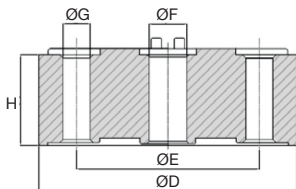

Application example

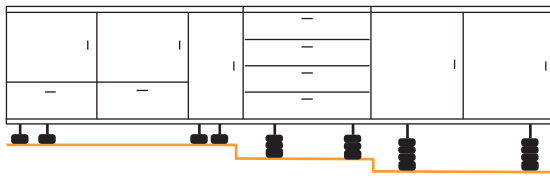

DISCOUNTS

Qty	1+	20+	50+
Disc.	List -10%	On request	

Part number	ØD	ØE	H	ØG	ØF	Static load (N)	Stock*	Price each 1 à 19
PR125-ENT	123	87	43	13	18	35000	-	13,44 €

*Dans la limite du disponible - Dimensions en mm

Our other products



Eco. range steel bevel gear, 1:1



Worm and wheel set, Bronze



Retaining cable for ball pin, Retaining cable



Flexible drive shaft, Masterflex® Steel, with PVC casing



Indexing plunger, stainless steel



Roll-Ring® chain tensioner, Roll-Ring® Self-adjusting



Spur gear - precision range, Stainless steel 316



Spring hinge, screwed

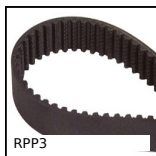

RPP heavy duty timing belt, RPP3



Miniature motorised actuator 4A, 4 ampers



Articulated levelling foot, pressed base Ø150, Ø 150



Joining plate for aluminium profile, Joint plate - 176x86 mm

Complementary products



Articulated foot Ø123, Ø 123



Articulated foot Ø123, Ø 123