

Magnetic stud



PLM

AlNiCo

- Solid magnet in steel reinforced casing
- Shielded system
- These magnetic studs can be used for support, lifting or assembly
- Max working temp +450°C
- **Material, finish:**
 - Steel body, red lacquered finish
 - Magnetic core AlNiCo

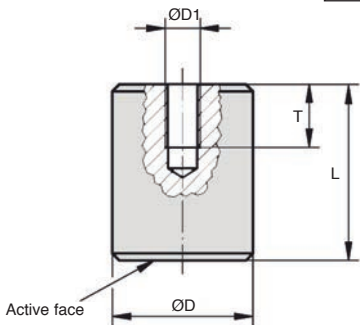

✓ INCREASED STOCK

DISCOUNTS

Qty	1+	6+	20+	40+	60+
Disc.	List	-15%	-20%	-30%	On request

Part number	ØD	ØD1	L	T	Attraction force (N)	Weight (g)	Stock*	Price each 1 to 5
PLM17-16/A	17	M6	16	4	18	26	✓	7,38 €
PLM21-19/A	21	M6	19	5	28	50	✓	7,86 €
PLM27-25/A	27	M6	25	6	65	110	✓	11,86 €
PLM35-30/A	35	M6	30	9	115	215	✓	21,48 €
PLM65-43/A	65	M12	43	13	400	1080	-	87,97 €

Dimensions in mm

Our other products



BAC105

Storage bin, 8mm



H3

Crossed helical gear
crossed axis at 90°,
Steel 20NCD2



DILC

Indexing plunger with
cam, with cam



ABL100005

Antistatic brush,
Standard

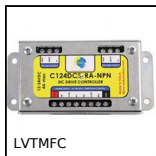

LVTMFC

Device for controlling
limit switches, For
mini-actuator LVT



DB

Steel bevel gear, 2:1



TCXR

Automatic chain
tensioner, With steel
sprocket



RHTcscs

High Temperature
Castor, up to 200kg



QNU

Single row cylindrical
roller bearing, Free
inner ring



SH3

Parallel axis helical
gear, Steel 20NCD2



SLB

Indexing plunger,
steel class 5.8



PSG2

Spur gear - precision
range, Pre-hardened
Steel 35NCD6

Complementary products



VAP

Magnetic stud with
central hole, With
central hole



PLC_PLT

Magnetic stud with
central hole, With
central hole