



# Handle

## For use in high temperatures up to 250°C PHT<sub>SS</sub>

- **Heavy-duty handle, resists high temperatures**
- Working temperature:
  - Continuous operation: max + 150/160°C
  - Occasional use: + 250°C max
- Material:
  - Thermoplastic PPA, glass-fibre reinforced, black finish
  - Threaded insert: stainless steel

### Applications

- This handle is larger than most and has an ergonomic design.
- Easy to clean thanks to a closed and smooth design.
- For use in the food or medical industries.

### Mounting

- Rear mounting



**150°C**  
Continuously



**250°C**  
For short periods

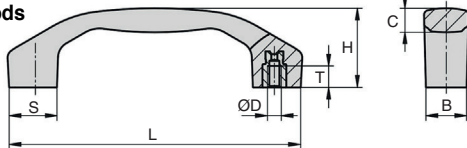
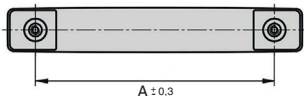

### DISCOUNTS

Qty	1+	6+	20+	50+
Disc. Net	-5%	-15%	On request	

Part N°	A	B	C	ØD	H	L	S	T	Charge (N)	Price each
										1 to 5
PHT-100/SS	100	17	10,3	M5	34,0	122,5	20	9	1000	17,10 €
PHT-120/SS	120	21	12,4	M6	41,0	146,0	24	12	1000	20,50 €
PHT-140/SS	140	24	15,4	M8	46,5	170,0	28	12	1000	28,21 €

All dimensions in mm

## Our other products



H0  
90° crossed axis  
helical gear, Machined  
plastic (delrin)



MSP3815  
Masterplate®  
glueable insert,  
rectangular with  
threaded stud



CNA-CNG  
Gas spring, Right  
angled mounting  
plate for clevis



CAP821  
Plate chain, Large  
range 821

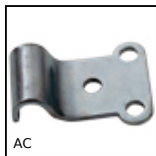

AC  
Catch plate for toggle  
latch, 15mm



PLM-20SC  
Magnetic stud,  
Cylindrical magnet



HRV  
V- rail guidance  
system, Rail with  
carriage



T5P\_T10P  
Connecting plate, T10



CHML40  
Worm and wheel  
gearbox, up to 57 Nm  
- Integrated torque  
limiter



PFM  
Pressed steel foot,  
Flanged plate



ACLBTS  
Closing system,  
Spacer for spherical  
ended stop



PXHG2  
Crossed helical gear -  
precision range,  
20NCD2 case  
hardened steel

## Complementary products



PO  
Housing handle - Multi-  
sector, Tapped  
recessed insert



PHT  
Carrying handle, Up to  
250 °C



PGM52-M4  
Carrying handle,  
Aluminium



PGMT  
Carrying handle, Steel