

# Carrying handle

PGM

Aluminium or brass

- Gripping handle for both pushing and pulling

- Rear mounting

- Materials:

Aluminium, natural finish

Aluminium, polished

Chromed brass

Nickel plated brass

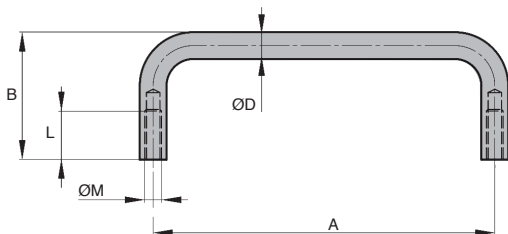
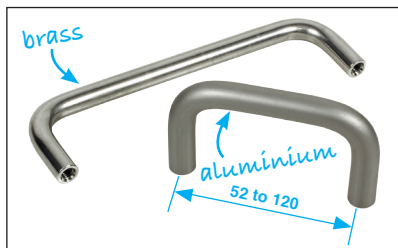

## DISCOUNTS

Qty	1+	6+	20+	50+
Disc. List	-5%	-15%	On request	

Part number	Material	Finish	A	B	ØD	L	ØM	Weight (g)	Stock*	Price each 1 to 5
PGM52-M4/ALA	aluminium anodized, natural	natural	52	34	8	10	M4	14	✓	7,19 €
PGM80-M4/ALA	aluminium anodized, natural	natural	80	34	8	12	M4	17	-	8,02 €
PGM100-M4/ALP	aluminium	polished	100	30	7	8	M4	14	✓	4,33 €
PGM100-M4/ALA	aluminium anodized, natural	natural	100	34	8	12	M4	20	✓	8,47 €
PGM100-M4/BRC	brass	chromed	100	30	7	8	M4	44	✓	6,65 €
PGM100-M4/BRN	brass	nickel plated	100	30	7	8	M4	44	-	6,56 €
PGM120-M4/ALA	aluminium anodized, natural	natural	120	34	8	10	M4	23	✓	9,01 €

Dimensions in mm

HPC

WEB  
04/2019

www.hpceurope.com

Tél: 0 825 88 5000 Service 0,15 €/min + prix appel

## Our other products



ETGamme  
Extension springs  
DIN2097, DIN 2097

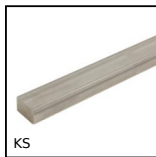

KS  
Keysteel, Stainless  
steel - Keystock



MEB  
Moulded plastic bevel  
gear (nylon), 1:1



HTD14M\_85  
HTD Heavy duty  
timing pulley, HTD14  
Steel



PSG125  
Spur gear - precision  
range, Case hardened  
steel 20NCD2



D-PAR\_SS  
Stainless steel elasto  
mount, stainless steel



H0  
Crossed helical gear  
crossed axis at 90°,  
Steel 20NCD2



BSM\_LOK  
Long-Lok spring  
plunger with internal  
hexagonal socket,  
LONG-LOK - s...

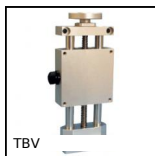

TBV  
Manual lifting tables,  
3kg

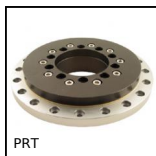

PRT  
Rotary table iglidur®,  
Iglidur®, aluminium  
and stainless steel



BLH50  
Right angled gearbox,  
from 7.70 to 20 Nm



HTD5M\_15  
HTD Heavy duty  
timing pulley, HTD5  
Aluminium

## Complementary products



PGM52-M4  
Pull handle, Brass



PGM55  
Stainless steel pull  
handle, Stainless steel



PO  
Pull handle - Multi-  
sector, Tapped  
recessed insert



PGM86-M5  
Pull handle,  
Thermoplastic