

Spring plunger

New

PDD

With adaptor for sensor

- **Spring plunger with sensor adaptor**
- specially designed for flush fitting inductive proximity sensors.
- Robust, compact design with fine pitch thread
- Switching point is adjusted via the position of the sensor
- Sensitivity of switching point can be adjusted over the entire stroke.

- Materials:

Body and pin: Stainless steel 1.4305

Spring: Stainless steel

Nut: Nickel plated brass (ISO 4035)

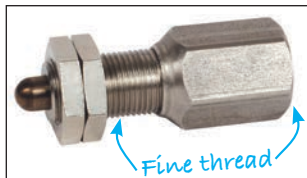

Application

- Positioning with built in position detection

Info

- Detector not supplied

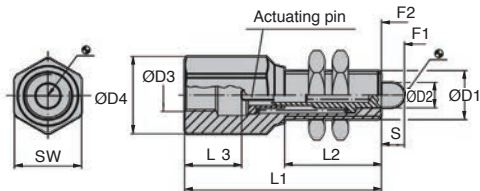

Typical application

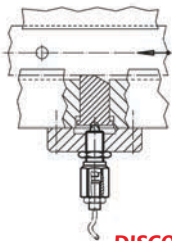

DISCOUNTS

| | | | | |
|-------|------|-----|------|------------|
| Qty | 1+ | 6+ | 20+ | 50+ |
| Disc. | List | -5% | -10% | On request |

| Part number | ØD1 | ØD2 | ØD3 | ØD4 | L1 | L2 | L3 | S | SW | Pressure F1(N) | Pressure F2(N) | Weight (g) | Price each 1 to 5 |
|---------------|-------|-----|-------|------|----|----|------|-----|----|-------------------|-------------------|---------------|----------------------|
| PDD-M12C-M8C | M12x1 | 6,2 | M8x1 | 19 | 44 | 20 | 15,5 | 5,6 | 17 | 24 | 41,5 | 57 | 48,67 € |
| PDD-M16C-M12C | M16x1 | 8,5 | M12x1 | 21,5 | 65 | 32 | 20 | 7,5 | 19 | 32,5 | 65,5 | 103 | 58,81 € |

Dimensions in mm

- An actuating plunger suitable for use with a rear mounted detector
- Can be used with any type of detector
- Materials:
 - Body: Burnished steel
 - Spring: Stainless steel
 - Nut: Blackened steel (ISO 4035)
 - Detector shaft: Black nitride steel



Application

- Plunger for use in tools where detection is required

Info

- Detector not supplied



Typical application

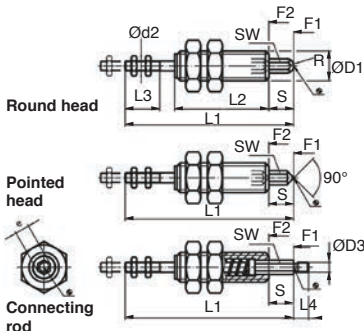

DISCOUNTS

| Qty | 1+ | 6+ | 20+ | 50+ |
|-------|------|-----|------|------------|
| Disc. | List | -5% | -10% | On request |

| Part number | ØD1 | S | ØD2 | ØD3 | E | L1 | L2 | L3 | L4 | R | SW | Pressure | | Weight (g) | Price each |
|-----------------------------------|-----|----|------|------|-----|----|----|----|----|------|----|----------|-------|------------|------------|
| | | | | | | | | | | | | F1(N) | F2(N) | | |
| With round headed end | | | | | | | | | | | | | | | |
| PDD-M8-R | M8 | 6 | M2,5 | - | 3,5 | 50 | 32 | 9 | - | 1,75 | 3 | 4,1 | 7,6 | 15 | 26,28 € |
| PDD-M10-R | M10 | 8 | M3 | - | 4,6 | 59 | 35 | 11 | - | 2,3 | 4 | 5 | 9 | 28 | 26,93 € |
| PDD-M12-R | M12 | 10 | M4 | - | 5,8 | 68 | 38 | 14 | - | 2,9 | 5 | 5,1 | 11 | 44 | 27,99 € |
| PDD-M16-R | M16 | 12 | M5 | - | 6,9 | 78 | 42 | 16 | - | 3,5 | 6 | 7,5 | 13,8 | 87 | 36,11 € |
| With pointed end | | | | | | | | | | | | | | | |
| PDD-M8-P | M8 | 6 | M2,5 | - | 3,5 | 50 | 32 | 9 | - | - | 3 | 4,1 | 7,6 | 14 | 26,28 € |
| PDD-M10-P | M10 | 8 | M3 | - | 4,6 | 59 | 35 | 11 | - | - | 4 | 5 | 9 | 29 | 26,93 € |
| PDD-M12-P | M12 | 10 | M4 | - | 5,8 | 68 | 38 | 14 | - | - | 5 | 5,1 | 11 | 44 | 27,99 € |
| PDD-M16-P | M16 | 12 | M5 | - | 6,9 | 78 | 42 | 16 | - | - | 6 | 7,5 | 13,8 | 88 | 36,11 € |
| With a threaded connection | | | | | | | | | | | | | | | |
| PDD-M8-F | M8 | 6 | M2,5 | M2,5 | 3,5 | 50 | 32 | 9 | 4 | - | 3 | 4,1 | 7,6 | 15 | 26,28 € |
| PDD-M10-F | M10 | 8 | M3 | M3 | 4,6 | 59 | 35 | 11 | 5 | - | 4 | 5 | 9 | 29 | 26,93 € |
| PDD-M12-F | M12 | 10 | M4 | M4 | 5,8 | 68 | 38 | 14 | 6 | - | 5 | 5,1 | 11 | 44 | 27,99 € |
| PDD-M16-F | M16 | 12 | M5 | M5 | 6,9 | 78 | 42 | 16 | 7 | - | 6 | 7,5 | 13,8 | 89 | 36,11 € |

Dimensions in mm

Our other products



BAGtr
Lead screw clamping collar, Aluminium



CNA-CNG
Right angled mounting plate, Right angled mounting plate for ball jo...



BSB
Ballscrew bearing unit, Support



CHA35
Hinge for aluminium profile, Hinge



LRR-53
Spring loaded latch, Spring return latch - steel



BFM
Flanged bronze nut, Bronze - 1 thread



PR40
Articulated foot Ø50, Ø 50



GTC
Belt tensioner, For standard applications



SH2
Parallel axis helical gear, Steel 20NCD2



HLU
Spoked handwheel without handle, Aluminium



RPCplss
Swivel castor with plate, Stainless steel - Polyamide



PRF-SCL
Lock for aluminium profile, Lock for sliding doors

Complementary products



PDD
Spring plunger, With sensor adaptor