

C45 steel

Pitch 1/4"

Economy range



- Pitch 1/4" (6,35mm)
- Roller diameter 3,3mm
- Material:
C45 UNI7845 steel
- **HPC are unable to modify these parts**
- **The prebore dimensions are given as a guide only and are subject to change

Accessories

- Chain part number **SUA-250/M**

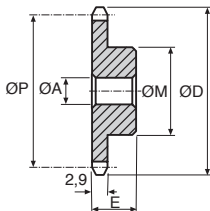

DISCOUNTS

Qty	1+	6+	20+	40+
Disc.	List	-12%	-25%	On request

Part number	Z teeth	ØP	ØD	ØM	ØA**	E	Weight (kg)	Price each
PCS25-8	8	16,58	19,4	10	6	12	0,01	2,01 €
PCS25-9	9	18,56	21,4	11,5	6	12	0,01	2,14 €
PCS25-10	10	20,55	23,3	13	6	12	0,02	2,18 €
PCS25-11	11	22,54	25,3	15	8	13	0,02	2,22 €
PCS25-12	12	24,53	27,3	17	8	13	0,02	2,22 €
PCS25-13	13	26,53	29,3	17	8	13	0,03	2,60 €
PCS25-14	14	28,53	31,3	17	8	13	0,03	2,72 €
PCS25-15	15	30,53	33,3	20	8	13	0,04	3,06 €
PCS25-16	16	32,55	35,3	22	8	14	0,05	3,40 €
PCS25-17	17	34,55	37,3	22	8	14	0,05	4,07 €
PCS25-18	18	36,56	39,4	25	8	14	0,06	4,45 €
PCS25-19	19	38,58	41,4	25	8	14	0,06	4,79 €
PCS25-20	20	40,58	43,4	25	8	14	0,06	4,92 €
PCS25-21	21	42,60	45,4	30	8	14	0,08	5,30 €
PCS25-25	25	50,66	53,5	30	8	14	0,10	6,98 €
PCS25-28	28	56,71	59,5	30	8	16	0,12	8,50 €
PCS25-29	29	58,73	61,5	30	8	16	0,12	9,00 €
PCS25-30	30	60,75	63,6	30	8	16	0,13	9,13 €
PCS25-32	32	64,78	67,6	30	8	16	0,13	10,56 €
PCS25-33	33	66,80	69,6	30	8	16	0,14	11,06 €
PCS25-34	34	68,82	71,6	30	8	16	0,17	11,19 €
PCS25-35	35	70,84	73,6	30	8	16	0,17	11,70 €
PCS25-36	36	72,85	75,6	30	8	16	0,15	12,20 €
PCS25-37	37	74,87	77,7	30	8	16	0,18	14,30 €
PCS25-38	38	76,89	79,7	30	8	16	0,16	15,78 €
PCS25-39	39	78,91	81,7	30	8	16	0,19	17,22 €
PCS25-40	40	80,93	83,7	30	8	16	0,17	18,77 €

Dimensions in mm

0 825 88 6000
Service 0,15 € / min
+ prix appel

Our other products



ZBconique

Machined plastic
bevel gear, 1:1



CQA30

Accessory for
adjustment slide-
system, 30

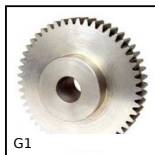

G1

Steel spur gear, Steel
20NCD2



MLY_SS

Stainless steel bow
shackle with eye bolt,
Stainless steel



HLA19

Right angle spiro
bevel gearbox, Up to
43Nm



CHM63

Worm and wheel gear
reducer, up to 196
Nm



BKGS

Backlash free
coupling Gerwah®,
from 1.2 to 450Nm



SRG

Adjustable latch
clamp with strike
plate, Stroke from
117,4mm to 128mm



HBM

Adjustment bushing
for half-rail guide,

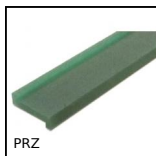

PRZ

Wear strip for slat top
chain, Z profile to be



PCLA_T

Technopolymer
clamping lever - male,



DIA

Ring operated locking
bolt, with ring

Complementary products



SUA4

Single chain supplied
by the metre, Steel



SUA4_L

Chain link, Steel