

# Fixed cylindrical handle

## PCM

## Black Duroplast

- Fixed non-turning handle

- Material:

Black Duroplast

### Advantages

- Good grip

- Easier to clean than technopolymer alternatives

- No retention of swarf in a machining environment.

Good resistance

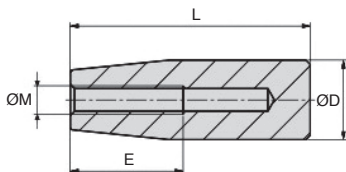

### DISCOUNTS

Qty	1+	6+	20+	50+	100+	250+
Disc.	List	-5%	-10%	-15%	-20%	On request

Part number	ØM	ØD	L	E	Weight (g)	Stock*	Price each 1 to 5
PCM5-13-27	M5	13	27	14	4	✓	2,40 €
PCM6-13-27	M6	13	27	14	4	-	2,40 €
PCM6-17-40	M6	17	40	20	9	✓	2,40 €
PCM8-17-40	M8	17	40	25	8	✓	2,40 €
PCM6-21-50	M6	21	50	25	20	✓	2,99 €
PCM8-21-50	M8	21	50	25	19	-	2,99 €
PCM10-21-50	M10	21	50	25	18	✓	2,99 €
PCM6-23-55	M6	23	55	25	25	-	3,27 €
PCM8-23-55	M8	23	55	25	24	-	3,27 €
PCM10-23-55	M10	23	55	25	24	-	3,27 €
PCM8-25-65	M8	25	65	30	36	✓	3,48 €
PCM10-25-65	M10	25	65	30	35	✓	3,48 €
PCM12-25-65	M12	25	65	30	34	✓	3,48 €
PCM8-28-85	M8	28	85	40	61	✓	4,52 €
PCM10-28-85	M10	28	85	40	59	-	4,52 €
PCM12-28-85	M12	28	85	40	56	-	4,52 €
PCM14-28-85	M14	28	85	40	52	✓	4,52 €
PCM8-29-115	M8	29	115	40	92	-	7,76 €
PCM10-29-115	M10	29	115	40	88	✓	7,76 €
PCM12-29-115	M12	29	115	40	84	✓	7,76 €

Dimensions in mm

## Our other products



BCTH

Mushroom headed button Hygienic Usit®, With female thread and high ...



DB

Steel bevel gear, 2:1



ZG1

Plastic spur gear, Machined plastic (delrin)



EHD12

Internal epicyclic servo reducers, from 60 to 140 Nm

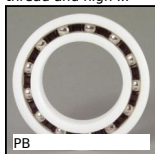

PB

Plastic deep groove ball bearing, Plastic - balls material : staine...



BOX-TOR-MAX

Box set of Nitrile O-rings in nitrile, 2.90 x 1.78mm to 82.14 x 3.53



NCT

Square tube connector, Fixed angle



MDB\_MTB

Moulded plastic bevel gear (nylon), 3:1



EMS

Stainless steel knurled thumb nut, Knurled

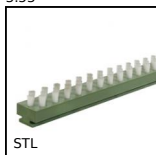

STL

Guidance brush - Brush, Brush



PPC<sub>ss</sub>

Pad eye on mounting plate squarred,



DBL821

Idler for slat top chain, Range 821

## Complementary products



LPCM

Lever with cylindrical handle, Black Duroplast, steel lever