

Fixed cylindrical handle

PCM

Black Duroplast

- Fixed non-turning handle

- Material:

Black Duroplast

Advantages

- Good grip

- Easier to clean than technopolymer alternatives

- No retention of swarf in a machining environment.

Good resistance

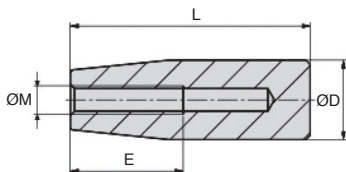

DISCOUNTS

Qty	1+	6+	20+	50+	100+	250+
Disc.	List	-5%	-10%	-15%	-20%	On request

Part number	ØM	ØD	L	E	Weight (g)	Stock*	Price each 1 to 5
PCM5-13-27	M5	13	27	14	4	✓	2,40 €
PCM6-13-27	M6	13	27	14	4	-	2,40 €
PCM6-17-40	M6	17	40	20	9	✓	2,40 €
PCM8-17-40	M8	17	40	25	8	✓	2,40 €
PCM6-21-50	M6	21	50	25	20	✓	2,99 €
PCM8-21-50	M8	21	50	25	19	-	2,99 €
PCM10-21-50	M10	21	50	25	18	✓	2,99 €
PCM6-23-55	M6	23	55	25	25	-	3,27 €
PCM8-23-55	M8	23	55	25	24	-	3,27 €
PCM10-23-55	M10	23	55	25	24	-	3,27 €
PCM8-25-65	M8	25	65	30	36	✓	3,48 €
PCM10-25-65	M10	25	65	30	35	✓	3,48 €
PCM12-25-65	M12	25	65	30	34	✓	3,48 €
PCM8-28-85	M8	28	85	40	61	✓	4,52 €
PCM10-28-85	M10	28	85	40	59	-	4,52 €
PCM12-28-85	M12	28	85	40	56	-	4,52 €
PCM14-28-85	M14	28	85	40	52	✓	4,52 €
PCM8-29-115	M8	29	115	40	92	-	7,76 €
PCM10-29-115	M10	29	115	40	88	✓	7,76 €
PCM12-29-115	M12	29	115	40	84	✓	7,76 €

Dimensions in mm

Our other products



H1

Crossed helical gear
crossed axis at 90°,
Steel 20NCD2



PSG05

Spur gear - precision
range, Pre-hardened
Steel 35NCD6



BPM

Slotted spring plunger
with ball tip, Steel



HTD8M-BAR

HTD type tooth bar
stock, HTD8



GP75

Spring loaded toggle
latch, Standard
(GP75)



GG1

Ground spur gear,
Heat treated steel



PCP

Cell carrier assembly,
Ready assembled



BPTR

End cap for round
tube, Standard



CMM_SS

Male rod ends DIN
ISO12240-4, Stainless
steel / bronze -



PCF2

Conical flexible
mount, Oval base
plate



PRS50

Stainless steel
articulated foot Ø50,
Ø 50

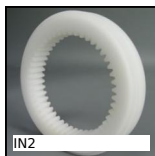

IN2

Internal gear,
Machined plastic
(delrin)

Complementary products



LPCM

Lever with cylindrical
handle, Black
Duroplast, steel lever