

Universal 90° support clamp

Sta Stock

NSU

Easy to mount and adjust

- Support clamp with adjustable head
- Head can be adjusted by loosening and then tightening countersunk screw before assembly
- Material:
stainless steel

Application

- Supporting sensors, connecting tubes when assembling small structures

Accessories

- To be used with **MBF** sleeves and **APBC** rods

stainless steel



Suitable for food industry use

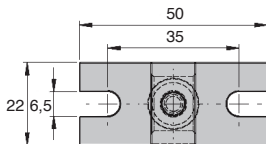
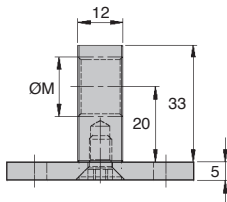

DISCOUNTS

Qty	1+	5+	10+	20+
Disc.	List	-5%	-10%	On request

Part number	For rod ØA	Thread ØM	Used with sleeve	Stock*	Price each 1 to 4
NSU8-12	8	M12x1,5	MBF8-12	✓	13,27 €
NSU10-14	10	M14x1,5	MBF10-14	✓	13,46 €
NSU12-16	12	M16x1,5	MBF12-16	✓	13,65 €

*Depending on availability - Dimensions in mm

HPC

WEB
04/2020

www.hpceurope.com

Tél: 0 825 88 5000 Service 0,15 €/min + prix appel

Our other products



CHINV

Invisible hinge,
Invisible - Opening up to 90°



PTA80

Articulated levelling
foot, pressed base
Ø80, Ø 80



DKONSL

Silicone conical elasto
buffer, Male mounting



GLT2-17

Telescopic drawer
runners for groove
mounting, Partial
extension



PRF_PIV

Internal hinge pin for
aluminium profile,
Internal hinge pin



LVT

Miniature motorised
actuator 1A, 1 amper



ETGamme

Extension springs
DIN2097, DIN 2097



LVT

Miniature motorised
actuator 1A, 1 amper



BLM

Spring loaded plunger
with ball tip, Stainless
steel body



CHAE3030PA

Square decorative
screwed hinges,
Polyamide



PLM-20SC

Threaded cylindrical
magnet, With
threaded hole



MCLred

Reducing sleeve
female/female,
Cylindrical - steel

Complementary products



MBF

Threaded blocking
clamp, Threaded
locking clamp



APBC

Circular rod, Round
rod