

Universal 90° support clamp

Sta Stock

NSU

Easy to mount and adjust

- Support clamp with adjustable head
- Head can be adjusted by loosening and then tightening countersunk screw before assembly
- Material:
stainless steel

Application

- Supporting sensors, connecting tubes when assembling small structures

Accessories

- To be used with **MBF** sleeves and **APBC** rods

stainless steel



Suitable for food industry use

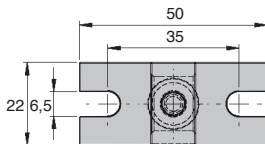
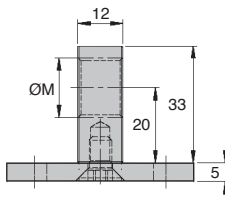

DISCOUNTS

Qty	1+	5+	10+	20+
Disc.	List	-5%	-10%	On request

Part number	For rod ØA	Thread ØM	Used with sleeve	Stock*	Price each 1 to 4
NSU8-12	8	M12x1,5	MBF8-12	✓	13,27 €
NSU10-14	10	M14x1,5	MBF10-14	✓	13,46 €
NSU12-16	12	M16x1,5	MBF12-16	✓	13,65 €

*Depending on availability - Dimensions in mm

Our other products



GG2
Ground spur gear,
Heat treated steel



V3RA
3-spoked handwheel
without handle,
Polyamide



NTMbr
Set screw brass tip,
Brass-point



BLHB30
Right angled gearbox,
bored shafts, up to
4.4 Nm



MBF
Threaded blocking
clamp, Threaded
locking clamp



BSCm
Knurled torque knob
- male, Knurled
threaded torque



AC156-157
Strike for toggle latch,
25.5mm



PHTss
Pull handle, Up to 250
°C



GPBSS
Threaded spherical
knob, Aluminium



SSE
Stainless steel
spherical bearing,



MSP3815
Masterplate®
glueable insert



ERC
Quick fitting cable
terminal, Fork

Complementary products

tapped i...



MBF
Threaded blocking
clamp, Threaded
locking clamp



APBC
Circular rod, Round
rod