

Housing for open linear bearing **Alu** **Stock**

NSO For KB-OP and TK-OP bearings

- Open housing for open bearing
- Bearing not supplied
- Material:
Aluminium
- Circlips used for assembly

Options

- Compatible with KB-OP and TK-OP ranges

Advantages

- Use with long supported shafts to avoid flexing.

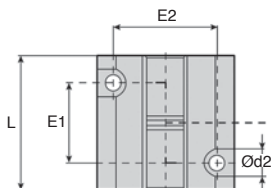
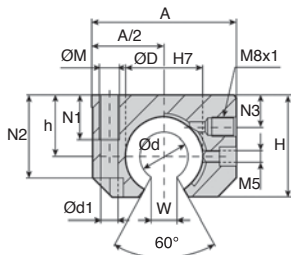

DISCOUNTS

Qty	1+	5+	10+	25+
Disc.	List	-6%	-12%	On request

Part number	For shaft Ød	ØD	H	h	A	L	E1	E2	N1
NSO12	12	22	28	18	43	39	23	32	11
NSO16	16	26	35	22	53	43	26	40	13
NSO20	20	32	42	25	60	54	32	45	18
NSO25	25	40	51	30	78	67	40	60	22
NSO30	30	47	60	35	87	79	45	68	22
NSO40	40	62	77	45	108	91	58	86	26

Part number	N2	N3	Ød1	Ød2	ØM	W	Masse (g)	Stock*	Price each 1 to 4
NSO12	23,5	8	4,2	8	M5	7,0	110	✓	58,38 €
NSO16	30,0	12	5,2	10	M6	9,4	170	✓	60,45 €
NSO20	34,0	13	6,8	11	M8	10,2	300	✓	66,72 €
NSO25	40,0	15	8,6	15	M10	12,5	570	✓	80,26 €
NSO30	48,0	16	8,6	15	M10	13,9	860	✓	94,89 €
NSO40	60,0	20	10,3	18	M12	18,0	1600	✓	159,57 €

*Depending on availability - Dimensions in mm

Our other products

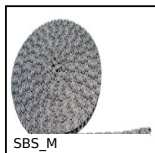

SBS_M
Single chain supplied by the metre, Stainless steel



UCF_SS
Stainless steel flanged bearing, Stainless steel



S20
Short housing for open linear bearing, Opened - slim



CHM30-MOT
Asynchronous AC motorgearboxes 0.09 to 0.22kW, 0.09 to 0.22kW



BPPE
Ball transfer unit push fit, Light



RBNpl
Fixed castor with plate, Steel - rubber



SLH
Horizontal toggle clamp, Horizontal Lever Clamp - steel



HRV
V- rail guidance Simple Select® system, Rail with carriage



BABTV
Ball lock pins lockable, Stainless steel



GE
Toggle latches, Standard

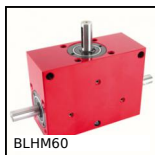

BLHM60
Right angled gearbox, double output shafts, up to 70 Nm



CHA225
Screwed hinge with threaded insert, 225 degrees

Complementary products



KB_OP
Open precision linear bearing, Precision - steel

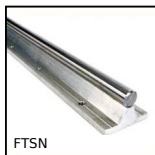

FTSN
Supported shaft for linear guide, Steel shaft / Aluminium support



S20
Short housing for open linear bearing, Opened - slim