

Standard linear bearing housing **Alu** **Stock**

NSB For KB, TK and RJUM bearings

- Housing for closed bearing
- Bearing not supplied
- Material : Aluminium

Options

- Compatible with KB, TK and RJUM ranges

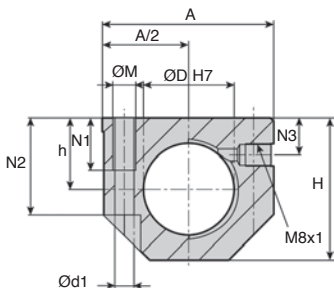
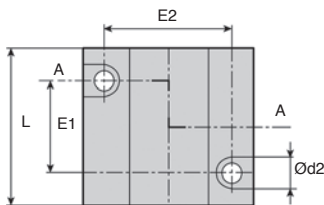

DISCOUNTS

Qty	1+	5+	10+	25+
Disc.	List	-6%	-12%	On request

Part number	For shaft		H	h		L				E1	E2	Ød1	Ød2	ØM	Stock*	Price each 1 to 4
	Ød	ØD		+0.01/-0.02	A	+0.3	N1	N2	N3							
NSB12	12	22	35	18	43	39	13	25	10	23	32	4,2	8	M5	✓	38,55 €
NSB16	16	26	42	22	53	43	13	30	12	26	40	5,2	10	M6	✓	43,77 €
NSB20	20	32	50	25	60	54	18	34	13	32	45	6,8	11	M8	✓	47,94 €
NSB25	25	40	60	30	78	67	22	40	15	40	60	8,6	15	M10	✓	60,45 €
NSB30	30	47	70	35	87	79	22	48	16	45	68	8,6	15	M10	✓	69,87 €

*Depending on availability - Dimensions in mm

Our other products



DOMI80

Connecting kits, XY linking kit



CHTRB

Single and dual output gearboxes, Up to 4,7 Nm



CHA_GC_95S

Stainless steel garnet hinge, To be welded



MCL

Cylindrical threaded sleeve, Cylindrical - steel

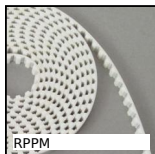

RPPM

RPP type belt per metre, RPP5 Steel cored polyurethane



SLH-M

Nut for toggle clamp, Round ended nut for SLH/SLV clamp



SHN

Hexagonal nut, DIN934, A2 Stainless steel



T10courroie

T type timing belt, T10 Steel cored polyurethane



IBJ

180° ball and socket joints, Steel



DOMI120

Accessories, Turntable



PFM

Fixed levelling foot, Flanged plate



VELM4

Screw-on base for hook-and-loop strip, Polyamide

Complementary products



KB_UU

Closed linear precision bearing, Precision - steel



TK

Topball self-aligning linear bearing, Topball self-aligning



ZB

Shaft for linear guides, Hardened ground stainless steel

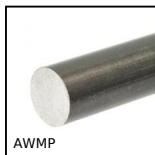

AWMP

Aluminium shaft for linear guide, Aluminium