

- For $\text{Ø}14$ to $\text{Ø}20$ round tube
- Materials:
Body: reinforced polyamide
Screws: stainless steel

Info.

- Not sold individually, please contact us for details

Accessories

- APB-F and APB-T adjusting rods

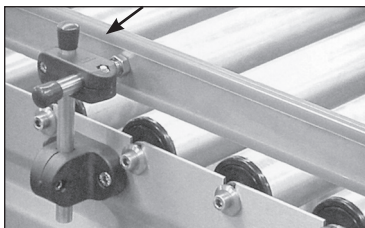
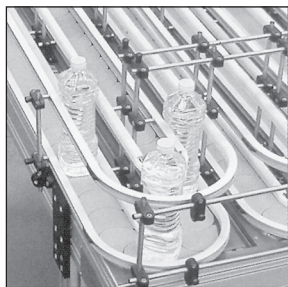
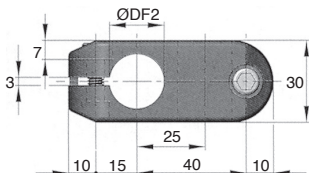
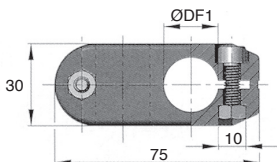
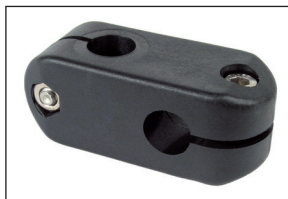

↑
← Typical applications

DISCOUNTS

Qty	1+	30+	40+	60+
Disc.	List	-5%	-10%	On request

Part number	ØDF1	ØDF2	Weight (kg)	Stock*	Price each 1 to 29
NPTR14-14	14	14	0,07	✓	6,45 €
NPTR14-15	14	15	0,07	-	6,45 €
NPTR14-16	14	16	0,07	-	6,45 €
NPTR15-15	15	15	0,07	-	6,45 €
NPTR15-16	15	16	0,07	-	6,45 €
NPTR16-16	16	16	0,07	✓	6,45 €
NPTR18-18	18	18	0,07	✓	6,45 €
NPTR20-20	20	20	0,07	✓	6,45 €

*Depending on availability - Dimensions in mm

Our other products



PM3

Worm and wheel set,
Bronze



SCA

Flat cable clamp,
Steel



PTAF100-PAMF100

Articulated fixable
foot with pressed
base Ø100, Ø 100



PRF3232

Standard aluminium
profile, 32 x 32 mm



AC

Strike for toggle latch,
12,13,18 and 20mm

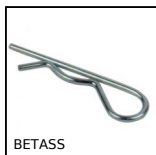

BETASS

Hitch pin, Hitch



ACLCHARJ

Hinge for aluminium
profile, Adjusts in 2
directions



PTA80

Articulated levelling
foot, pressed base
Ø80, Ø 80



HLA28

Right angle spiro
bevel gearbox, Up to
182Nm



PRF_T

Corner reinforcement,
Corner reinforcement



UGH50

H Type Guide units,
For Ø50 actuators



PSPE22

Conical flexible shaft
handle Ø22, Black
PVC

Complementary products



APB_F

Adjusting rod for
clamp - Male,
Threaded



APB_T

Adjusting rod for
clamp - Female, Bored



NSA

Adjustable clamp,
Articulated