

Fixed tube carrier



NPTF20

For Ø10 to Ø14 tubes

- For round or square tubes

- Materials:

Body: reinforced polyamide

Screws: stainless steel

Info.

- Not sold individually, please contact us for details

Detail X

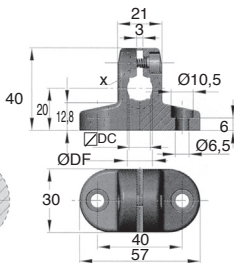
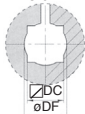

DISCOUNTS

Qty	1+	30+	40+	60+
Disc. List	-5%	-10%	On request	

Part number	Ø DF	∅ DC	Weight (kg)	Stock*	Price each 1 to 29
NPTF20-10	10	8	0,03	✓	5,64 €
NPTF20-12	12	10	0,03	✓	5,64 €
NPTF20-14	14	12	0,03	✓	6,26 €

*Depending on availability - Dimensions in mm

NPTF20 ENT

Spacer for tube carrier

Plastic

- Material: reinforced polyamide

Info.

- Not sold individually, please contact us for details

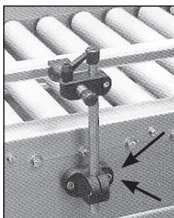

Typical application

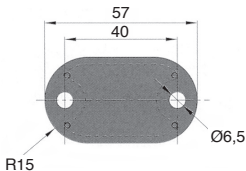

DISCOUNTS

Qty	1+	30+	40+	60+
Disc. List	-5%	-10%	On request	

Part number	H	Weight (kg)	Stock*	Price each 1 to 29
NPTF20-ENT4	4	0,01	✓	2,98 €
NPTF20-ENT6	6	0,02	✓	2,98 €

*Depending on availability - Dimensions in mm

Our other products



PW_PWG2
Worm - precision range, Steel



RESC
Retractable castor for aluminium profile, Retractable castor



WJRM
Drylin® W hybrid bearing block, Hybrid bearings



AT10-50ECO
AT type timing pulley, Economy range - AT10 aluminium



SH2
Parallel axis helical gear, Machined plastic (delrin)



PCLA_M
Technopolymer clamping lever - female, Plastic



PRF_ROUL
Castor for aluminium profile, No brake



VRBS
Folding lifting ring for welding, Folding - for welding



BSM_LOK
Long-Lok spring plunger with internal hexagonal socket,



MSP19
Masterplate® glueable insert Ø19, Cylindrical with



RJUM01
Closed polymer Drylin® R bearing, Drylin® R



PLM-16A
Magnetic stud with threaded hole, With threaded hole

Complementary products



NPTF20
Spacer for tube carrier, Fixing accessory Ø10 to Ø14



APB_T
Adjusting rod for clamp - Female, Bored