

# Combined bearing in steel

## NKXR

With needles and  
cylindrical roller thrust bearing  
without internal ring

- Combined bearing to support radial and axial loads
- Supplied without internal ring: the shaft will be used as a bearing race, and will therefore have to be hardened and rectified.
- Bearing with protective cap
- Materials:  
Steel  
Plastic stopper

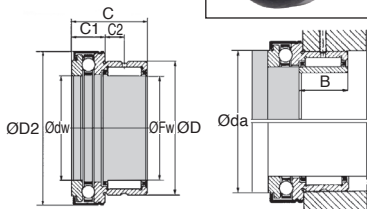

Mounting dimensions

**DISCOUNTS**

Qty	1+	4+	8+
Disc.	List -15%	On request	

### Info.

- In the case of grease lubrication, maximum speed equivalent to 60% of the values in the table.

<sup>(1)</sup> Axial load  $F_a$  from 1 to 2 % of the dynamic load coefficient C (axial)

Part number	Ød	Radial load (N)		Axial load <sup>(1)</sup> (N)		Speed (rpm) lubrication oil	Weight (g)
		Dynamic (C)	Static (Co)	Dynamic (C)	Static (Co)		
NKX12Z	12	8500	10500	10000	15000	11000	40
NKX15Z	15	10000	12000	10000	16000	9500	47
NKX17Z	17	11000	14500	10500	17900	8500	55
NKX20Z	20	15000	2500	13500	23000	7500	90
NKX25Z	25	17000	30000	18000	35000	6000	132
NKX30Z	30	21000	34000	19000	39500	5000	148
NKX35Z	35	23000	40000	20500	44650	4600	168
NKX40Z	40	25000	45000	26000	60000	4000	208
NKX45Z	45	26500	51000	27000	67000	3600	265
NKX50Z	50	36000	72000	28000	72000	3300	300

Part number	ØFw	ØD	ØD2 max	C -0,25	C1 -0,2	C2	Ødw	Øda	Stock*	Price each
										1 to 3
NKX12Z	12	21	27,2	23	9	6,5	12	21,7		30,54 □
NKX15Z	15	24	29,2	23	9	6,5	15	23,7		31,29 □
NKX17Z	17	26	31,2	25	9	8,0	17	25,7		33,10 □
NKX20Z	20	30	36,2	30	10	10,5	20	30,7		38,48 □
NKX25Z	25	37	43,2	30	11	9,5	25	37,7		43,72 □
NKX30Z	30	42	48,2	30	11	9,5	30	42,7		55,97 □
NKX35Z	35	47	53,2	30	12	9,0	35	47,7		65,18 □
NKX40Z	40	52	61,2	32	13	10,0	40	55,7		71,17 □
NKX45Z	45	58	66,5	32	14	9,0	45	60,5		82,26 □
NKX50Z	50	62	71,5	35	14	10,0	50	65,5		89,67 □

\*Depending on availability - Dimensions in mm

**HPC**

WEB  
04/2020

www.hpceurope.com

Tél: 0 825 88 5000 Service 0,15 €/min + prix appel

## Our other products



DOMI50

Domino 50 adjustable slide, Slide DOMILINE 50 with counter and handw...



EFSM

Igal® flange bearing, Polymer



INS\_BR

Self tapping brass insert, Brass



WTM

Tightening washer - DIN6340, Steel



UGH32

H Type Guide units, For Ø32 actuators



PTA80

Articulated levelling foot, pressed base Ø80, Ø 80



HW\_HT

Half-rail guide, Rail



MDR

Dee shackle with eye bolt, Steel



ACLEPP

Right angled bracket for aluminium profile,



ZBconique

Machined plastic bevel gear, 1:1



SSB

Stainless steel bevel gear, 1:1



DGSA

Male rod ends, Steel / steel - Economy range

## Complementary products



NKX

Combined bearing without inner ring, Needle and ball bearings



QTR

Tapered roller bearing, Steel

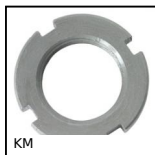

KM

Bearing locknut, Locknut KM



EAR

Bearing locknut, Self locking locknut - nylon lock washer