



Load up to 500N

NK27  
NW27

- Linear rail with polymer slide
- Reduced size (both height and surface)
- Dry working, no maintenance required
- Not affected by dust
- Corrosion-resistant
- Reduced coefficient of friction means wear is reduced
- Reduced weight thanks to use of a combination of aluminium and plastic
- Very high speeds and acceleration possible
- Replaceable sliding parts in iglidur® J
- Materials:
  - Slide body: Zinc
  - Rails: Anodised aluminium
- Symmetrical hole pattern, C5=C6



NS & NW-01



NS & NW-02

Small but effective

## Options

- Rail length up to 3000mm max.

For M4 screw  
DIN 7984 / DIN 6912  
DIN 84 / EN ISO 1707

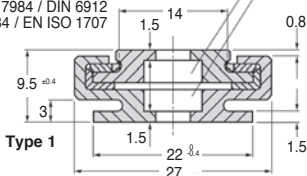

Type 1

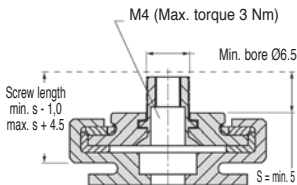

Type 2

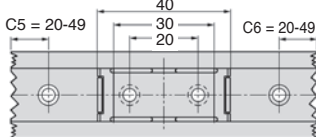

Type 1

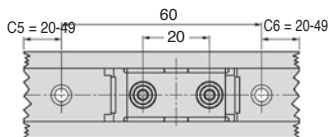

Type 2

## DISCOUNTS

Qty	1+	5+	10+
Disc.	List	-6%	On request

Part number	Type	Weight (g)	Stock*	Price each 1 to 4
NK01-27-1000	1 Rail (1000mm) + 1 slide type 1	300,8	✓	61,50 €
NK02-27-1000	1 Rail (1000mm) + 1 slide type 2	302,5	✓	63,60 €
NW01-27	1 slide type 1 only	10,8	✓	4,78 €
NW02-27	1 slide type 2 only	12,5	✓	6,90 €

\*Depending on availability - Dimensions in mm

## Our other products



NPR

Reflector support,



CAP805

Slat top chain stainless steel, Large range 805



E50

Right angle helical reducers, from 3 to 41 Nm

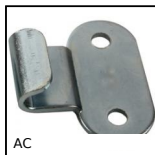

AC

Strike for toggle latch, 20mm



FBL6000\_K13

Brush strip per meter PP fibres Ø0.2, Black striated polypropylene

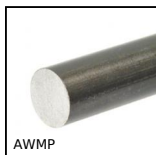

AWMP

Aluminium shaft for linear guide, Aluminium



CLSCLP

Clevis components, short version, Steel - short range



CDP

Flanged drill bushing, Steel



PGMT

Pull handle, Stainless steel



CHA138

Screwed hinge with threaded insert, 138 degrees



PCATHERM

Pull handle, Thermoplastic



KB\_OP

Open precision linear bearing, Precision - steel

## Complementary products



NSKB

Drylin® Rail end cap, Rail end cap