

Variable angle connector



NCTAT

Plastic

- For square tube $\varnothing 25 \times 25 \times 1.5$ mm
- Materials:
Body: reinforced polyamide
Screws: stainless steel

Info.

- Not sold individually, please contact us for details

Accessories

- Structural tube **TUBE**
- Slide profiles **PGT**
- Support profiles **PSP**



Adjustable

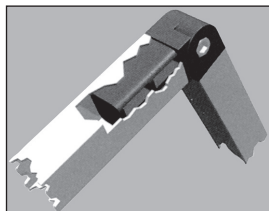

Example of use

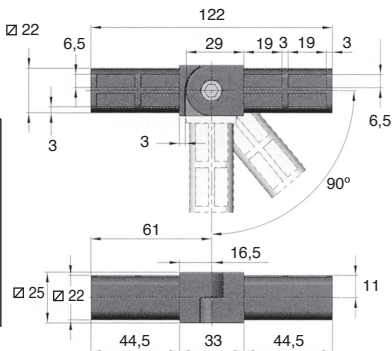

DISCOUNTS

Qty	1+	20+	30+
Disc.	List	-10%	On request

Part number	Weight (kg)	Type	Stock*	Price each 1 to 19
NCT25-25AT	0,12	AT	✓	11,23 €

*Depending on availability - Dimensions in mm

HPC

WEB
04/2020

www.hpceurope.com

Tél: 0 825 88 5000 Service 0,15 €/min + prix appel

Our other products



RT25

Self-centering flanged locking assembly, Medium/high torque



CHM50

Worm and wheel gear reducer, up to 107 Nm



SRG

Adjustable latch clamp with strike plate, Stroke from 78mm to 90mm



TFR

Rigid manual tensioner, Fixed



AT5P_AT10P

Connecting plate for AT type timing belts, AT10



AT10courroie

AT type timing belt, AT10 Steel cored polyurethane



GCA

Linch pin, Linch



RAGFLOW

Floway2® roller track, Roller track



ACL-PLAngle

Joining plate for aluminium profile, Angle connection



DOMI30

Accessories, Plate



CHTRP

Single and dual output gearboxes, Up to 28,8 Nm

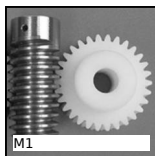

M1

Worm and wheel set, Machined plastic (delrin)

Complementary products



TUBE25_25

Square Tube, Aluminium or Stainless steel



NCT

Square tube connector, Fixed angle



NCT

Square tube connector, Fixed angle



NCT

Square tube connector, Fixed angle