

# Rectangular Master-Plate® glueable insert

316L stainless steel

MSP

- Glueable stainless steel plate with tapped insert or threaded stud
- Material:  
316L stainless steel

## Applications

- Industrial, transport, building, furnishings

## Info.

- Glue not supplied
- Not supplied individually, contact us for details

316L stainless steel



316L stainless steel

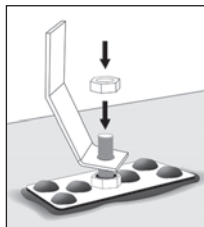
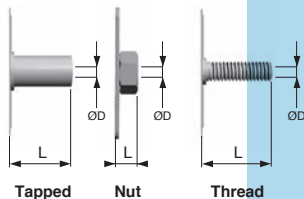
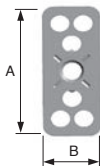

Typical application

## DISCOUNTS

Qty	1+	50+	100+	500+
Disc.	List	-10%	-20%	On request

Part number	A	B	ØD	L	Form	Price each 1 to 49
MSP3815T-6-5/SS	38	15	M6	5	Tapped	5,82 €
MSP3815E-5-4/SS	38	15	M5	4	Nut	2,05 €
MSP3815E-6-5/SS	38	15	M6	5	Nut	2,31 €
MSP3815E-8-6/SS	38	15	M8	6,5	Nut	2,50 €
MSP3815F-5-12/SS	38	15	M5	12	Thread	2,16 €
MSP3815F-5-16/SS	38	15	M5	16	Thread	2,21 €
MSP3815F-6-16/SS	38	15	M6	16	Thread	2,24 €
MSP3815F-6-20/SS	38	15	M6	20	Thread	2,29 €

Dimensions in mm

Fax **0 825 88 6000**  
Service 0,15 € / min  
+ prix appel

cial2@hpceurope.com

**HPC** SUPPLEMENT 2019

81

## Our other products



M0

Worm and wheel set,  
Hardened steel



PRF\_GAL

Roller for aluminium  
profile, Hollow roller  
Ø12



ACLAPA

Magnetic stop for  
aluminium profile,  
Magnetic stop



PSPD18

Flexible tube handle,  
Black PVC

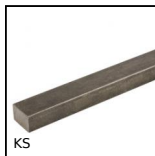

KS

Keysteel, Steel -  
Keystock



LVT

Miniature motorised  
actuator 4A, 4 amperes



NSP

Right angled support  
clamp, Right angled  
support clamp



BAC110

Swivel storage bin,  
Adjustable support

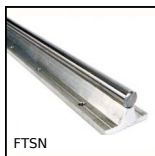

FTSN

Supported shaft for  
linear guide, Steel



HG5-ECO

Eco range Spur gear,  
Steel C45



DOMI80

Accessories, Plate



RAM35

Manual bevel  
gearbox, Bevel

## Complementary products



MSP3815

Masterplate®  
glueable insert  
rectangular,  
rectangular with

tapped i...



MSP38

Masterplate®  
glueable insert Ø38,  
Cylindrical Ø38 with  
threaded s...



MSP23

Masterplate®  
glueable insert Ø23,  
Cylindrical Ø23 with  
threaded s...



MSP3815

Masterplate®  
glueable insert  
rectangular,  
rectangular with nut