

Rectangular Master-Plate® glueable insert

316L stainless steel

MSP

- Glueable stainless steel plate with tapped insert or threaded stud
- Material:
316L stainless steel

Applications

- Industrial, transport, building, furnishings

Info.

- Glue not supplied
- Not supplied individually, contact us for details

316L stainless steel



316L stainless steel

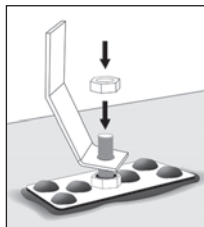
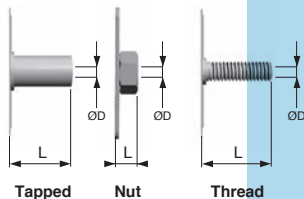
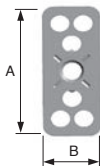

Typical application

DISCOUNTS

Qty	1+	50+	100+	500+
Disc.	List	-10%	-20%	On request

Part number	A	B	ØD	L	Form	Price each 1 to 49
MSP3815T-6-5/SS	38	15	M6	5	Tapped	5,82 €
MSP3815E-5-4/SS	38	15	M5	4	Nut	2,05 €
MSP3815E-6-5/SS	38	15	M6	5	Nut	2,31 €
MSP3815E-8-6/SS	38	15	M8	6,5	Nut	2,50 €
MSP3815F-5-12/SS	38	15	M5	12	Thread	2,16 €
MSP3815F-5-16/SS	38	15	M5	16	Thread	2,21 €
MSP3815F-6-16/SS	38	15	M6	16	Thread	2,24 €
MSP3815F-6-20/SS	38	15	M6	20	Thread	2,29 €

Dimensions in mm

Fax **0 825 88 6000**
Service 0,15 € / min
+ prix appel

cial2@hpceurope.com

HPC SUPPLEMENT 2019

81

Our other products

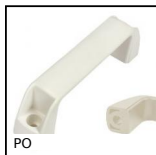

PO

Pull handle - Multi-sector, Smooth hole



DCA

Suction cup, 1.5 bellows, silicon



SCH

Horizontal hook toggle clamp, Horizontal Hook clamp - steel



BWU

Compact precision slide, from 1510 N to 10500 N



PW_PWG15

Wheel - precision range, Bronze



CAP821

Slat top chain acetal, Large range 821

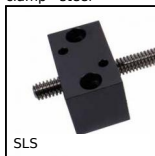

SLS

Bearing block for leadscrew, Fixed Drylin® bearing block



LRM2

Cylindrical bronze nut, Bronze - 2 threads



SCR

Suction cup threaded insert, Insert for suction cup - Socket



RCC_RCX

Spherical tilt washer - DIN6319, concave



BHEX

Hexagonal cap, Black technopolymer



FDSQ

Flexible drive shaft, Masterflex® Steel, with PVC casing

Complementary products



MSP3815

Masterplate® glueable insert rectangular, rectangular with

tapped i...



MSP38

Masterplate®
glueable insert Ø38,
Cylindrical Ø38 with
threaded s...



MSP23

Masterplate®
glueable insert Ø23,
Cylindrical Ø23 with
threaded s...



MSP3815

Masterplate®
glueable insert
rectangular,
rectangular with

threaded...