

Hexagonal spacer



MPE

Steel

- Male/female pillar
- Material: blue steel zinc-plated by electrolysis
- Sold by the packet

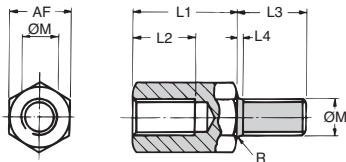
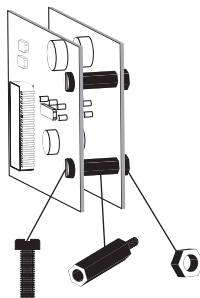

DISCOUNTS

N° packets	1+	5+	20+	100+
Discount	Prix -20%	-30%	On request	

Part number	Thread ØM	L1	L2	L3	L4	AF	R	Qty. per packet	Price per packet
MPE3-5/B	M3	5	3	8	0,90	5	0,10	20	3,88 €
MPE3-8/B	M3	8	4	8	0,90	5	0,10	20	4,95 €
MPE3-10/B	M3	10	6	8	0,90	5	0,10	20	5,32 €
MPE3-12/B	M3	12	8	8	0,90	5	0,10	20	5,39 €
MPE3-15/B	M3	15	8	8	0,90	5	0,10	20	5,56 €
MPE3-18/B	M3	18	8	8	0,90	5	0,10	20	5,74 €
MPE3-20/B	M3	20	8	8	0,90	5	0,10	20	5,81 €
MPE3-25/B	M3	25	10	10	0,90	5	0,10	20	6,68 €
MPE3-30/B	M3	30	10	10	0,90	5	0,10	20	6,98 €
MPE3-35/B	M3	35	10	10	0,90	5	0,10	20	7,29 €
MPE3-40/B	M3	40	10	10	0,90	5	0,10	20	11,36 €
MPE3-45/B	M3	45	10	10	0,90	5	0,10	20	12,33 €
MPE3-50/B	M3	50	10	10	0,90	5	0,10	20	13,37 €
MPE3-55/B	M3	55	10	10	0,90	5	0,10	20	14,06 €
MPE3-60/B	M3	60	10	10	0,90	5	0,10	20	14,88 €
MPE3-70/B	M3	70	10	10	0,90	5	0,10	20	16,12 €
MPE3-80/B	M3	80	10	10	0,90	5	0,10	20	17,09 €
MPE4-5/B	M4	5	3	8	1,20	7	0,20	20	6,22 €
MPE4-8/B	M4	8	4	8	1,20	7	0,20	20	6,68 €
MPE4-10/B	M4	10	6	8	1,20	7	0,20	20	6,19 €
MPE4-12/B	M4	12	8	8	1,20	7	0,20	20	6,68 €
MPE4-15/B	M4	15	8	8	1,20	7	0,20	20	6,74 €
MPE4-18/B	M4	18	8	8	1,20	7	0,20	20	7,36 €

*Depending on availability - Dimensions in mm

Part number	Thread		L1	L2	L3	L4	AF	R	Qty. per packet	Stock*	Price per packet
	OM										
MPE4-20/B	M4	20	8	8	1,20	7	0,20	20	✓	7,59 €	
MPE4-25/B	M4	25	10	10	1,20	7	0,20	20	✓	8,91 €	
MPE4-30/B	M4	30	10	10	1,20	7	0,20	20	✓	9,53 €	
MPE4-35/B	M4	35	10	10	1,20	7	0,20	20	✓	10,13 €	
MPE4-40/B	M4	40	10	10	1,20	7	0,20	20	✓	14,46 €	
MPE4-45/B	M4	45	10	10	1,20	7	0,20	20	✓	14,46 €	
MPE4-50/B	M4	50	10	10	1,20	7	0,20	20	✓	16,35 €	
MPE4-55/B	M4	55	10	10	1,20	7	0,20	20	-	17,39 €	
MPE4-60/B	M4	60	10	10	1,20	7	0,20	20	✓	18,36 €	
MPE4-70/B	M4	70	10	10	1,20	7	0,20	20	✓	20,77 €	
MPE4-80/B	M4	80	10	10	1,20	7	0,20	20	✓	22,40 €	
MPE5-5/B	M5	5	3	8	1,40	8	0,20	20	-	9,98 €	
MPE5-8/B	M5	8	4	8	1,40	8	0,20	20	-	9,98 €	
MPE5-10/B	M5	10	6	8	1,40	8	0,20	20	✓	9,98 €	
MPE5-12/B	M5	12	8	8	1,40	8	0,20	20	✓	10,38 €	
MPE5-15/B	M5	15	8	8	1,40	8	0,20	20	✓	10,88 €	
MPE5-18/B	M5	18	8	8	1,40	8	0,20	20	-	11,42 €	
MPE5-20/B	M5	20	8	8	1,40	8	0,20	20	✓	11,89 €	
MPE5-25/B	M5	25	10	10	1,40	8	0,20	20	✓	12,87 €	
MPE5-30/B	M5	30	10	10	1,40	8	0,20	20	✓	13,70 €	
MPE5-35/B	M5	35	10	10	1,40	8	0,20	20	✓	15,05 €	
MPE5-40/B	M5	40	10	10	1,40	8	0,20	20	✓	16,39 €	
MPE5-45/B	M5	45	10	10	1,40	8	0,20	20	✓	17,33 €	
MPE5-50/B	M5	50	10	10	1,40	8	0,20	20	✓	18,33 €	
MPE5-55/B	M5	55	10	10	1,40	8	0,20	20	-	19,33 €	
MPE5-60/B	M5	60	10	10	1,40	8	0,20	20	✓	20,50 €	
MPE5-70/B	M5	70	10	10	1,40	8	0,20	20	-	22,98 €	
MPE5-80/B	M5	80	10	10	1,40	8	0,20	20	✓	26,88 €	
MPE6-10/B	M6	10	6	12	2,10	10	0,25	20	✓	14,46 €	
MPE6-12/B	M6	12	8	12	2,10	10	0,25	20	✓	14,57 €	
MPE6-15/B	M6	15	8	12	2,10	10	0,25	20	✓	15,21 €	
MPE6-18/B	M6	18	12	12	2,10	10	0,25	20	✓	15,66 €	
MPE6-20/B	M6	20	13	12	2,10	10	0,25	20	✓	16,22 €	
MPE6-25/B	M6	25	13	12	2,10	10	0,25	20	✓	17,67 €	
MPE6-30/B	M6	30	13	12	2,10	10	0,25	20	✓	18,50 €	
MPE6-35/B	M6	35	13	12	2,10	10	0,25	20	✓	19,33 €	
MPE6-40/B	M6	40	13	12	2,10	10	0,25	20	✓	20,19 €	
MPE6-45/B	M6	45	13	12	2,10	10	0,25	20	✓	21,11 €	
MPE6-50/B	M6	50	13	12	2,10	10	0,25	20	✓	22,29 €	
MPE6-55/B	M6	55	13	12	2,10	10	0,25	20	-	23,16 €	
MPE6-60/B	M6	60	13	12	2,10	10	0,25	20	✓	24,00 €	
MPE6-70/B	M6	70	13	12	2,10	10	0,25	20	✓	26,08 €	
MPE6-80/B	M6	80	13	12	2,10	10	0,25	20	✓	27,77 €	

*Depending on availability - Dimensions in mm

Our other products



HTD8M_30

HTD-type pulley for RPP-type belt, HTD8 Steel



BPLF

Ball transfer unit, Light



LVT

Miniature motorised actuator, 1 ampere



BABss

Ball pin, 303 Stainless steel



CHTRB

Single and dual output gearboxes, Up to 87,3 Nm



PR125

Fixable articulated foot - polyamide, Ø 123



BLHB60

Right angled gearbox, up to 70 Nm



EMR

Tightening nut, Knurled



CQA30

Adjustment slide-system miniature, 30



DB

Bevel gear - Steel 60C40, 2:1



TR

Round spur rack, Stainless steel - module 0,25-1,5



MSP23

Masterplate® glueable insert, Cylindrical Ø23 with threaded stud

Complementary products



HSE-HSB

Spacer, Steel



MPB

Spacer, Brass