



# Stainless steel bow shackle with eye bolt

Pin diameters 5-20mm

MLYss

- Lifting shackle
- Material: Stainless steel 316
- No marking on the product

## Info.

- SWL: safe working load.
- The Safe Working Load is calculated by dividing the Breaking Strength by a factor of safety of 5.

stainless steel

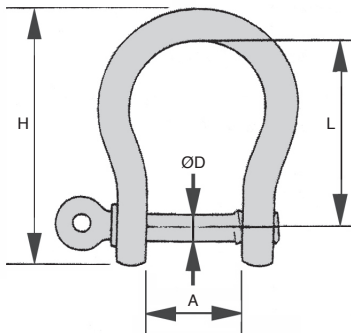

## DISCOUNTS

Qty	1+	5+	10+	20+	30+
Disc.	List	-5%	-10%	-15%	On request

Part number	Pin ØD	A	L	H	SWL (kg)	Weight (kg)	Stock*	Price each 1 to 4
MLY1-05/SS	5	10,0	20,0	30	190	0,015	✓	3,74 €
MLY1-06/SS	6	13,0	26,0	38	360	0,030	✓	3,93 €
MLY1-08/SS	8	17,0	34,0	50	540	0,080	✓	4,95 €
MLY1-10/SS	10	19,0	45,0	65	720	0,130	✓	8,02 €
MLY1-12/SS	12	24,6	54,0	72	1080	0,245	✓	14,53 €
MLY1-14/SS	13	28,0	65,0	91	1260	0,375	✓	19,72 €
MLY1-16/SS	16	33,0	71,0	105	1680	0,450	-	29,38 €
MLY1-20/SS	19	40,0	92,5	133	2400	0,860	-	55,53 €

\*Depending on availability - Dimensions in mm

## Our other products



HTD5M\_25

HTD Heavy duty timing pulley, HTD5 Aluminium



PR821

Idler sprocket for slat top chain, Ranges 821 and 805



PDM\_PDV

Detectable plastic palm grip, blue thermoplastic



CHML40

Worm and wheel gear reducer, up to 57 Nm - Integrated torque limiter



CHTRP

Single and dual output gearboxes, Up to 9,1 Nm



VQT

Quarter-turn clamp lock, Plastic or stainless steel button



ZG0

Plastic spur gear, Machined plastic (delrin)



SLH

Horizontal toggle clamp, Horizontal Lever Clamp - steel



VBFP

Small 6 lobe threaded handle - female,



CLG2

Moulded plastic spur gear, Moulded plastic



DOMI50

Connecting kits, XZ linking kit



BAC110

Swivel storage bin, Adjustable support

## Complementary products

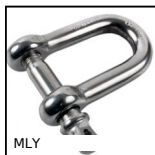

MLY

Bow shackle with eye bolt, Steel



MDR\_SS

Stainless steel Dee shackle with eye bolt, Stainless steel