

- Male/female sleeve
- Materials:
 - Galvanised steel
 - 303 Stainless steel
- Supplied by the pack

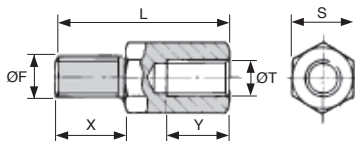

DISCOUNTS

Qty	1+	5+	20+	50+
Disc.	List	-5%	-10%	On request

Part number	OF	OT	S	L	X	Y	Qty per pack	Price each 1 to 4
Steel								
MHX6-8-19/B	M6	M8	13	19	7	7	20	15,91 €
MHX8-6-20/B	M8	M6	13	20	8	7	20	15,91 €
MHX8-10-23/B	M8	M10	13	23	8	9	20	15,91 €
MHX8-12-23/B	M8	M12	17	23	8	8	20	22,37 €
MHX10-6-21/B	M10	M6	13	21	8	7	20	15,91 €
MHX10-8-21/B	M10	M8	13	21	8	7	20	15,91 €
MHX10-12-25/B	M10	M12	17	25	10	8	20	22,37 €
MHX10-16-32/B	M10	M16	24	32	10	13	20	57,85 €
MHX12-8-23/B	M12	M8	13	23	10	7	20	15,91 €
MHX12-10-23/B	M12	M10	13	23	10	8	20	15,91 €
MHX12-16-32/B	M12	M16	24	32	10	13	20	57,85 €
MHX16-10-32/B	M16	M10	19	32	14	9	20	34,71 €
MHX16-12-32/B	M16	M12	19	32	14	10	20	34,71 €
Stainless steel								
MHX6-8-19/SS/B	M6	M8	13	19	7	7	20	67,94 €
MHX8-6-20/SS/B	M8	M6	13	20	8	7	20	67,94 €
MHX8-10-23/SS/B	M8	M10	13	23	8	9	20	67,94 €
MHX8-12-23/SS/B	M8	M12	17	23	8	8	20	87,92 €
MHX10-6-21/SS/B	M10	M6	13	21	8	7	20	67,94 €
MHX10-8-21/SS/B	M10	M8	13	21	8	7	20	67,94 €
MHX10-12-25/SS/B	M10	M12	17	25	10	8	20	87,92 €
MHX10-16-32/SS/B	M10	M16	24	32	10	13	20	142,29 €
MHX12-8-23/SS/B	M12	M8	13	23	10	7	20	67,94 €
MHX12-10-23/SS/B	M12	M10	13	23	10	8	20	67,94 €
MHX12-16-32/SS/B	M12	M16	24	32	10	13	20	142,29 €
MHX16-10-32/SS/B	M16	M10	19	32	14	9	20	100,82 €
MHX16-12-32/SS/B	M16	M12	19	32	14	10	20	100,82 €

Dimensions in mm

0 825 88 6000

Service 0,15 € / min
+ prix appel

Our other products



HLU
Spoked handwheel
without handle,
Aluminium



T5-BAR
T type tooth bar
stock, T5



OP6
Mechanical digital
position indicator, 5
numbers



HBM
Adjustment bushing
for half-rail guide,
Adjustment bushing

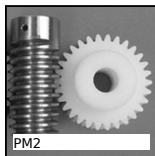

PM2
Worm and wheel set,
Machined plastic
(delrin)



GB-RA
Brass spur gear, Brass
CuZn39Pb3



BOXKU
Boxed set of half
round (Woodruff) keys
NFE22179, Boxed set
of half ...



PLM-16A
Magnetic stud with
threaded hole, With
threaded hole



PSG35
Spur gear - precision
range, Stainless steel
303



DPAR_DKON
Progressive stop,
Steel



PV2R
Adjustable suction-
cup support,
Increased grip



FF10
Offset spur gear
reducer, from 0.78 to
3.70 Nm

Complementary products



MHXred
Reducing sleeve
male/female,
Hexagonal - steel



TIF
Threaded rod -
DIN975, Stainless
steel A2



TIFss
Threaded stud -
DIN976A, Stainless
steel



MCL
Cylindrical threaded
sleeve, Cylindrical -
stainless steel