

- Male/female sleeve
- Materials:
  - Galvanised steel
  - 303 Stainless steel
- Supplied by the pack

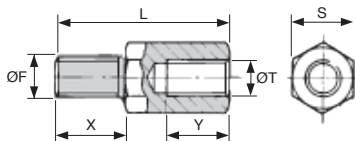

### DISCOUNTS

Qty	1+	5+	20+	50+
Disc.	List	-5%	-10%	On request

Part number	OF	OT	S	L	X	Y	Qty per pack	Price each 1 to 4
<b>Steel</b>								
MHX6-8-19/B	M6	M8	13	19	7	7	20	15,91 €
MHX8-6-20/B	M8	M6	13	20	8	7	20	15,91 €
MHX8-10-23/B	M8	M10	13	23	8	9	20	15,91 €
MHX8-12-23/B	M8	M12	17	23	8	8	20	22,37 €
MHX10-6-21/B	M10	M6	13	21	8	7	20	15,91 €
MHX10-8-21/B	M10	M8	13	21	8	7	20	15,91 €
MHX10-12-25/B	M10	M12	17	25	10	8	20	22,37 €
MHX10-16-32/B	M10	M16	24	32	10	13	20	57,85 €
MHX12-8-23/B	M12	M8	13	23	10	7	20	15,91 €
MHX12-10-23/B	M12	M10	13	23	10	8	20	15,91 €
MHX12-16-32/B	M12	M16	24	32	10	13	20	57,85 €
MHX16-10-32/B	M16	M10	19	32	14	9	20	34,71 €
MHX16-12-32/B	M16	M12	19	32	14	10	20	34,71 €
<b>Stainless steel</b>								
MHX6-8-19/SS/B	M6	M8	13	19	7	7	20	67,94 €
MHX8-6-20/SS/B	M8	M6	13	20	8	7	20	67,94 €
MHX8-10-23/SS/B	M8	M10	13	23	8	9	20	67,94 €
MHX8-12-23/SS/B	M8	M12	17	23	8	8	20	87,92 €
MHX10-6-21/SS/B	M10	M6	13	21	8	7	20	67,94 €
MHX10-8-21/SS/B	M10	M8	13	21	8	7	20	67,94 €
MHX10-12-25/SS/B	M10	M12	17	25	10	8	20	87,92 €
MHX10-16-32/SS/B	M10	M16	24	32	10	13	20	142,29 €
MHX12-8-23/SS/B	M12	M8	13	23	10	7	20	67,94 €
MHX12-10-23/SS/B	M12	M10	13	23	10	8	20	67,94 €
MHX12-16-32/SS/B	M12	M16	24	32	10	13	20	142,29 €
MHX16-10-32/SS/B	M16	M10	19	32	14	9	20	100,82 €
MHX16-12-32/SS/B	M16	M12	19	32	14	10	20	100,82 €

Dimensions in mm

0 825 88 6000

Service 0,15 € / min  
+ prix appel

## Our other products

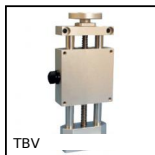

TBV  
Manual lifting tables,  
3kg



PTA50  
Articulated levelling  
foot, pressed base  
 $\varnothing 50$ ,  $\varnothing 50$



EIM  
Stainless steel U bolt,  
Stainless steel



BPH  
Ball transfer unit plain  
fit, High

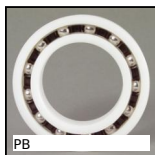

PB  
Plastic deep groove  
ball bearing, Plastic -  
balls material :  
stainle...



TB8  
Cylindrical roller  
thrust bearing, Steel

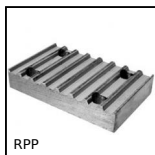

RPP  
Connecting plate for  
RPP type timing belts,  
RPP8



DOG316  
Motor-gearbox 12V  
and 24V DC, from 1.5  
to 2 Nm



SUPTOOL  
Installation tools for  
clamping hub, For  
hexagonal clamping



VB  
Small 6 lobe threaded  
handle - female,  
Duroplast - Stainless



PSG08S  
Spur gear - precision  
range, Stainless steel  
316



PTR  
Idle chain sprocket,  
For standard  
applications

## Complementary products

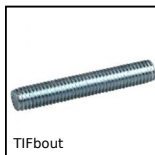

TIFbout  
Threaded stud -  
DIN976A, Steel



MHX  
Hexagonal threaded  
sleeve, Hexagonal -  
steel



MCL  
Cylindrical threaded  
sleeve, Cylindrical -  
steel



MCLred  
Reducing sleeve  
female/female,  
Cylindrical - steel