



Double-disc flexible coupling

Couplings for servo-motors

MHW

Torque: 2 to 20Nm

- **Very rigid in torsion**
- Misalignment absorbed by stainless steel disc
- Backlash free
- Resistant to oil and chemical products
- Maintenance free
- Materials:
 - Hubs: Aluminium A-U4G
 - Disc: Stainless steel 301
 - Pin: Stainless steel 303
 - Central disc: A-U5 Pb Bi
- Max. working temp.: +100°C

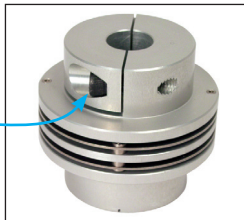

Applications

- Ideal for use with stepper motors that cannot detect start position
- Applications requiring high accuracy
- Automated systems

Info

- We are unable to modify these parts

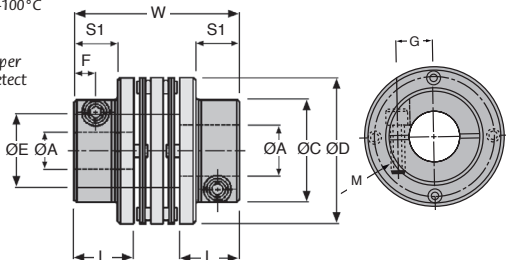

DISCOUNTS

Qty	1+	2+	4+
Disc.	List	-6%	On request

Part number	Max. speed of rotation (rpm)	Weight (g)	Moment of inertia (kg·m ²)	Static torsional stiffness (Nm/Rad)	Misalignment			Nominal torque (Nm)	Max. torque (Nm)
					Radial (mm)	Angular	Axial (mm)		
MHW-32C	19000	48	6,2 x 10 ⁻⁶	1000	0,15	2°	±0,40	2	4
MHW-40C	15000	81	1,6 x 10 ⁻⁵	1500	0,20	2°	±0,50	4	8
MHW-50C	12000	150	4,6 x 10 ⁻⁵	2000	0,20	2°	±0,60	7.5	15
MHW-63C	10000	230	1,1 x 10 ⁻⁴	2500	0,30	2°	±0,80	10	20

Part number	Standard bore	Max. bore		OE	F	L	W	OC	S1	M	G	Stock*	Price each
	ØA	ØA	ØD										
MHW-32C	6	10	32	15	4	13,70	40	22	9	M3	8,00	-	190,75 €
MHW-40C	8	14	40	25	6	16,50	46	28	12	M4	10,50	✓	213,93 €
MHW-50C	12	20	50	25	7	19,40	52	39	15	M5	14,75	✓	257,25 €
MHW-63C	15	25	63	32	8	22,30	58	45	18	M6	17,00	✓	364,47 €

*Depending on availability - Dimensions in mm

Our other products



MEP
Revolving handle for handwheel, Fixed

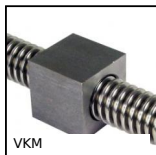

VKM
Square steel nut, Steel - 1 thread



WW10
Drylin® W slide, slide assembly



HLU
Spoked handwheel without handle, Aluminium



KK
Rounded end feather key, Steel



PV2R
Adjustable suction-cup support, Increased grip



G0
Steel spur gear, Steel 20NCD2



GGB
Female wing knob, With blind thread



PTA100
Articulated levelling foot, pressed base



SCR
Suction cup threaded insert, Adaptor for



PLA
Flat magnet, Flat magnet

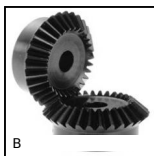

B
Steel bevel gear, 1:1

Complementary products



MHSC
Single-disc flexible coupling, Single disk