



Double-disc flexible coupling

Couplings for servo-motors

MHW

Torque: 2 to 20Nm

- **Very rigid in torsion**
- Misalignment absorbed by stainless steel disc
- Backlash free
- Resistant to oil and chemical products
- Maintenance free
- Materials:
 - Hubs: Aluminium A-U4G
 - Disc: Stainless steel 301
 - Pin: Stainless steel 303
 - Central disc: A-U5 Pb Bi
- Max. working temp.: +100°C

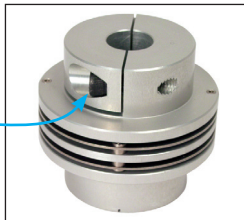

Applications

- Ideal for use with stepper motors that cannot detect start position
- Applications requiring high accuracy
- Automated systems

Info

- We are unable to modify these parts

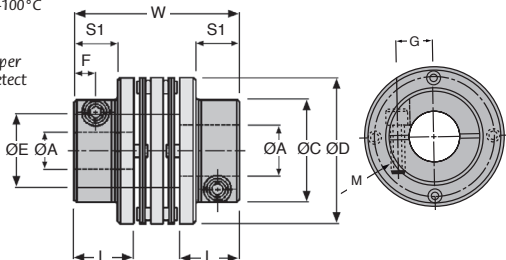

DISCOUNTS

Qty	1+	2+	4+
Disc.	List	-6%	On request

Part number	Max. speed of rotation (rpm)	Weight (g)	Moment of inertia (kg·m ²)	Static torsional stiffness (Nm/Rad)		Misalignment			Nominal torque (Nm)	Max. torque (Nm)
						Radial (mm)	Angular	Axial (mm)		
MHW-32C	19000	48	6,2 x 10 ⁻⁶	1000	0,15	2°	±0,40	2	4	
MHW-40C	15000	81	1,6 x 10 ⁻⁵	1500	0,20	2°	±0,50	4	8	
MHW-50C	12000	150	4,6 x 10 ⁻⁵	2000	0,20	2°	±0,60	7.5	15	
MHW-63C	10000	230	1,1 x 10 ⁻⁴	2500	0,30	2°	±0,80	10	20	

Part number	Standard bore		Max. bore		OE	F	L	W	OC	S1	M	G	Stock*	Price each
	ØA	ØA	ØD	ØE										
MHW-32C	6	10	32	15	4	13,70	40	22	9	M3	8,00	-	190,75 €	
MHW-40C	8	14	40	25	6	16,50	46	28	12	M4	10,50	✓	213,93 €	
MHW-50C	12	20	50	25	7	19,40	52	39	15	M5	14,75	✓	257,25 €	
MHW-63C	15	25	63	32	8	22,30	58	45	18	M6	17,00	✓	364,47 €	

*Depending on availability - Dimensions in mm

Our other products



RPCpl
Fixed castor with plate, Steel - Polyamide



S_ZZ
Deep groove ball bearing, Stainless steel



CTZY
Diabolo shaped elasto mount, Steel



BOXKK
Boxed set of DIN6885A keys, Boxed set - Steel or stainless steel



PM4
Worm and wheel set, Non hardened steel



DGSA
Male rod ends, Steel / steel - Economy range



DB
Steel bevel gear, 2:1



VRSF
Male swivelling lifting ring, Male swivelling



TBV
Manual lifting tables, 20kg



T10courroie
T type timing belt, T10 Steel cored polyurethane



PRF_PL_4590
Joining plate for aluminium profile, Joint plate - 45x90 mm



MSP19
Masterplate® glueable insert Ø19, Cylindrical with tapped insert

Complementary products



MHSC
Single-disc flexible coupling, Single disk