



Crank arm with rotating handle

Square bore, technopolymer

MHQ_{MEP}

- Crank arm with rotating handle and a square through-bored hole
- Operating elements
- Material:
Black glass fibre reinforced polyamide
Matt surface finish

Options

- Alternative bores on request
- Industry standard keyways available

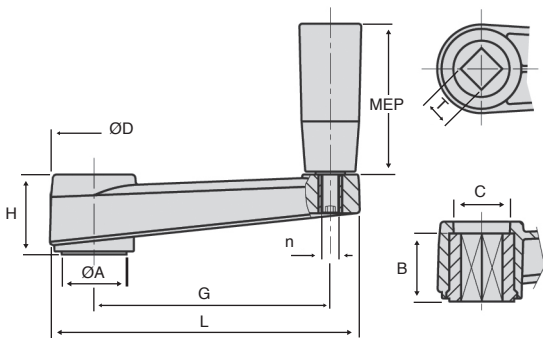

DISCOUNTS

Qty	1+	10+	20+
Disc.	List	-5%	On request

Part number	G	L	ØA	ØD	H	T	B	C	MEP	n	Stock*	Price each
												1 to 9
MHQ65-MEP	65	87	18	27	23	8x8	20	16	21x50	M6	✓	18,89 €
MHQ80-MEP	80	105	22	30	26	10x10	22	19	21x50	M6	✓	21,12 €
MHQ100-MEP	100	128	24	34	30	12x12	27	22	23x70	M8	✓	25,09 €
MHQ130-MEP	130	162	28	40	35	14x14	30	25	26x90	M8	✓	33,64 €
MHQ160-MEP	160	196	34	45	40	17x17	34	28	26x90	M10	✓	43,67 €

*Subject to availability - Dimensions in mm

Our other products



EPE

Wing nuts Hygienic Design®, Narrow



CHMX_CHMDX

Shaft for worm and wheel reducer CHMR and CHM, CHMR and CHM gearbox...



NSR

Adjustable clamp, Adjustable



CLSCLP

Clevis components, short version, Steel - Short range



BPQ

Quadro linear ball bearing unit, Included 4 linear ball bearings



RBGpl

Fixed castor with plate, Steel - grey rubber



SCE_SS

Stainless steel U-shaped clamp, Stainless steel



ACLEFS

Floor anchor for aluminium profile, Standard

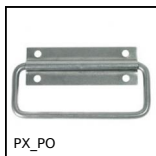

PX_PO

Carrying handle, standard



BLHB30

Right angled gearbox, bored shafts, up to 4.4 Nm



PFM

Fixed levelling foot, Flanged plate



HLA24

Right angle spiro bevel gearbox, Up to 78Nm

Complementary products



MHMEP

Arm with rotating handle, Prebored



MHPGR

Arm with folding rotating handle,



MEP

Revolving handle for handwheel, Fixed



PGR

Folding revolving handle for handwheel, Folding