



## Couplings for servo-motors

# MFBS

Torque: **0.5 to 3Nm**

- High precision
- High torsional stiffness
- Large misalignment
- Identical operation in both clockwise and anti-clockwise directions
- Materials:  
Hub: stainless steel 303  
Bellows: stainless steel 316L
- Max. working temperature:  
+150°C
- Bellows and hub bonded together

stainless steel

set screw fixing

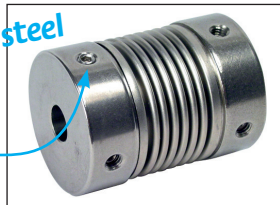

### Uses

- Encoders, automated and robotic systems
- Stepper motors that cannot detect start position

### Options

- We are unable to modify these parts

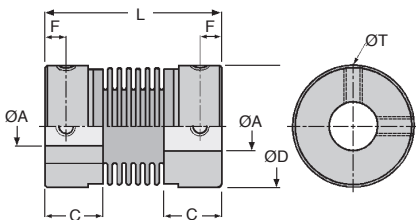

**STANDARD BORES IN STOCK**

Part number	Misalignment			Torque	
	Radial (mm)	Axial (mm)	Angular	Nominal (Nm)	Max. (Nm)
MFBS-12	0,10	+0,40 -1,20	1,5°	0,5	1
MFBS-16	0,10	+0,40 -1,20	1,5°	1,0	2
MFBS-20	0,15	+0,60 -1,80	2,0°	1,5	3
MFBS-25	0,15	+0,60 -1,80	2,0°	2,0	4
MFBS-32	0,20	+0,80 -2,50	2,0°	3,0	6

### DISCOUNTS

Qty	1+	2+	4+
Disc.	List	-6%	On request

Part number	Standard bore	Max. bore ØA	Max. bore ØD	L	C	ØT	F	Moment of inertia (kg·m <sup>2</sup> )	Torsional stiffness (Nm/Rad)	Weight (g)	Max. rotational speed (rpm)	Price each Standard Bore
MFBS-12	3 x 3	6,35	12	23,5	7,5	M2,5	2,5	2,1 x 10 <sup>-7</sup>	100	9,1	52000	95,04 €
MFBS-16	4 x 4	8	16	26,5	9,0	M3	3,0	8,0 x 10 <sup>-7</sup>	150	20,0	39000	118,27 €
MFBS-20	5 x 5	10	20	32,0	10,0	M3	3,5	2,3 x 10 <sup>-6</sup>	220	37,0	31000	128,08 €
MFBS-25	6 x 6	12	25	36,5	12,0	M4	4,5	7,0 x 10 <sup>-6</sup>	330	73,0	25000	133,43 €
MFBS-32	6 x 6	16	32	42,0	13,5	M4	5,5	2,1 x 10 <sup>-5</sup>	490	130,0	19000	174,41 €

Dimensions in mm

## Our other products



BDMdl  
Magnetic bush for pin,  
Fast and light  
magnetic locking



R206  
Die spring ISO 10243,  
Extra-heavy



PDD  
Actuating plunger,  
Non-rotating detector  
shaft



PHG05  
Parallel axis helical  
gear - Precision range,  
20NCD2 case  
hardened s...

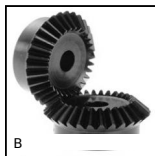

B  
Steel bevel gear, 1:1



ERF  
Quick fitting threaded  
cable terminal, Cable  
terminal with  
threaded ...



NSP  
Right angled support  
clamp, Right angled  
support clamp



CLM  
Male clevis end,  
Stainless steel short



D-PAR\_SS  
Stainless steel elasto  
mount, stainless steel



KB\_WW  
Closed linear  
precision bearings,  
Economy range



MHQMEP  
Arm with rotating  
handle, Square bore



LVT  
Miniature motorised  
actuator, 4A, 4  
ampers

## Complementary products



MFB  
Flexible bellows  
coupling, Aluminium  
and Bronze - With set  
screw



MFBC  
Flexible Bellows  
coupling, Aluminium  
and Bronze - with  
clamping jaw