



# Stainless steel bellows flexible coupling

## Couplings for servo-motors

# MFBS

Torque: **0.5 to 3Nm**

- High precision
- High torsional stiffness
- Large misalignment
- Identical operation in both clockwise and anti-clockwise directions
- Materials:  
Hub: stainless steel 303  
Bellows: stainless steel 316L
- Max. working temperature:  
+150°C
- Bellows and hub bonded together

stainless steel

set screw fixing

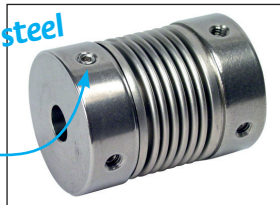

### Uses

- Encoders, automated and robotic systems
- Stepper motors that cannot detect start position

### Options

- We are unable to modify these parts

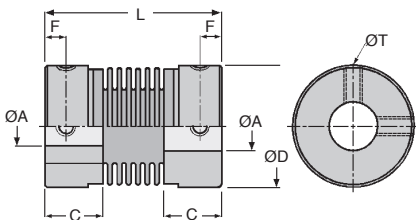

**STANDARD BORES IN STOCK**

Part number	Misalignment			Torque	
	Radial (mm)	Axial (mm)	Angular	Nominal (Nm)	Max. (Nm)
MFBS-12	0,10	+0,40 -1,20	1,5°	0,5	1
MFBS-16	0,10	+0,40 -1,20	1,5°	1,0	2
MFBS-20	0,15	+0,60 -1,80	2,0°	1,5	3
MFBS-25	0,15	+0,60 -1,80	2,0°	2,0	4
MFBS-32	0,20	+0,80 -2,50	2,0°	3,0	6

### DISCOUNTS

Qty	1+	2+	4+
Disc. List		-6%	On request

Part number	Standard bore	Max. bore ØA	ØD	L	C	ØT	F	Moment of inertia (kg·m <sup>2</sup> )	Torsional stiffness (Nm/Rad)	Weight (g)	Max. rotational speed (rpm)	Price each Standard Bore
MFBS-12	3 x 3	6,35	12	23,5	7,5	M2,5	2,5	2,1 x 10 <sup>-7</sup>	100	9,1	52000	95,04 €
MFBS-16	4 x 4	8	16	26,5	9,0	M3	3,0	8,0 x 10 <sup>-7</sup>	150	20,0	39000	118,27 €
MFBS-20	5 x 5	10	20	32,0	10,0	M3	3,5	2,3 x 10 <sup>-6</sup>	220	37,0	31000	128,08 €
MFBS-25	6 x 6	12	25	36,5	12,0	M4	4,5	7,0 x 10 <sup>-6</sup>	330	73,0	25000	133,43 €
MFBS-32	6 x 6	16	32	42,0	13,5	M4	5,5	2,1 x 10 <sup>-5</sup>	490	130,0	19000	174,41 €

Dimensions in mm

## Our other products



SVR15  
Screwjack with travelling nut, with moving nut

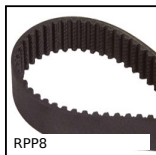

RPP8  
RPP heavy duty timing belt, RPP8



BPFss  
Pressed stainless steel flange bearing, Stainless steel



PENV  
Recessed handle, screw fixing



STRIP  
Sealing brush strip, 3m length



PGNT  
Thermoplastic T handle, With threaded insert



DOMI30  
Domino 30 adjustable slide, Slide DOMILINE 30 with counter and handw...



ACLEPP  
Right angled bracket for aluminium profile, 8 holes

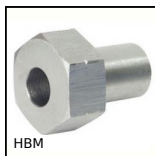

HBM  
Adjustment bushing for half-rail guide, Adjustment bushing



PW\_PWG1  
Wheel - precision range, Bronze



KB\_WW  
Closed linear precision bearing, Economy range



FHSS  
Countersunk screw, Stainless steel A2 - DIN 7991

## Complementary products



MFB  
Flexible bellows coupling, Aluminium and Bronze - With set screw



MFBC  
Flexible Bellows coupling, Aluminium and Bronze - with clamping jaw