

MFBC

Couplings for servo-motors

Torque: **0.3 to 2Nm**

- High precision
- High torsional stiffness
- Large misalignment
- Identical operation in both clockwise and anti-clockwise directions
- Materials:
 - Hub: Aluminium A-U5 Pb Bi
 - Bellows: Phosphorated bronze
- Max. working temperature: +100°C
- Bellows and hub bonded together

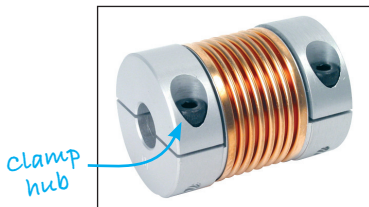

Uses

- Encoders, automated and robotic systems
- Stepper motors that cannot detect start position

Info

- We are unable to modify these parts

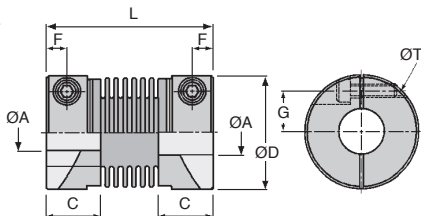

Part number	Misalignment			Torque	
	Radial (mm)	Axial (mm)	Angular	Nominal (Nm)	Max. (Nm)
MFBC-12C	0,10	+0,40 -1,20	1,5°	0,3	0,6
MFBC-16C	0,10	+0,40 -1,20	1,5°	0,5	1,0
MFBC-20C	0,15	+0,60 -1,80	2,0°	0,8	1,6
MFBC-25C	0,15	+0,60 -1,80	2,0°	1,3	2,6
MFBC-32C	0,20	+0,80 -2,50	2,0°	2,0	4,0

DISCOUNTS

Qty	1+	2+	4+
Disc.	List	-6%	On request

Part number	Standard bore	Max. bore ØA	ØD	L	C	ØT	F	G	Moment of inertia (kg·m ²)	Torsional Stiffness (Nm/Rad)	Max. rotational speed (rpm)	Stock*	Price each Standard Bores
												Standard bores	
MFBC-12C	4 x 4	5,00	12	23,5	7,5	M2	2,25	4,0	9,7 x 10 ⁻⁶	82	52 000	✓	72,46 €
MFBC-16C	5 x 5	6,35	16	26,5	9,0	M2,5	3,00	5,0	3,7 x 10 ⁻⁷	110	39 000	✓	72,52 €
MFBC-20C	6 x 6	8,00	20	33,0	10,0	M2,5	3,50	6,5	1,0 x 10 ⁻⁷	180	31 000	✓	72,65 €
MFBC-25C	8 x 8	10,0	25	36,5	12,0	M3	4,50	9,0	3,1 x 10 ⁻⁶	240	25 000	✓	101,89 €
MFBC-32C	8 x 8	14,0	32	42,0	13,5	M4	5,00	11,0	9,6 x 10 ⁻⁶	330	19 000	✓	97,80 €

*Depending on availability - Dimensions in mm

Our other products



AT5courroie

AT type timing belt,
AT5 Steel cored
polyurethane



PTA50

Articulated levelling
foot, pressed base
 $\varnothing 50$, $\varnothing 50$



CHTRP

Single and dual
output gearboxes, Up
to 9,1 Nm



BAG-MI

Split shaft collar with
clamp lever, Steel



RBntc

Swivel castor with
central hole, Steel -
rubber - with double
brake



STRIP1000

Sealing brush strip,
1m length

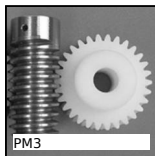

PM3

Worm and wheel set,
Machined plastic
(delrin)



BLM

Spring loaded plunger
with ball tip, Stainless
steel body



PSG15S

Spur gear - precision
spring, Stainless steel



TPEf

Castor for aluminium
profile, Fixed



VTA

Vari-Tork® slip
friction clutch, 0.53 to



gt64

Rotating bent lever,
Common applications

Complementary products



MFBS

Stainless steel flexible
bellows coupling,
Stainless steel - with cl...



MFBS

Stainless steel flexible
bellows coupling,
Stainless steel - with se...



DKN

Bellows coupling
Gerwah®, from 0.4 to
10Nm