

MFBC

Couplings for servo-motors

Torque: **0.3 to 2Nm**

- High precision
- High torsional stiffness
- Large misalignment
- Identical operation in both clockwise and anti-clockwise directions
- Materials:
 - Hub: Aluminium A-U5 Pb Bi
 - Bellows: Phosphorated bronze
- Max. working temperature: +100°C
- Bellows and hub bonded together

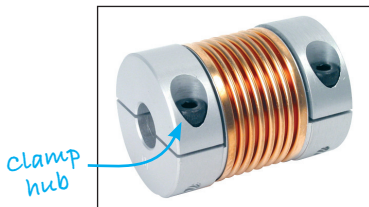

Uses

- Encoders, automated and robotic systems
- Stepper motors that cannot detect start position

Info

- We are unable to modify these parts

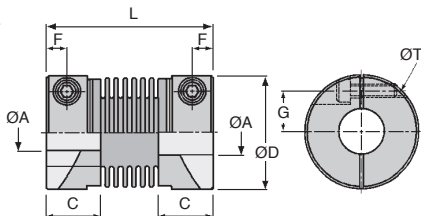

Part number	Misalignment			Torque	
	Radial (mm)	Axial (mm)	Angular	Nominal (Nm)	Max. (Nm)
MFBC-12C	0,10	+0,40 -1,20	1,5°	0,3	0,6
MFBC-16C	0,10	+0,40 -1,20	1,5°	0,5	1,0
MFBC-20C	0,15	+0,60 -1,80	2,0°	0,8	1,6
MFBC-25C	0,15	+0,60 -1,80	2,0°	1,3	2,6
MFBC-32C	0,20	+0,80 -2,50	2,0°	2,0	4,0

DISCOUNTS

Qty	1+	2+	4+
Disc.	List	-6%	On request

Part number	Standard bore	Max. bore ØA	ØD	L	C	ØT	F	G	Moment of inertia (kg·m ²)	Torsional Stiffness (Nm/Rad)	Max. rotational speed (rpm)	Stock*	Price each Standard Bores
												Standard bores	
MFBC-12C	4 x 4	5,00	12	23,5	7,5	M2	2,25	4,0	9,7 x 10 ⁻⁶	82	52 000	✓	72,46 €
MFBC-16C	5 x 5	6,35	16	26,5	9,0	M2,5	3,00	5,0	3,7 x 10 ⁻⁷	110	39 000	✓	72,52 €
MFBC-20C	6 x 6	8,00	20	33,0	10,0	M2,5	3,50	6,5	1,0 x 10 ⁻⁷	180	31 000	✓	72,65 €
MFBC-25C	8 x 8	10,0	25	36,5	12,0	M3	4,50	9,0	3,1 x 10 ⁻⁶	240	25 000	✓	101,89 €
MFBC-32C	8 x 8	14,0	32	42,0	13,5	M4	5,00	11,0	9,6 x 10 ⁻⁶	330	19 000	✓	97,80 €

*Depending on availability - Dimensions in mm

Our other products



PR820
Idler sprocket for slat top chain, Rangs 820 and 815



CHTRP
Single and dual output gearboxes, Up to 75,7 Nm



H0
Crossed helical gear crossed axis at 90°, Steel 20NCD2



RBNTc
Swivel castor with central hole, Steel - rubber - with double brake



T5P_T10P
Connecting plate for T type timing belts, T10



HD
Double needle roller universal joint, Heavy duty



PSG15
Spur gear - precision range, Case hardened steel 20NCD2



LPCM
Lever with cylindrical handle, Black Duroplast, steel lever



PRF_ECL
Nut for aluminium profile, Stainless steel



PHG05
Parallel axis helical gear - Precision range, High torque



RTL450
Self-centering locking assembly, High torque



PITAss
Locking bolt, with T handle

Complementary products



MFBS
Stainless steel flexible bellows coupling, Stainless steel - with cl...



MFBS
Stainless steel flexible bellows coupling, Stainless steel - with se...



DKN
Bellows coupling Gerwah®, from 0.4 to 10Nm