

Flexible bellows coupling



MFB

Couplings for servo-motors

Torque: 0.3 to 2Nm

- High precision
- High torsional stiffness
- Large misalignment
- Identical operation in both clockwise and anti-clockwise directions
- Materials:
 - Hub: Aluminium A-U5 Pb Bi
 - Bellows: Phosphorated bronze
- Max. working temperature: +100°C
- Bellows and hub bonded together

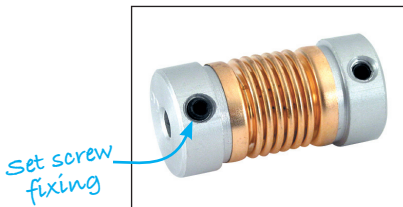

Uses

- Encoders, automated and robotic systems
- Stepper motors that cannot detect start position

Info

- We are unable to modify these parts

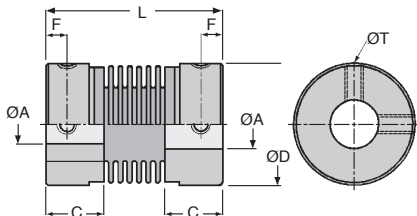

STANDARD BORES IN STOCK

Part number	Misalignment			Torque	
	Radial (mm)	Axial (mm)	Angular	Nominal (Nm)	Max. (Nm)
MFB-12	0,10	+0,40 -1,20	1,5°	0,3	0,6
MFB-16	0,10	+0,40 -1,20	1,5°	0,5	1,0
MFB-20	0,15	+0,60 -1,80	2,0°	0,8	1,6
MFB-25	0,15	+0,60 -1,80	2,0°	1,3	2,6
MFB-32	0,20	+0,80 -2,50	2,0°	2,0	4,0

DISCOUNTS

Qty	1+	2+	4+
Disc.	List	-6%	On request

Part number	Max. bore		ØD	L	C	ØT	F	Moment of inertia (kg·m ²)	Torsional stiffness (Nm/Rad)	Weight (g)	Max. rotational speed (rpm)	Price each Standard Bores
	Standard bore ØA	ØA										
MFB-12	3 x 3	6,35	12	23,5	7,5	M2,5	2,5	9,0 x 10 ⁻⁸	82	4,1	52000	55,01 €
MFB-16	4 x 4	8	16	26,5	9,0	M3	3,0	3,5 x 10 ⁻⁷	110	9,0	39000	56,95 €
MFB-20	5 x 5	10	20	33,0	10,0	M3	3,5	9,9 x 10 ⁻⁷	180	16,0	31000	56,42 €
MFB-25	6 x 6	12	25	36,5	12,0	M4	4,5	3,1 x 10 ⁻⁶	240	32,0	25000	72,55 €
MFB-32	6 x 6	16	32	42,0	13,5	M4	5,5	9,2 x 10 ⁻⁶	330	57,0	19000	83,45 €

Dimensions in mm

Our other products



OP3_14_06
Reducing sleeve for
OP indicators,
Reduction socket



BABam
Self-locking ball pin
lifting ring for
threaded hole, Self-
locking



ADSR
Backlash free
coupling Gerwah®,
from 12.5 to 525Nm



CMA
Eye bolt, Steel



PCS50
Chain sprocket - steel,
12.7mm (DIN08B-1)



SVG
Adjustable latch
clamp with strike
plate, Stroke from
118mm to 130,5mm



NT91
Spur gear coaxial
gearbox, from 10 to
35 Nm - In-line



SH0
Parallel axis helical
gear, Steel 20NCD2



CPAS
Stay with safety
catch, Opens upward



T10courroie
T type timing belt,
T10 Steel cored



MEB
Moulded plastic bevel
gear (nylon), 1:1



SSDB
Stainless steel bevel
gear, 2:1

Complementary products



MFBS
Stainless steel flexible
bellows coupling,
Stainless steel - with
se...



MFBC
Flexible Bellows
coupling, Aluminium
and Bronze - with
clamping jaw



EKN
Bellows coupling
Gerwah®, from 0.5 to
12Nm