

Cylindrical reducing sleeve

SteSta

MCL

Steel or **stainless steel**

- **Male/female sleeve**
- Allows 2 rods of different diameters to be joined
- Materials:
 - Galvanised steel
 - 303 Stainless steel
- **Supplied by the pack**

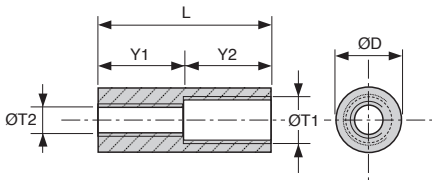

DISCOUNTS

Qty	1+	5+	20+	50+
Disc.	List	-5%	-10%	On request

Part number	ØT1	ØT2	ØD	L	Y1	Y2	Qty per pack	Price each 1 to 4
Steel								
MCL6-8-40/B	M6	M8	13	40	20	20	20	19,82 €
MCL6-10-40/B	M6	M10	16	40	20	20	20	28,36 €
MCL8-10-40/B	M8	M10	16	40	20	20	20	28,36 €
MCL8-12-40/B	M8	M12	16	40	20	20	20	28,36 €
MCL10-12-40/B	M10	M12	16	40	20	20	20	28,36 €
MCL10-16-40/B	M10	M16	22	40	20	20	20	40,53 €
MCL12-16-40/B	M12	M16	22	40	20	20	20	40,53 €
Stainless steel								
MCL6-8-40/SS/B	M6	M8	13	40	20	20	20	53,60 €
MCL6-10-40/SS/B	M6	M10	16	40	20	20	20	70,75 €
MCL8-10-40/SS/B	M8	M10	16	40	20	20	20	70,75 €
MCL8-12-40/SS/B	M8	M12	16	40	20	20	20	70,75 €
MCL10-12-40/SS/B	M10	M12	16	40	20	20	20	70,75 €
MCL10-16-40/SS/B	M10	M16	22	40	20	20	20	130,85 €
MCL12-16-40/SS/B	M12	M16	22	40	20	20	20	130,85 €

Dimensions in mm

Our other products



BPPss
Pressed stainless steel pillow block, Stainless steel

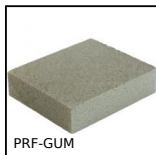

PRF-GUM
Aluminium profile anodising polisher, Polishing block

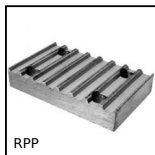

RPP
Connecting plate for RPP type timing belts, RPP14



BMM
Knurled knob - male, Knurled



RTL450
Self-centering locking assembly, High torque



MAX22
Motor-gearbox 12V and 24V DC, from 0,07 to 0,2Nm



SVT5
Screwjack with travelling screw, with translating screw



H0
Crossed helical gear, crossed axis at 90°, Steel 20NCD2



RT25
Self-centering flanged locking assembly, Medium/high torque

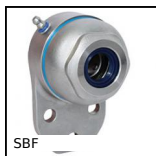

SBF
Sealed flange bearing unit for Food Industry, cover



PRF_ECL
Nut for aluminium profile, Steel square nut with tab



ACL-PL
Joining plate for aluminium profile, Joint plate - 176x86 mm

Complementary products



MHXred
Reducing sleeve male/female, Hexagonal - stainless steel



TIF
Threaded rod - DIN975, Stainless steel A2



TIFss
Threaded stud - DIN976A, Stainless steel



MCL
Cylindrical threaded sleeve, Cylindrical - stainless steel