

- Cylindrical sleeves, through threaded
- Suitable for joining threaded bars
- Materials:
Zn3-5BL galvanised steel S300PB
Stainless steel 303
- Sold by the packet

Steel or stainless steel

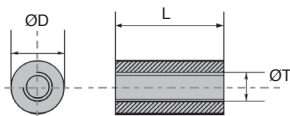

DISCOUNTS

| No. packets | 1+ | 5+ | 20+ | 50+ |
|-------------|------|-----|------|------------|
| Discounts | List | -5% | -10% | On request |

| Part number | | Thread | ØT | L | ØD | Qty per packet | Stock* | | Price per packet 1 to 4 | |
|-------------|-----------------|--------|----|----|----|----------------|--------|---------|-------------------------|---------|
| Steel | Stainless steel | | | | | | Steel | S/steel | Steel | S/steel |
| MCL4-15/B | - | M4 | 15 | 7 | 20 | ✓ | - | 4,55 € | - | |
| MCL4-20/B | - | M4 | 20 | 7 | 20 | ✓ | - | 4,83 € | - | |
| - | MCL5-15/SS/B | M5 | 15 | 8 | 20 | - | ✓ | - | 23,87 € | |
| MCL5-20/B | - | M5 | 20 | 8 | 20 | ✓ | - | 4,93 € | - | |
| MCL5-25/B | - | M5 | 25 | 8 | 20 | ✓ | - | 5,31 € | - | |
| MCL6-10/B | MCL6-10/SS/B | M6 | 10 | 10 | 20 | ✓ | ✓ | 4,15 € | 20,60 € | |
| MCL6-15/B | - | M6 | 15 | 10 | 20 | - | - | 4,55 € | - | |
| MCL6-20/B | MCL6-20/SS/B | M6 | 20 | 10 | 20 | ✓ | ✓ | 5,12 € | 25,02 € | |
| MCL6-25/B | MCL6-25/SS/B | M6 | 25 | 10 | 20 | ✓ | ✓ | 5,50 € | 30,30 € | |
| MCL6-30/B | MCL6-30/SS/B | M6 | 30 | 10 | 20 | ✓ | ✓ | 6,27 € | 35,40 € | |
| MCL6-35/B | - | M6 | 35 | 10 | 20 | ✓ | - | 7,81 € | - | |
| MCL6-40/B | - | M6 | 40 | 10 | 20 | ✓ | - | 8,30 € | - | |
| MCL6-50/B | - | M6 | 50 | 10 | 20 | ✓ | - | 14,73 € | - | |
| MCL8-15/B | - | M8 | 15 | 11 | 20 | ✓ | - | 5,12 € | - | |
| MCL8-20/B | MCL8-20/SS/B | M8 | 20 | 11 | 20 | - | ✓ | 5,50 € | 32,99 € | |
| MCL8-25/B | MCL8-25/SS/B | M8 | 25 | 11 | 20 | ✓ | - | 5,88 € | 35,40 € | |
| MCL8-30/B | MCL8-30/SS/B | M8 | 30 | 11 | 20 | ✓ | ✓ | 6,47 € | 43,17 € | |
| MCL8-35/B | MCL8-35/SS/B | M8 | 35 | 11 | 20 | - | - | 8,68 € | 46,93 € | |
| MCL8-40/B | MCL8-40/SS/B | M8 | 40 | 11 | 20 | ✓ | - | 9,26 € | 52,71 € | |
| MCL8-50/B | MCL8-50/SS/B | M8 | 50 | 11 | 20 | ✓ | ✓ | 14,92 € | 65,96 € | |
| MCL10-20/B | MCL10-20/SS/B | M10 | 20 | 13 | 20 | ✓ | - | 6,95 € | 41,18 € | |
| MCL10-25/B | MCL10-25/SS/B | M10 | 25 | 13 | 20 | - | ✓ | 8,11 € | 51,06 € | |
| MCL10-30/B | MCL10-30/SS/B | M10 | 30 | 13 | 20 | - | - | 8,68 € | 60,58 € | |
| MCL10-35/B | - | M10 | 35 | 13 | 20 | - | - | 10,22 € | - | |
| MCL10-40/B | MCL10-40/SS/B | M10 | 40 | 13 | 20 | - | ✓ | 11,75 € | 71,82 € | |
| MCL10-50/B | MCL10-50/SS/B | M10 | 50 | 13 | 20 | - | ✓ | 17,90 € | 89,50 € | |
| MCL10-60/B | - | M10 | 60 | 13 | 20 | - | - | 21,83 € | - | |
| MCL12-20/B | - | M12 | 20 | 15 | 20 | ✓ | - | 9,84 € | - | |
| MCL12-25/B | - | M12 | 25 | 15 | 20 | - | - | 10,81 € | - | |
| MCL12-30/B | MCL12-30/SS/B | M12 | 30 | 15 | 20 | - | ✓ | 12,24 € | 80,46 € | |
| MCL12-35/B | - | M12 | 35 | 15 | 20 | - | - | 14,34 € | - | |
| MCL12-40/B | MCL12-40/SS/B | M12 | 40 | 15 | 20 | - | - | 15,80 € | 93,08 € | |
| MCL12-50/B | MCL12-50/SS/B | M12 | 50 | 15 | 20 | - | - | 24,26 € | 103,92 € | |
| MCL12-60/B | - | M12 | 60 | 15 | 20 | - | - | 30,80 € | - | |

*Depending of availability - Dimensions in mm

Our other products



CHA_GC_955
Stainless steel garnet hinge, To be welded



ATZYSS
Stainless steel diabolo shaped elasto mount, Stainless steel



PENC
Recessed handle, clip-in



KKSS
Rounded end feather key, Stainless steel



PRFRTR
Cross connector for aluminium profile, Cross connector



GMK17_RG
Joint for guiding profile, Rounded



CHNrb
Warning chain with red and white links, Steel



COA-COG
Surface mounting plate, Surface mounting plate for ball joint



EHD04
Internal epicyclic servo reducers, from

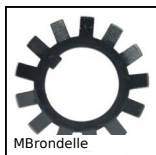

MBrondelle
Stop washer, Stop washer MB



RNAST
Cam follower without axial guide, Without



GAC
Latch clamp with lock, Lockable

Complementary products



MCL
Cylindrical threaded sleeve, Cylindrical - steel



TIF
Threaded rod - DIN975, Stainless steel A2



MHXred
Reducing sleeve male/female, Hexagonal - stainless steel



MCLred
Reducing sleeve female/female, Cylindrical - stainless steel