

- The tabs around the washer fold down into the tabs on the KM locknut
- The washer being held in place in rotation by the keyway, the system guarantees absolute security
- Material: steel

### Accessories

- KM locknut

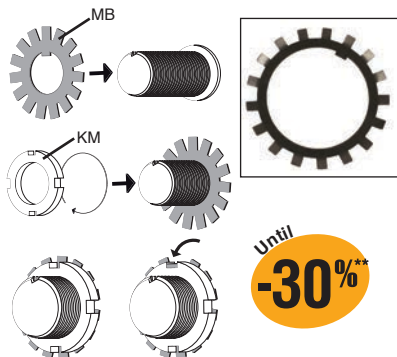
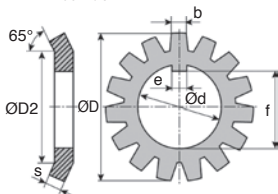

Until  
**-30%\*\***

### DISCOUNTS

Qty	1+	10+	20+	50+
Disc.	List	-30%	-50%	On request

Part number	For locknut	Ød	ØD	ØD2	e	f	s	Weight (g)	Stock*	Price each 1 to 9
MB3	KM3	17	32	24	4	15,5	1,00	3,1	✓	0,40 €
MB4	KM4	20	36	26	4	18,5	1,00	3,5	✓	0,40 €
MB5	KM5	25	42	32	5	23,0	1,00	6,4	✓	0,45 €
MB6	KM6	30	49	38	5	27,5	1,25	7,8	✓	0,36 €
MB7	KM7	35	57	44	6	32,5	1,25	10,4	✓	0,53 €
MB8	KM8	40	62	50	6	37,5	1,25	12,3	✓	0,67 €
MB9	KM9	45	69	56	6	42,5	1,25	15,2	✓	0,62 €
MB10	KM10	50	74	61	6	47,5	1,25	16,0	✓	1,03 €
MB11	KM11	55	81	67	8	52,5	1,25	19,6	✓	1,07 €
MB12	KM12	60	86	73	8	57,5	1,50	25,3	✓	1,25 €
MB13	KM13	65	92	79	8	62,5	1,50	29,0	✓	1,42 €
MB14	KM14	70	98	85	8	66,5	1,50	30,4	-	1,51 €
MB15	KM15	75	104	90	8	71,5	1,50	35,6	-	1,96 €
MB16	KM16	80	112	95	10	76,5	1,75	46,4	✓	2,46 €
MB17	KM17	85	119	102	10	81,5	1,75	52,4	-	2,90 €
MB18	KM18	90	126	108	10	86,5	1,75	62,3	-	3,30 €
MB19	KM19	95	133	113	10	91,5	1,75	67,0	-	3,97 €
MB20	KM20	100	142	120	12	96,5	1,75	76,5	-	5,18 €
MB22	KM22	110	154	133	12	105,5	1,75	94,0	-	6,42 €
MB24	KM24	120	164	138	14	115,0	2,00	105,0	-	8,30 €
MB26	KM26	130	175	149	14	125,0	2,00	113,0	-	9,73 €
MB28	KM28	140	192	160	15	135,0	2,00	142,0	-	12,41 €
MB30	KM30	150	205	171	15	145,0	2,00	155,0	-	15,99 €

\*Depending on availability - Dimensions in mm

## Our other products



PGNT

Thermoplastic T handle, With threaded insert



ZG0

Plastic spur gear, Machined plastic (delrin)



T5M T10M

T type timing belt per metre, T5 Steel cored polyurethane



H4

Crossed helical gear crossed axis at 90°, Steel 20NCD2

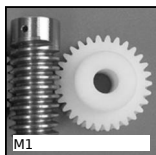

M1

Worm and wheel set, Machined plastic (delrin)



PARF110

Pressed steel base rigid foot, Swivelling Ø110



WSRM

Cylindrical polymer nut, Polymer (Iglidur®) - 1 thread



GSA\_A

Adjustable gas spring, Steel



SLB

Indexing plunger, steel class 5.8



HLA19

Right angle spiro bevel gearbox, Up to 43Nm



GE32

Sprung toggle latch with connecting link, Standard



FDS

Flexible drive shaft, Masterflex® Steel, with PVC casing

## Complementary products

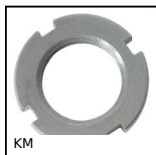

KM

Bearing locknut, Locknut KM



LR

Precision locknut, Precision locknut