

Worm and wheel set



Module 2.0 Worm in steel or machined plastic



- Pitch 6.283mm
- Machined parts
- Pressure angle 20°
- Right handed lead angle
- Materials:
Worm: Steel 20NCD2 or Delrin plastic
Wheel: bronze CuAl10NiFe4 or Delrin plastic
- Delrin: Working temp. -50°C to +80°C



Options

- Left handed lead angle
- Wheel can have from 12 to 285 teeth

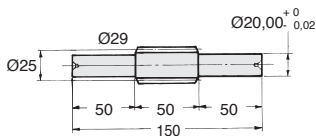

Steel worm with shaft (SW)

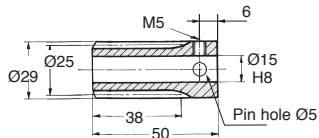

Steel (W) or plastic (ZW) worm with bore

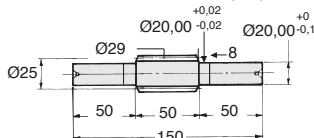

Plastic worm with shaft (ZSW)

DISCOUNT Steel

Qty	1+	6+	20+	50+
Disc.	List	-12%	-25%	On request

DISCOUNT Delrin

Qty	1+	6+	30+
Disc.	List	-22%	On request

Part number		No. of starts	Lead angle	Price each 1 to 5	
Worm with bore	Worm with shaft			Worm with bore	Worm with shaft
Non hardened steel					
W2-1	SW2-1	1	4°34'	75,50 €	114,48 €
W2-2	SW2-2	2	9°05'	80,93 €	121,47 €
W2-3	SW2-3	3	13°29'	86,86 €	124,04 €
W2-4	SW2-4	4	17°45'	95,76 €	130,32 €
Hardened steel					
WH2-1	SWH2-1	1	4°34'	107,27 €	162,73 €
WH2-2	SWH2-2	2	9°05'	115,01 €	172,57 €
WH2-3	SWH2-3	3	13°29'	123,37 €	176,36 €
WH2-4	SWH2-4	4	17°45'	136,00 €	185,07 €
Delrin					
ZW2-1	ZSW2-1	1	4°34'	53,05 €	80,59 €
ZW2-2	ZSW2-2	2	9°05'	56,92 €	85,54 €
ZW2-3	ZSW2-3	3	13°29'	61,09 €	87,38 €
ZW2-4	ZSW2-4	4	17°45'	67,34 €	91,64 €

Dimensions in mm

Wheel in bronze or machined plastic Module 2.0

Info.

- Pitch 6.283mm
- To order, add the number of starts on the worm to the wheel's part number.
E.g: worm W2-1, wheel M2-20/1
- The use of a delrin worm with a delrin wheel is only recommended for occasional use. The use of a delrin worm with a steel wheel is preferred.

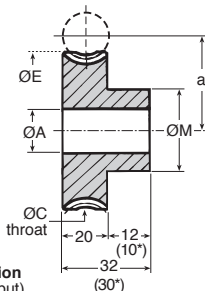

Torque and power indication
for 50 teeth at 1000 rpm (input)

WHEEL material	Bronze Nm (kW)	Delrin Nm (kW)
Steel	45 (0.094)	28.3 (0.059)
Hardened steel	79 (0.166)	-
Delrin	-	11.0 (0.023)

DISCOUNT Bronze

Qty	1+	6+	20+	50+
Disc.	List	-12%	-25%	On request

DISCOUNT Delrin

Qty	1+	6+	30+
Disc.	List	-22%	On request

Part number		Z	Centres		ØC	OE	ØM	ØA	Price each 1 to 5	
Bronze	Plastic	Teeth	ØP	a					Bronze	Plastic
M2-12	ZM2-12	12	24	24,50	28	30	20	12	93,11 €	46,80 €
M2-15	ZM2-15	15	30	27,50	34	36	25	15	113,57 €	62,90 €
M2-18	ZM2-18	18	36	30,50	40	42	30	15	124,57 €	68,12 €
M2-20	ZM2-20	20	40	32,50	44	46	30	15	129,24 €	81,31 €
M2-22	ZM2-22	22	44	34,50	48	50	30	15	144,65 €	86,22 €
M2-24	ZM2-24	24	48	36,50	52	54	30	15	152,39 €	91,08 €
M2-25	ZM2-25	25	50	37,50	54	56	40	20	156,35 €	95,96 €
M2-28	ZM2-28	28	56	40,50	60	62	40	20	164,11 €	104,74 €
M2-30	ZM2-30	30	60	42,50	64	66	50	20	167,99 €	105,74 €
M2-32	ZM2-32	32	64	44,50	68	70	50	20	174,49 €	108,85 €
M2-34	ZM2-34	34	68	46,50	72	74	50	20	194,37 €	122,49 €
M2-40	ZM2-40	40	80	52,50	84	86	50	20	260,62 €	164,24 €
M2-42	ZM2-42	42	84	54,50	88	90	50	20	284,86 €	179,42 €
M2-45	ZM2-45	45	90	57,50	94	96	50	20	323,23 €	203,72 €
M2-48	ZM2-48	48	96	60,50	100	102	50	20	526,59 €	181,85 €
M2-50	ZM2-50	50	100	62,50	104	106	50	20	526,59 €	181,85 €
M2-60	ZM2-60	60	120	72,50	124	126	50	20	648,62 €	223,87 €
M2-65	ZM2-65	65	130	77,50	134	136	50	20	On request	265,83 €
M2-78	ZM2-78	78	156	90,50	160	162	50	20	On request	On request
M2-80	ZM2-80	80	160	92,50	164	166	50	20	On request	On request

Wheels available up to this size

M2-285	ZM2-285	285	Dimensions: contact us		On request	On request
--------	---------	-----	------------------------	--	------------	------------

Dimensions in mm

Our other products



BLHM70

Right angled gearbox,
up to 128 Nm



LC

Friction clutch, 30 to
240 Nm



SH1

Parallel axis helical
gear, Machined plastic
(delrin)



DOMI120

Connecting kits, XY
linking kit



UCFL_PBT

Stainless
steel/Polymer flanged
bearing, Polymer and
stainless steel



PSG15

Spur gear - precision
range, Stainless steel
303

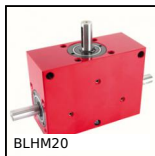

BLHM20

Right angled gearbox,
double output shafts,
up to 1.77 Nm



CNA-CNG

Right angled
mounting plate, Right
angled mounting
plate for ball jo...



SLBE

Indexing plunger -
Spacer, Spacer for
SLB and SLBS index
bolts



BABreceptacle

Ball pin socket, Socket



GBS

Nut for ballscrew,
Flanged ballscrew nut



UCF_PBT

Stainless
steel/Polymer flanged
bearing, Polymer and
stainless steel

Complementary products



M2

Worm and wheel set,
Hardened steel



M2

Worm and wheel set,
Machined plastic
(delrin)