

Worm and wheel set



Module 1.25 Worm in steel or machined plastic



- Pitch 3.927mm
- **Machined parts**
- Pressure angle 20°
- Right handed lead angle
- Materials:
Worm: Steel 20NCD2 or Delrin plastic
Wheel: bronze CuAl10NiFe4 or Delrin plastic
- Delrin: Working temp. -50°C to +80°C



Options

- Left handed lead angle
- **Wheel can have from 12 to 110 teeth**

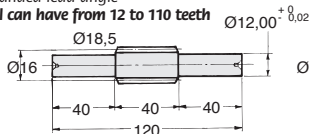

Steel worm with shaft (SW)

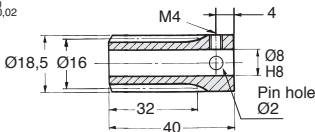

Steel (W) or plastic (ZW) worm with bore

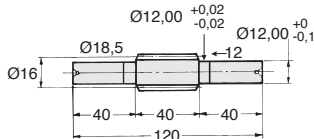

Plastic worm with shaft (ZSW)

DISCOUNT Steel

Qty	1+	6+	20+	50+
Disc.	List -12%	-25%	On request	

DISCOUNT Delrin

Qty	1+	6+	30+
Disc.	List -22%	On request	

Part number		No. of starts	Lead angle	Price each 1 to 5	
Worm with bore	Worm with shaft			Worm with bore	Worm with shaft
Non hardened steel					
W1.25-1	SW1.25-1	1	4°28'	37,40 €	69,07 €
W1.25-2	SW1.25-2	2	8°53'	39,58 €	70,95 €
W1.25-3	SW1.25-3	3	13°11'	43,42 €	75,74 €
W1.25-4	SW1.25-4	4	17°21'	45,34 €	76,85 €
Hardened steel					
WH1.25-1	SWH1.25-1	1	4°28'	53,29 €	98,15 €
WH1.25-2	SWH1.25-2	2	8°53'	56,24 €	100,85 €
WH1.25-3	SWH1.25-3	3	13°11'	61,67 €	107,55 €
WH1.25-4	SWH1.25-4	4	17°21'	64,45 €	109,17 €
Delrin					
ZW1.25-1	ZSW1.25-1	1	4°28'	26,42 €	48,63 €
ZW1.25-2	ZSW1.25-2	2	8°53'	27,80 €	49,89 €
ZW1.25-3	ZSW1.25-3	3	13°11'	30,53 €	53,31 €
ZW1.25-4	ZSW1.25-4	4	17°21'	31,88 €	49,18 €

Dimensions in mm

Wheel in bronze or machined plastic Module 1.25

Info.

- Pitch 3.927mm
- To order, add the number of starts on the worm to the wheel's part number.
E.g: worm **W1.25-1**, wheel **M1.25-20/1**
- The use of a delrin worm with a delrin wheel is only recommended for occasional use. The use of a delrin worm with a steel wheel is preferred.

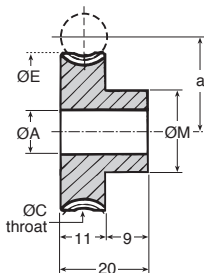

Torque and power indication for 50 teeth at 1000 rpm (input)

WHEEL material	Bronze Nm (kW)	Delrin Nm (kW)
Steel	11.41 (0.024)	7.02 (0.015)
Hardened steel	20.25 (0.042)	-
Delrin	-	2.75 (0.006)

DISCOUNT Bronze

Qty	1+	6+	20+	50+
Disc.	List	-12%	-25%	On request

DISCOUNT Delrin

Qty	1+	6+	30+
Disc.	List	-22%	On request

Part number	Z	Centres a	ØP	ØC	ØE	ØM	ØA	Price each 1 to 5		
								Bronze	Plastic	
M1.25-12	ZM1.25-12	12	15,00	15,50	17,50	18,75	14,00	8	40,90 €	20,56 €
M1.25-15	ZM1.25-15	15	18,75	17,38	21,25	22,50	14,00	8	43,00 €	21,57 €
M1.25-20	ZM1.25-20	20	25,00	20,50	27,50	28,75	20,00	10	41,74 €	24,15 €
M1.25-38	ZM1.25-38	38	47,50	31,75	50,00	51,25	25,00	10	76,24 €	47,96 €
M1.25-45	ZM1.25-45	45	56,25	36,13	58,75	60,00	25,00	10	97,64 €	61,56 €
M1.25-60	ZM1.25-60	60	75,00	45,50	77,50	78,75	32,00	12	162,26 €	102,16 €

Wheels available up to this size

M1.25-110	ZM1.25-110	110	Dimensions : contact us					On request	On request
-----------	------------	-----	-------------------------	--	--	--	--	------------	------------

Dimensions in mm

Our other products

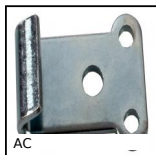

Strike for toggle latch,
15mm



Actuator guide kit,
Coupling for threaded
cylinder end



Spur gear coaxial
gearbox, from 0.57 to
2.25 Nm - In-line



Straight long link
chain, Galvanised
steel



Screwjack with
travelling nut, with
moving nut



Hexagonal nut
DIN934, Brass



Indexing plunger with
flange, With
horizontal mounting
flange



Standard stainless
steel profile, 45 x 45
mm



Flat suction cup,
nitrile



Hexagonal steel nut,
Steel - 1 thread



Idle sprocket for slat
top chain, Range 882



Countersunk screw,
Stainless steel A2 -
DIN 7991

Complementary products

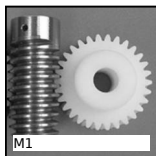

Worm and wheel set,
Machined plastic
(delrin)



Worm and wheel set,
Bronze